

# smartwall kit 03

SW-03

Stand apart from the competition with a state-of-the-art, modern Smartwall Kit. The Smartwall Kit series is a collection of extrusion-based, dye-sublimated fabric mural graphic displays. SmartWall kits are easy to assemble and dismantle.



## features and benefits:

- 50mm silver extrusion frame
- Single-sided SEG dye-sublimated fabric graphics
- Easy step-by-step instructions
- Kit includes frame, five fabric graphics, three 120 watt floodlights, and one wheeled molded case
- Lifetime hardware warranty against manufacturer defects

## dimensions:

Hardware	Graphic
Assembled unit: 112.658"w x 94.5"h x 28"d 2861.5mm(w) x 2400mm(h) x 711mm(d)	Total visual area: Panel A: 37.27"w x 94.375"h 947mm(w) x 2397mm(h)  Panel B: 25.66"w x 94.5"h 652mm(w) x 2400mm(h)  Panel C: 74.803"w x 94.5"h 1900mm(w) x 2400mm(h)  Panel D: 27.362"w x 94.5"h 695mm(w) x 2400mm(h)  Please be sure to include a 2" bleed around the perimeter.  Refer to related graphic templates for more information
Shipping	
Shipping dimensions - ships in 1 case: WMC-12X6 case: 52"l x 30"w x 15"h 1320mm(l) x 760mm(w) x 380mm(h)  Approximate shipping weight (entire kit): 110.58 lbs / 50.15 kgs	

## additional information:

Graphic material: Dye-sublimated fabric	Lights included: L10B 120 watt floodlight, curved arm, black finish, 19.5" from end to end
--	--

**nimlok**

**smartwall**

Parts Included:

Code	Qty	Description
SW-K-03-A-G	x1	900MM (37.4")W X 2400MM (94.5")H FABRIC GRAPHIC W/FCE-2 ALL SIDES
SW-K-03-B-G	x1	600MM (25.8")W X 2400MM (94.5")H FABRIC GRAPHIC W/FCE-2 ALL SIDES
SW-K-03-C-G	x1	1900MM (74.8")W X 2400MM (94.5")H FABRIC GRAPHIC W/FCE-2 ALL SIDES
SW-K-03-D-G	x1	695MM (27.3")W X 2400MM (94.5")H FABRIC GRAPHIC W/FCE-2 ALL SIDES
IB2	x8	PH INLINE CONNECTOR
CB9-S	x4	50MM SQUARE PHCF2 CORNER BRACKET
LN10	x3	BLACK LN10 HALOGEN LIGHT FIXTURE ETL APPROVED
LN-3P-LT-FXT	x3	LINEAR LIGHT FIXTURE HOLDER
F2	x2	1155MM LENGTH OF PH EXTRUSION - WITH IB2 LOCK HOLES ONE SIDE - CAM LOCK ONE SIDE
F22	x6	1193MM LENGTH OF PMFC2-90 EXTRUSION - WITH IB2 LOCK HOLES BOTH SIDES
F34	x4	1155MM LENGTH OF PHFC2 EXTRUSION - WITH IB2 LOCK HOLES ONE SIDE - CAM LOCKS ONE SIDE
F40	x4	600MM LENGTH OF PHFC2 EXTRUSION - WITH CAM LOCKS BOTH ENDS
F38	x2	900MM LENGTH OF PHFC2 EXTRUSION - WITH CAM LOCKS BOTH ENDS
F37	x4	900MM LENGTH OF PHFC2-90 EXTRUSION - WITH IB2 LOCK HOLES ONE SIDE - CAM LOCKS ONE SIDE
PMFC2-90-CAP	x6	PMFC2-90 CAP

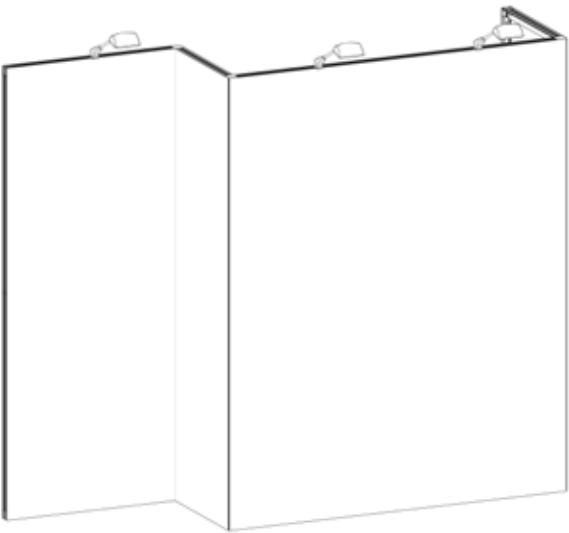
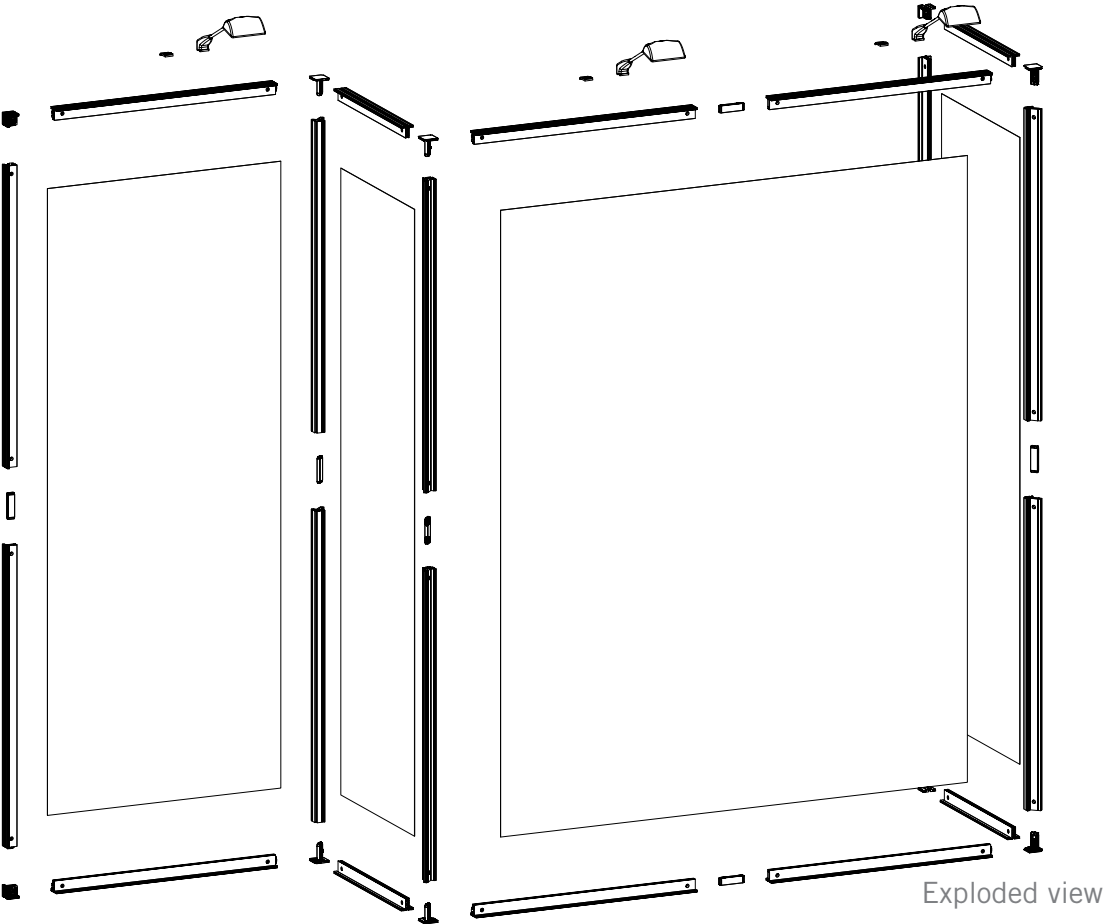

## Step 1: Assemble Frame

Arrange pieces on the floor as shown in the diagram below. Assemble frame by securing CB9-S to the F38, F34, F37, F40 and F22s. When locking be sure to turn each cam a little bit and then go back and tighten to the proper tension. Take care to turn locks only half a turn. Slide the IB2 into the extrusion to connect sides. Tighten to the proper tension to lock extrusions together.

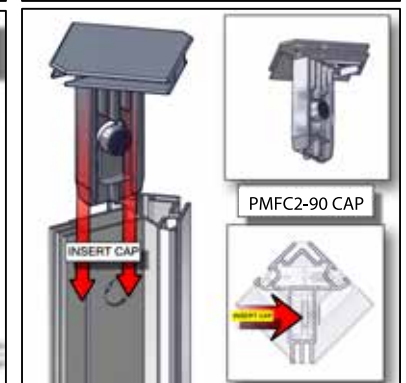
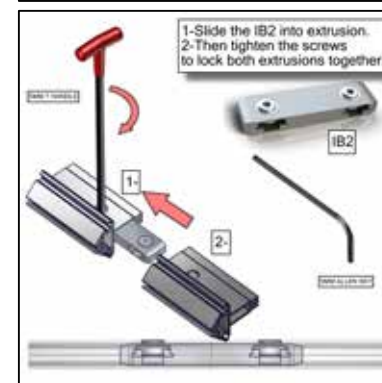
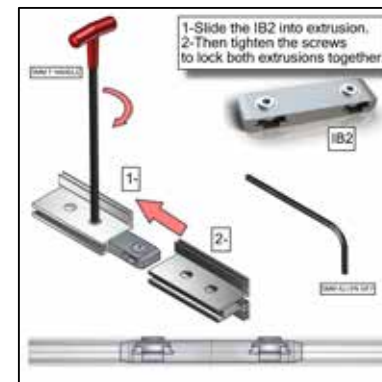
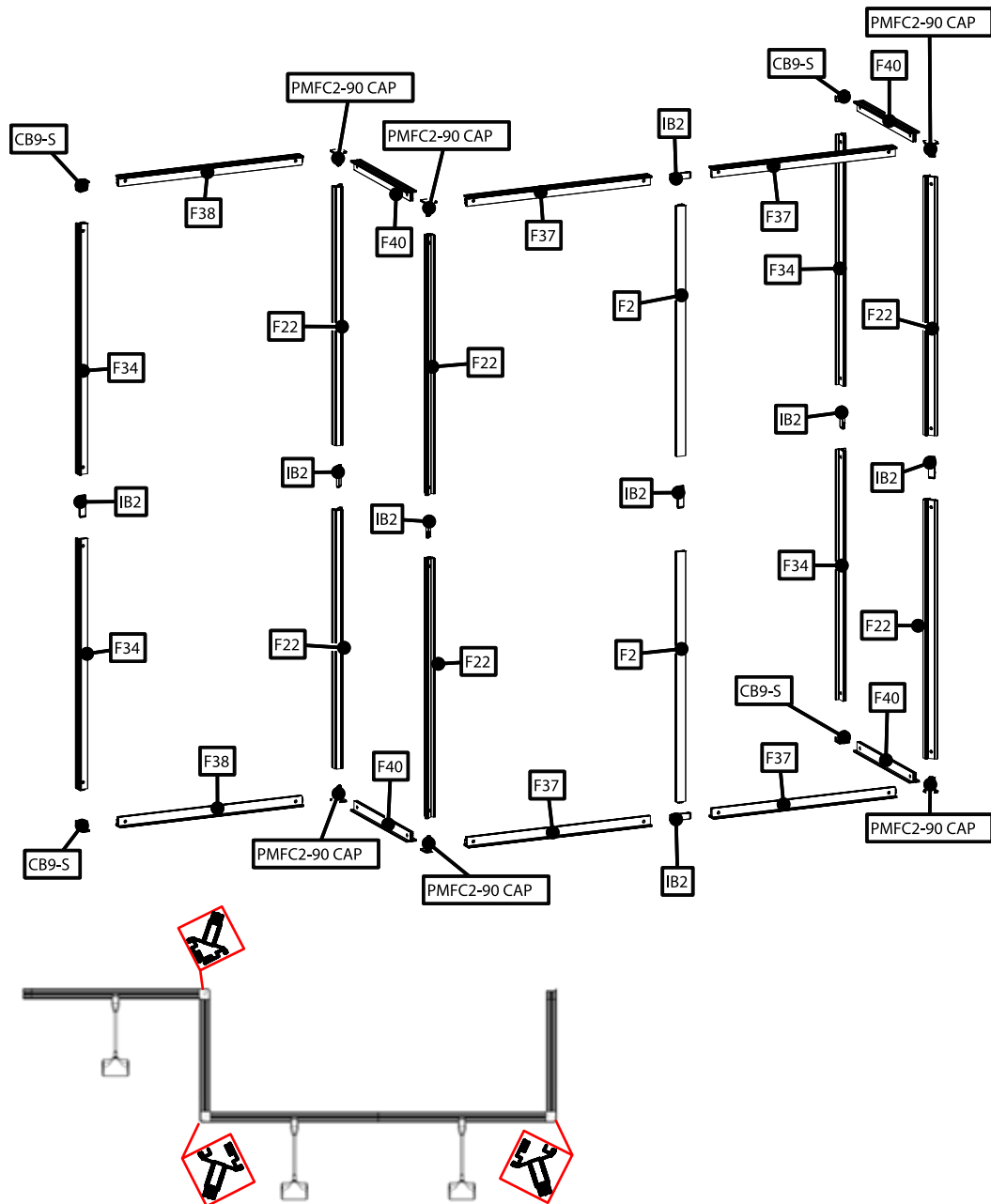

## Step 2: Apply Graphics

Install graphic(s) by pressing the FCE-2 edge of graphic into the channel of the extrusion. Start in upper left corner, go across the top and then down the sides to the bottom. Assure each graphic is tightly inserted. When taking graphics off, take care to gently pull by attached pull tab.

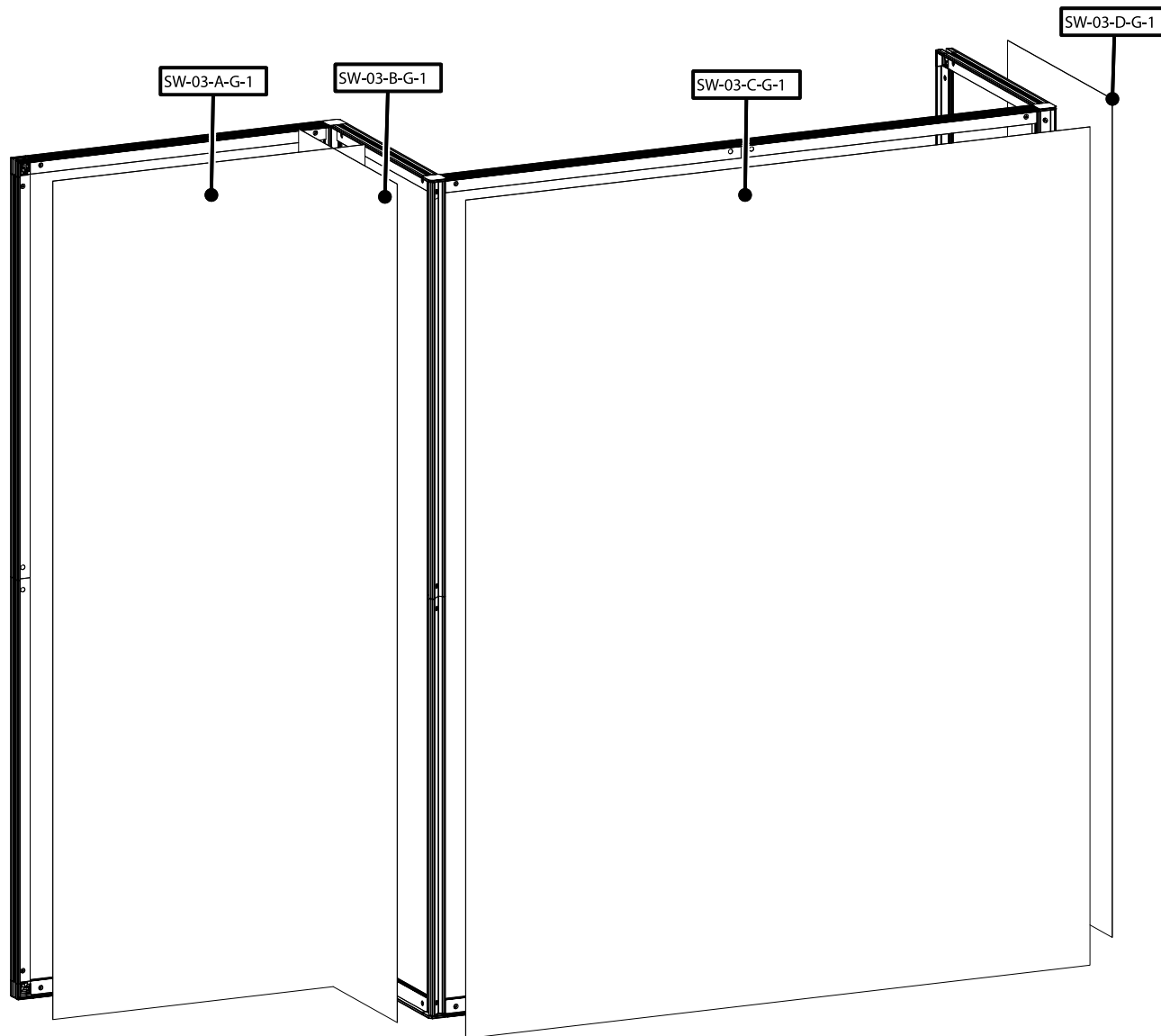

FCE-2 TO PHFC4

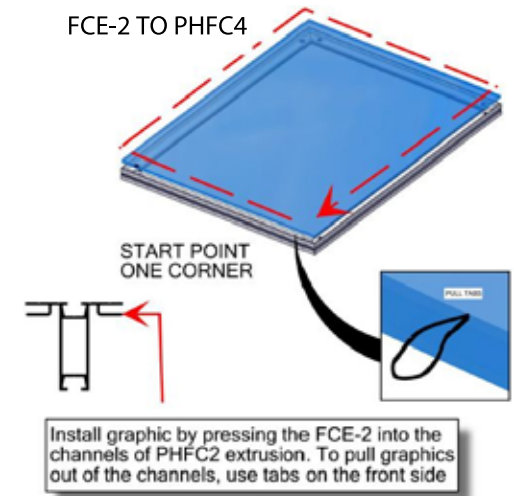

FCE-2 TO PHFC4

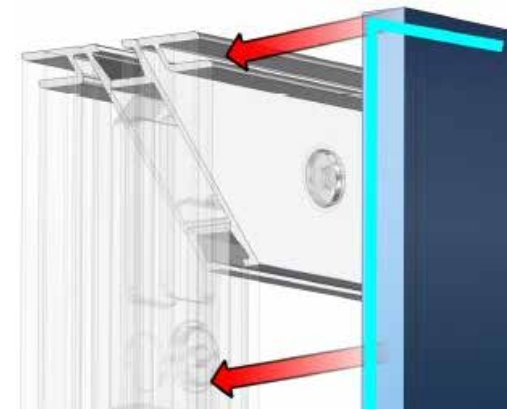

### Step 3: Attach Lights

Slide light clip onto each light. Then slide light into the extrusion channel at an angle and gently lower down and repeat for each light.

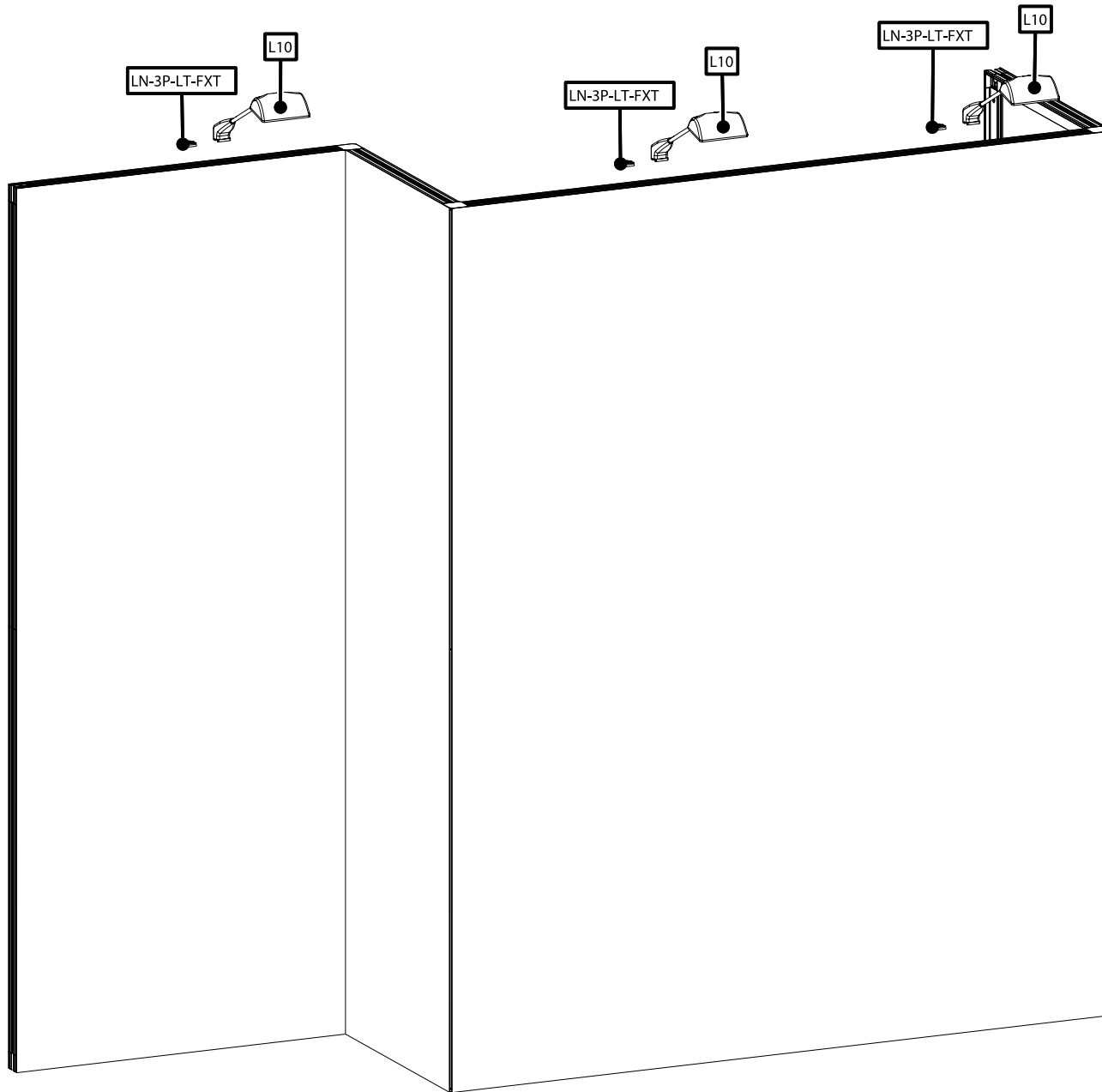

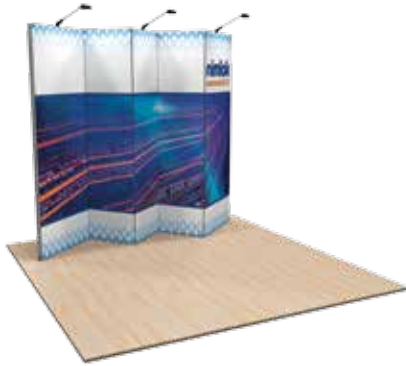

smartwall kit 01



smartwall kit 02



smartwall kit 03



smartwall kit 04



smartwall kit 05



smartwall kit 06



smartwall kit 07



smartwall kit 08

Redesign of this exhibit without approval by Nimlok may result in dangerous and unsafe structures. Nimlok disclaims any responsibility for redesigned exhibits it does not approve in writing. Parts and components such as panels and extrusions are manufactured to metric sizing.

We continue to improve and modify our product range and reserve the right to vary the specifications without prior notice. All dimensions and weights quoted are approximate and we accept no responsibility for variance. E&OE. See Graphic Templates for graphic bleed specifications.