

smartwall kit 08

SW-08

Stand apart from the competition with a state-of-the-art, modern SmartWall Kit. The SmartWall Kit series is a collection of extrusion-based, dye-sublimated fabric mural graphic displays. SmartWall kits are easy to assemble and dismantle.



features and benefits:

- 50mm silver extrusion frame
- Single-sided SEG dye-sublimated push-fit fabric graphics
- Easy step-by-step instructions
- Kit includes frame, five fabric graphics, four 120 watt floodlights, two wheeled molded cases, and one enclosed fabric graphic counter
- Lifetime hardware warranty against manufacturer defects

dimensions:

Hardware	Graphic
Assembled Unit: 190.24"w x 94.5"h x 54"d 4832mm(w) x 2400mm(h) x 1372mm(d)	Total visual area: Panel A: 47.441"w x 94.5"h 1205mm(w) x 2400mm(h)
Counter: 39.375"w x 36.625"h x 22.25"d 1000mm(w) x 930mm(h) x 570mm(d)	Panels B & D: 25.787"w x 94.5"h 655mm(w) x 2400mm(h)
	Panel C: 93.110"w x 94.5"h 2365mm(w) x 2400mm(h)
	Panel E: 49.213"w x 94.5"h 1250mm(w) x 2400mm(h)
Shipping Shipping dimensions - ships in 2 cases: 1 OCH2 case: 52"l x 30"w x 15"h 1320mm(l) x 760mm(w) x 380mm(h)	Counter panels A & C: 39.24"w x 35.31"h 997mm(w) x 897mm(h)
1 OCE case: 40"l up to 60"l x 18"w x 18"h 1016mm up to 1524mm(l) x 457mm(w) x 457mm(h)	Counter panels B & D: 21.52"w x 35.31"h 547mm(w) x 897mm(h)
Approximate shipping weight (kit with cases): 189.54 lbs / 86 kgs	Please be sure to include a 2" bleed around the perimeter.

additional information:

Graphic material: Dye-sublimated fabric	Counter holds max weight 100 lbs / 45.4 kg
Tabletop color options: <div> <div>silver</div> <div>black</div> <div>mahogany</div> <div>natural</div> </div>	Lights included: L10B 120 watt floodlight, curved arm, black finish, 19.5" from end to end

nimlok

smartwall

Parts Included:

Code	Qty	Description
VF-K-08-A-G	x1	1205MM (47.441")W X 2400MM (94.5")H FABRIC GRAPHIC W/FEC-2 ALL SIDES
VF-K-08-B-G	x1	655MM (25.787")W X 2400MM (94.5")H FABRIC GRAPHIC W/FEC-2 ALL SIDES
VF-K-08-C-G	x1	2365MM (93.110")W X 2400MM (94.5")H FABRIC GRAPHIC W/FEC-2 ALL SIDES
VF-K-08-D-G	x1	655MM (25.787")W X 2400MM (94.5")H FABRIC GRAPHIC W/FEC-2 ALL SIDES
VF-K-08-E-G	x1	1250MM (49.213")W X 2400MM (94.5")H FABRIC GRAPHIC W/FEC-2 ALL SIDES
IB2	x9	PH INLINE CONNECTOR
CB9-S	x4	50MM SQUARE PHCF2 CORNER BRACKET
LUM-200-ORL-B	x4	BLACK 200W HALOGEN LIGHT FIXTURE ETL APPROVED
LN-3P-LT-FXT	x4	LINEAR LIGHT FIXTURE HOLDER
F2	x2	1155MM LENGTH OF PH EXTRUSION - WITH IB2 LOCK HOLES ONE SIDE - CAM LOCK ONE SIDE
F22	x8	1193MM LENGTH OF PMFC2-90 EXTRUSION - WITH IB2 LOCK HOLES BOTH SIDES
F34	x8	1155MM LENGTH OF PHFC2 EXTRUSION - WITH IB2 LOCK HOLES ONE SIDE - CAM LOCKS ONE SIDE
F36	x4	1155MM LENGTH OF PHFC2 EXTRUSION - WITH CAM LOCK BOTH ENDS
F40	x4	600MM LENGTH OF PHFC2 EXTRUSION - WITH CAM LOCKS BOTH ENDS
PMFC2-90-CAP	x8	PMFC2-90 CAP

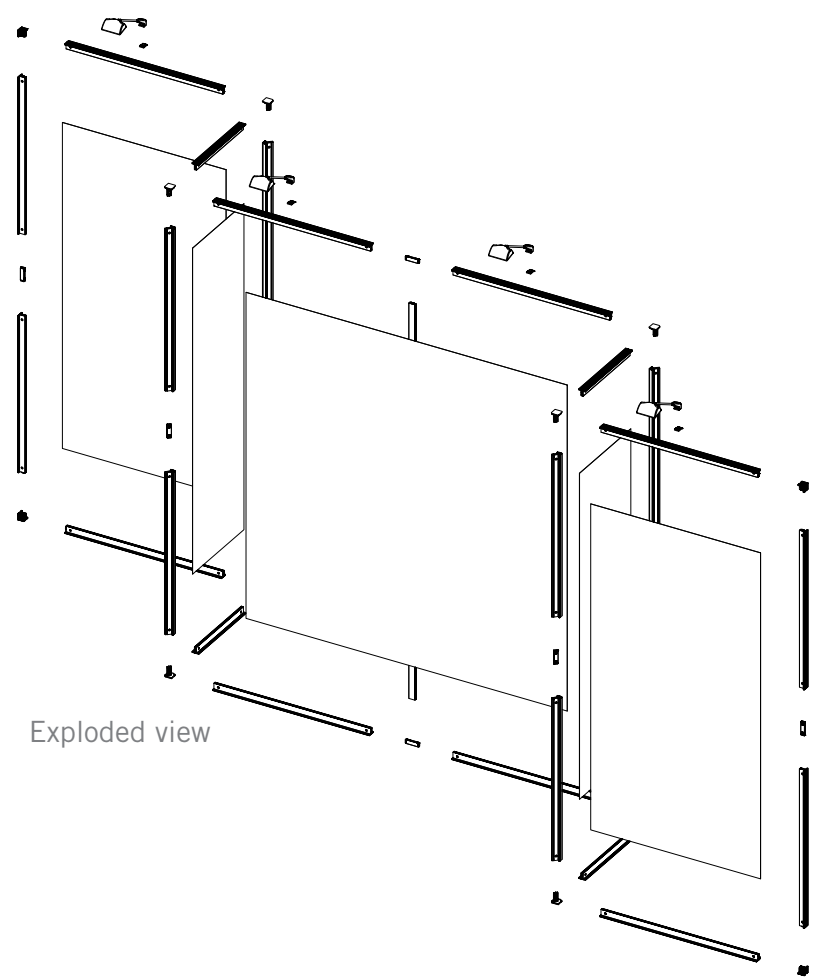

Exploded view

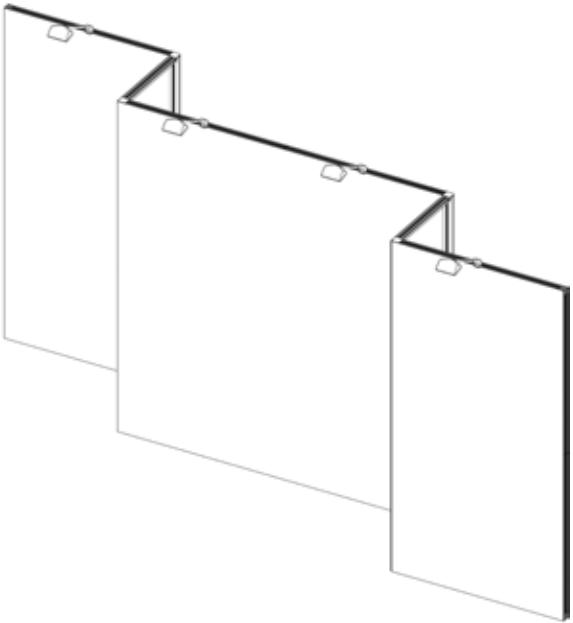

Assembled view

Step 1: Assemble Frame

Arrange pieces on the floor as shown in the diagram below. Assemble frame by securing CB9-S to the F34s and F36s and lock extrusions together. When locking be sure to turn each cam a little bit and then go back and tighten to the proper tension. Take care to turn locks only half a turn. Slide the IB2 into the extrusion to connect sides. Tighten to the proper tension to lock extrusions together.

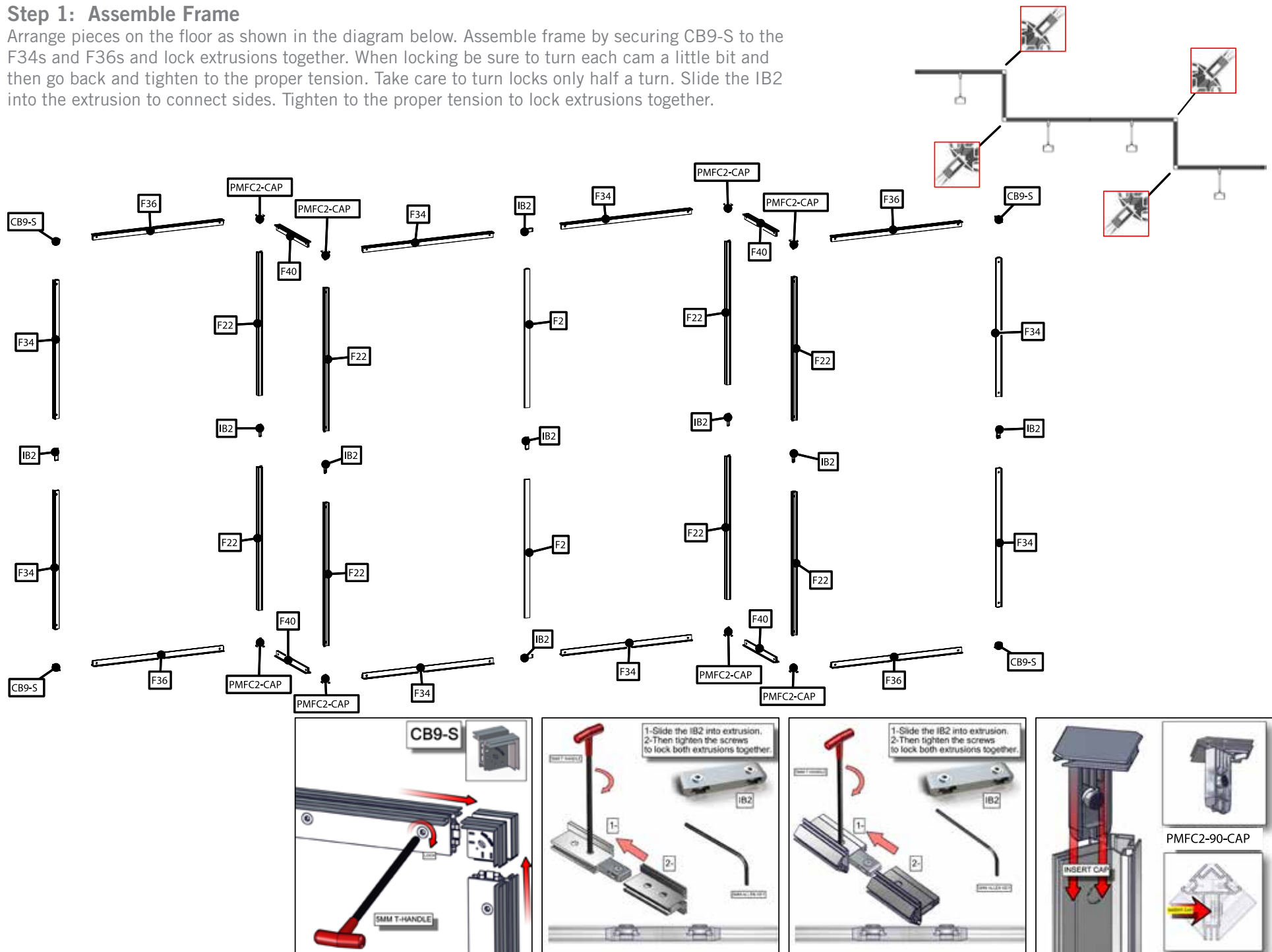

Step 2: Apply Graphics

Install graphic(s) by pressing the FCE-2 edge of graphic into the channel of the extrusion. Start in upper left corner, go across the top and then down the sides to the bottom. Assure each graphic is tightly inserted. When taking graphics off, take care to gently pull by attached pull tab.

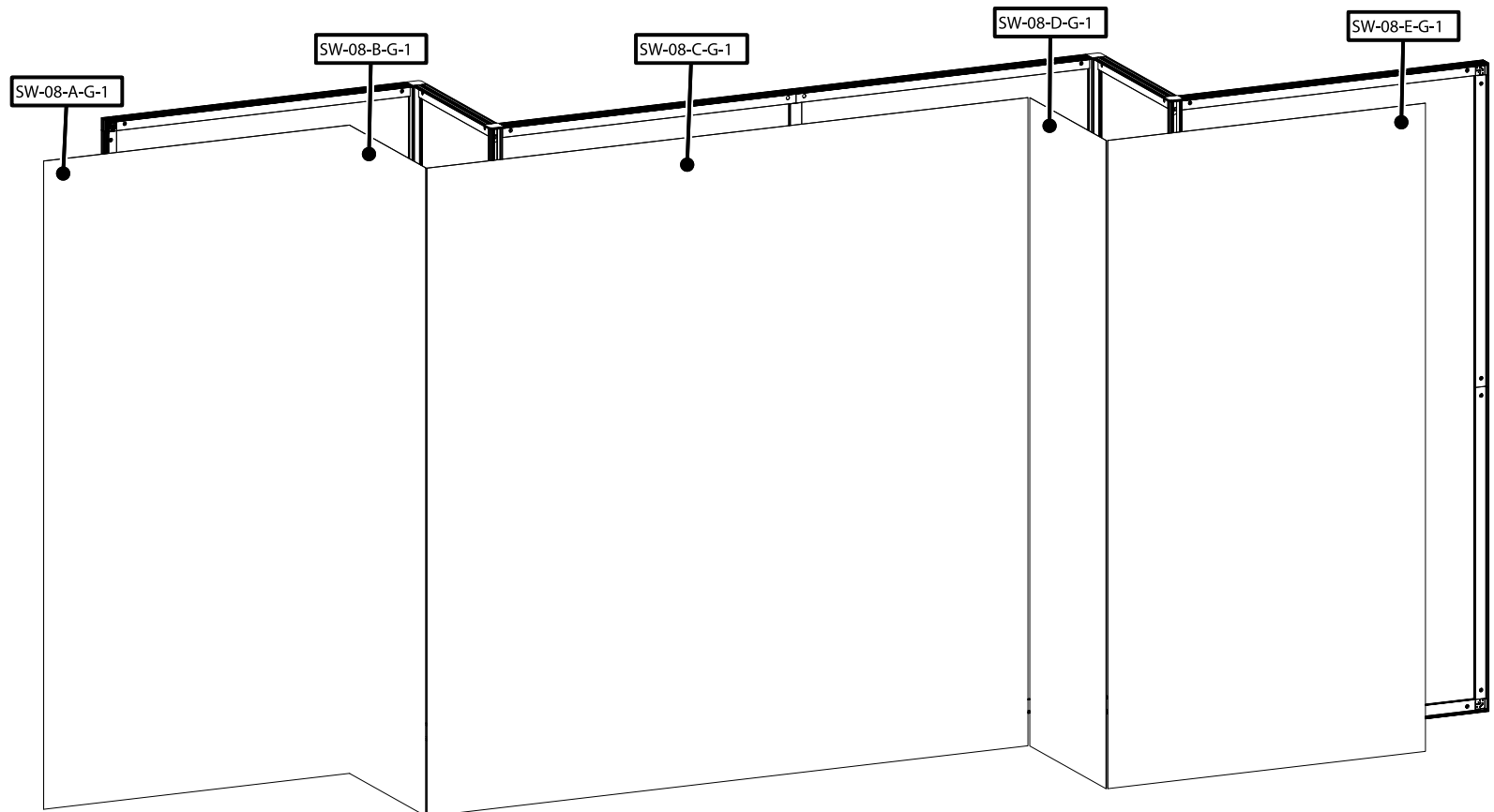
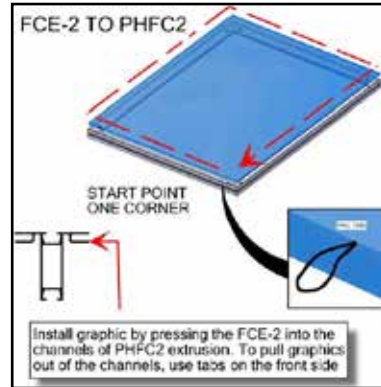
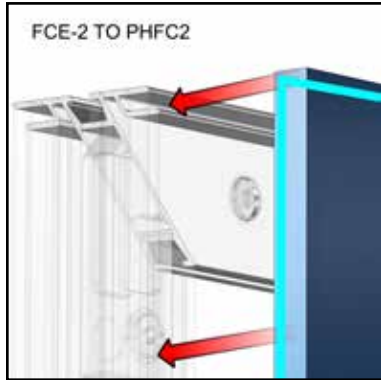

Step 3: Attach Lights

Slide light clip onto each light. Then slide light into the extrusion channel at an angle and gently lower down and repeat for each light.

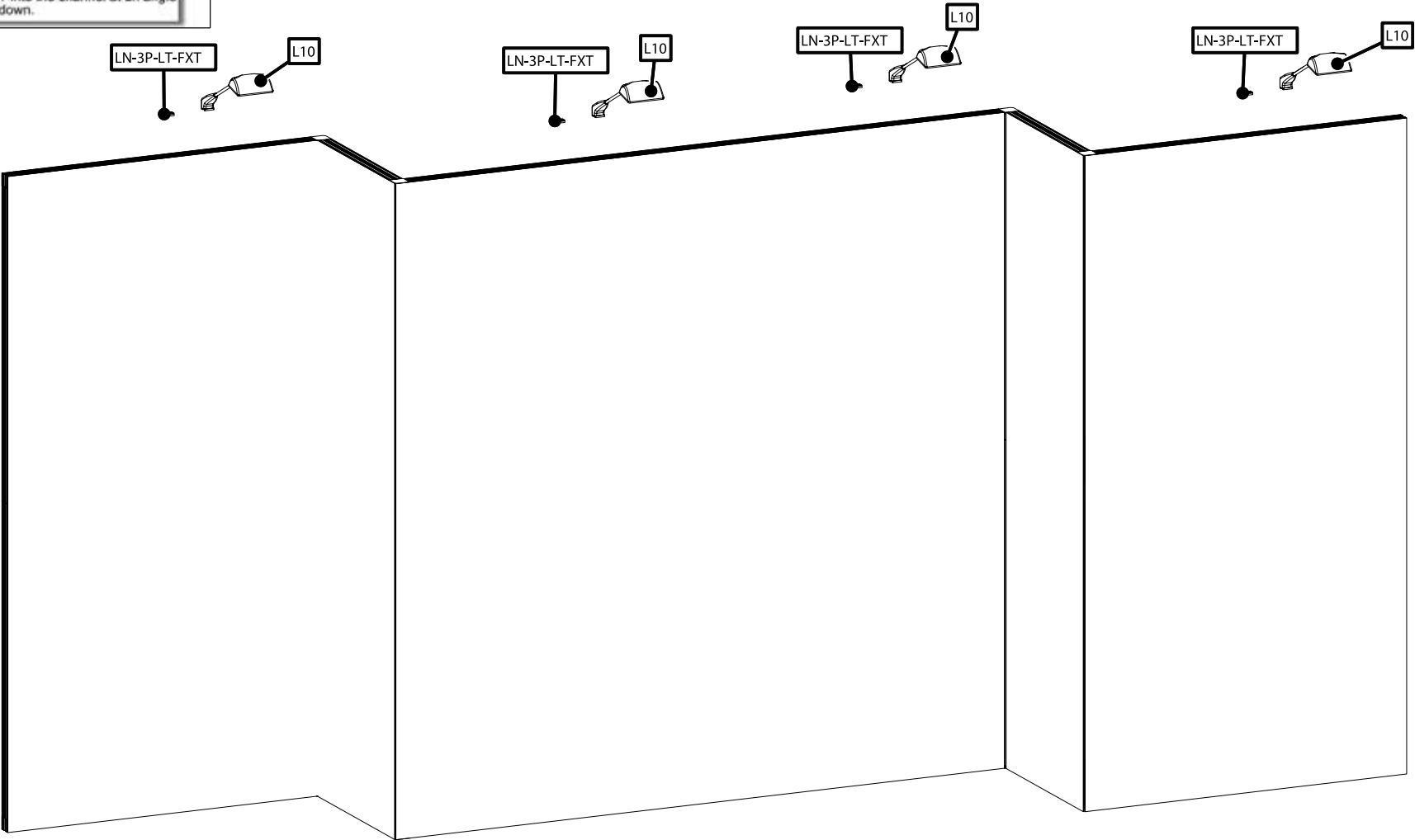

Parts Included:

Code	Qty	Description
F41	x4	450MM (17.72") PHFC2 EXTRUSION WITH LOCKS TWO ENDS
F57	x4	886MM (34.88") PMFC2-90 EXTRUSION - WITH IB2 LOCK HOLES BOTH SIDES
PMFC2-90 CAP	x8	PMFC2 90 DEGREE EXTRUSION CAP
F37	x4	900MM (35.43") PHFC2 EXTRUSION WITH LOCKS TWO ENDS
SWC-S-G-1	x2	543MM (21.37")W X 1000MM (39.38")H FABRIC GRAPHIC W/FCE-2 ALL SIDES
SWC-F-G-1	x2	993MM (39.09")W X 1000MM (39.38")H FABRIC GRAPHIC W/FCE-2 ALL SIDES
SW-CT-01	x1	COUNTERTOP FOR SMARTWALL COUNTER



Overhead view

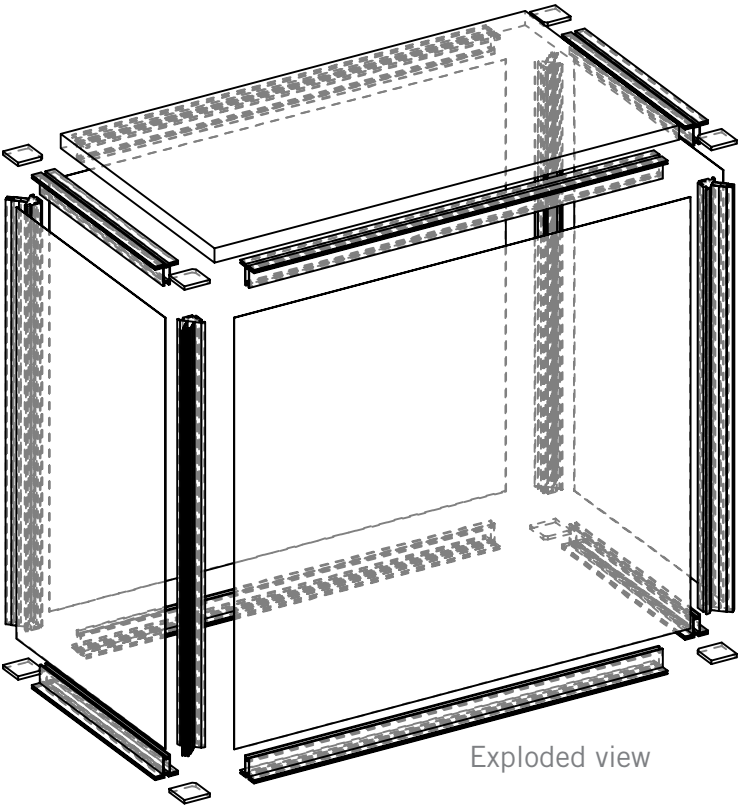

Exploded view

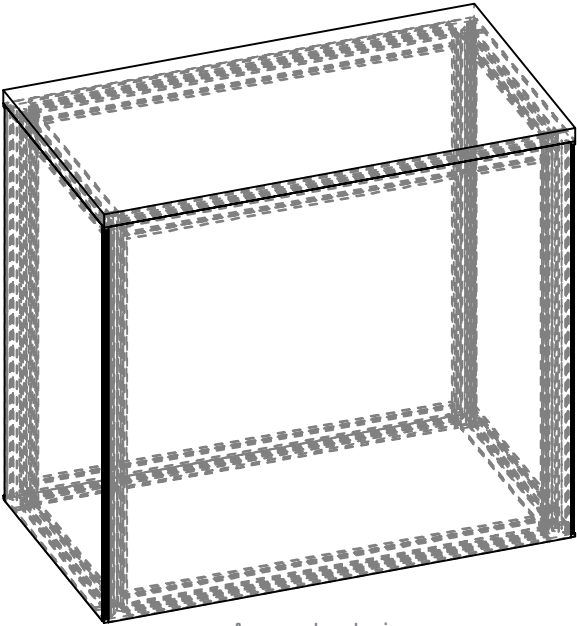

Assembled view

Arrange pieces on the floor as shown in the diagram below. Assemble frame by locking F37 and F41 to the F57s. When locking be sure to turn each cam a little bit and then go back and tighten to the proper tension. Take care to turn locks only a quarter turn, so as to not strip the locks by over tightening.

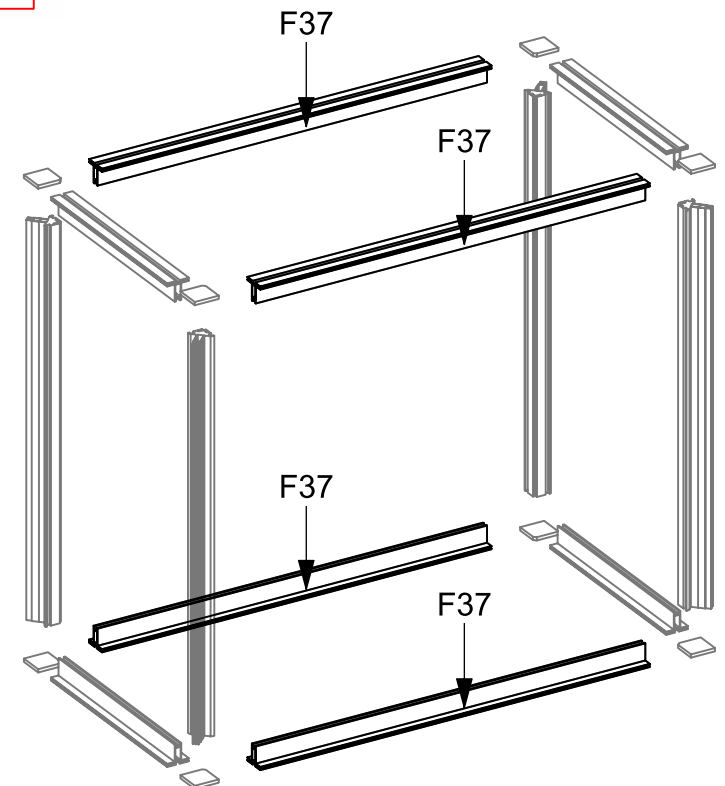

Step 2: Apply Graphics & Attach Countertop

Apply push-fit fabric graphic(s) by pressing the FCE-2 edge of graphic into the channel of the extrusion. Start in upper left corner, go across the top and then down the sides to the bottom. Repeat for each side. Assure each graphic is tightly inserted. When taking graphics off, take care to gently pull by attached pull tab. Next, gently place the countertop onto the completed frame.

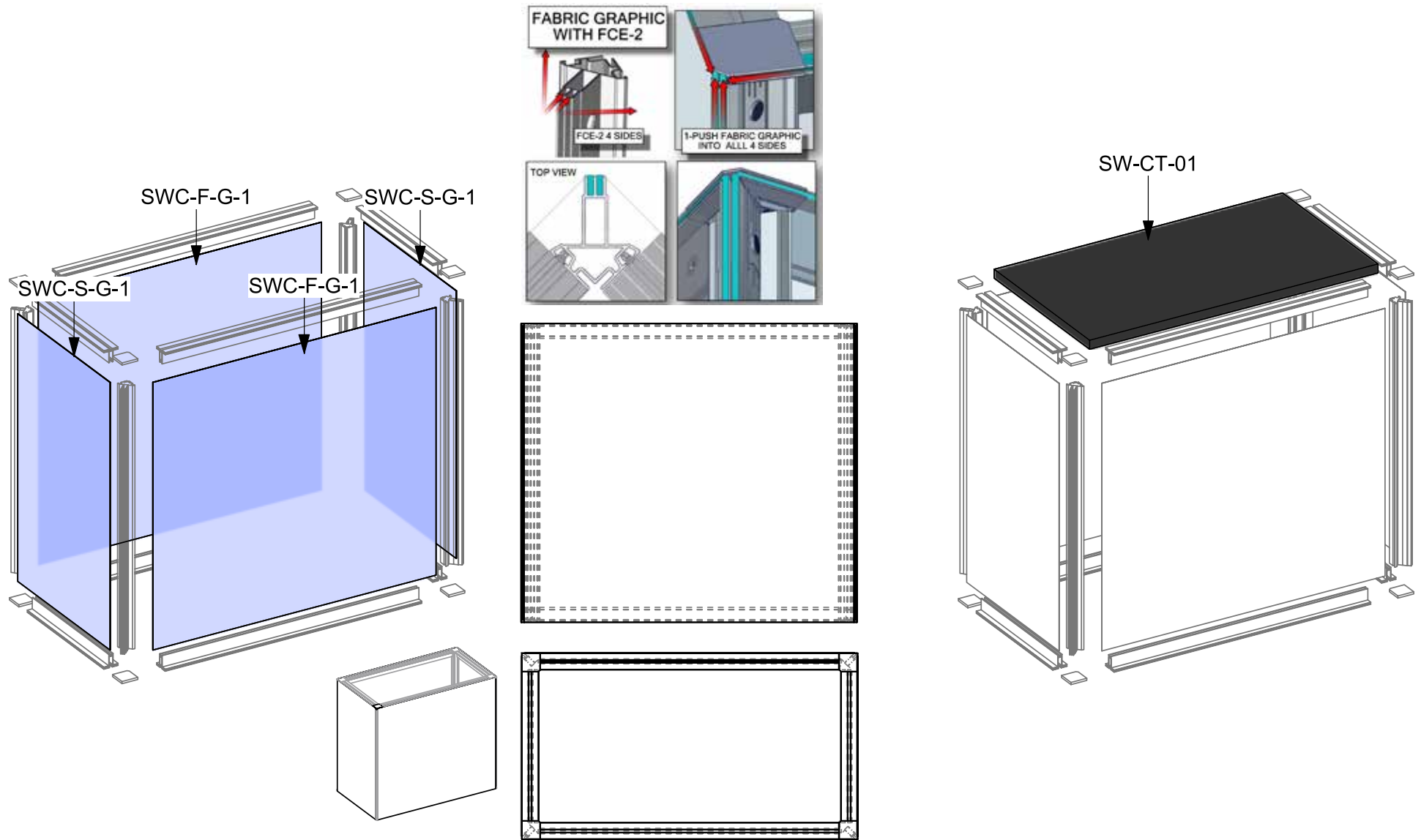



smartwall kit 01



smartwall kit 02



smartwall kit 03



smartwall kit 04



smartwall kit 05



smartwall kit 06



smartwall kit 07



smartwall kit 08

Redesign of this exhibit without approval by Nimlok may result in dangerous and unsafe structures. Nimlok disclaims any responsibility for redesigned exhibits it does not approve in writing. Parts and components such as panels and extrusions are manufactured to metric sizing.

We continue to improve and modify our product range and reserve the right to vary the specifications without prior notice. All dimensions and weights quoted are approximate and we accept no responsibility for variance. E&OE. See Graphic Templates for graphic bleed specifications.