

smartwall pro kit 07

HP-K-07
Smartwall Pro™ Modular exhibits and counters are a perfect solution for the serious exhibitor. Exhibits feature heavy-duty aluminum extrusion frames and push-fit fabric graphics. Count on making an unforgettable impact with Smartwall Pro Modular exhibit kits, counters, and accessories.



features and benefits:

- Silver aluminum extrusion frame
- Single-sided SEG dye-sublimated push-fit fabric graphics
- Pillowcase fabric graphic
- Easy step-by-step instructions
- Kit includes frame, side/top white accent, three fabric graphic panels, three pillowcase fabric graphic, one counter, one medium monitor mount, two OCH2 cases and one OCE molded case
- Lifetime hardware warranty against manufacturer defects

dimensions:

| Hardware | Graphic |
|--|--|
| Assembled unit: 115.25" w x 95.63" h x 79.25" d 2927.35mm(w) x 2429mm(h) x 2012.95mm(d) | Total visual area: Panels A & C: 23.49" w x 94.375" h Panel B: 47.125" w x 94.375" h |
| Counter: 30.63" w x 40.5" h x 18.75" d 778mm(w) x 1028.7mm(h) x 476.25mm(d) | Dye Sub Fabric Structure D (double-sided pillowcase): Top Panel: 24" w x 115.37" h Side Panels: 24" w x 110.932" h |
| Shipping | Counter: Front Wrap Panel: 73.25" w x 39.38" h Back Door Panel: 11.48" w x 39.38" h |
| Shipping dimensions - ships in 3 cases: 2 OCH2 cases: 52" l x 30" w x 14" h 1320.8mm(l) x 762mm(w) x 355.6mm(h) 1 OCE case: 40" l up to 66" l x 18" w x 18" h 1016mm up to 1676.4mm(l) x 457.2mm(w) x 457.2mm(h) | Please be sure to include a 2" bleed around the perimeter of panel B and 5" bleed for the fabric structure D. |
| Approximate shipping weight (entire kit): 317 lbs / 144 kgs | Refer to related graphic templates for more information |

additional information:

| | |
|---|---|
| Fabric material: Dye-sublimated fabric and UV printed on 6mm white Sintra infills | Counter holds max weight 50 lbs / 22.68 kgs |
| Laminate countertop color options: <div><div>dove grey</div><div>black</div><div>designer white</div><div>fusion maple</div></div> | Medium monitor bracket holds 26-40" LCD, maximum weight: 50 lbs / 22.68 kgs |
| | *LCD monitor not included |
| | White laminate side/top accent structure |

nimlok

smartwall pro

R-HP-K-07

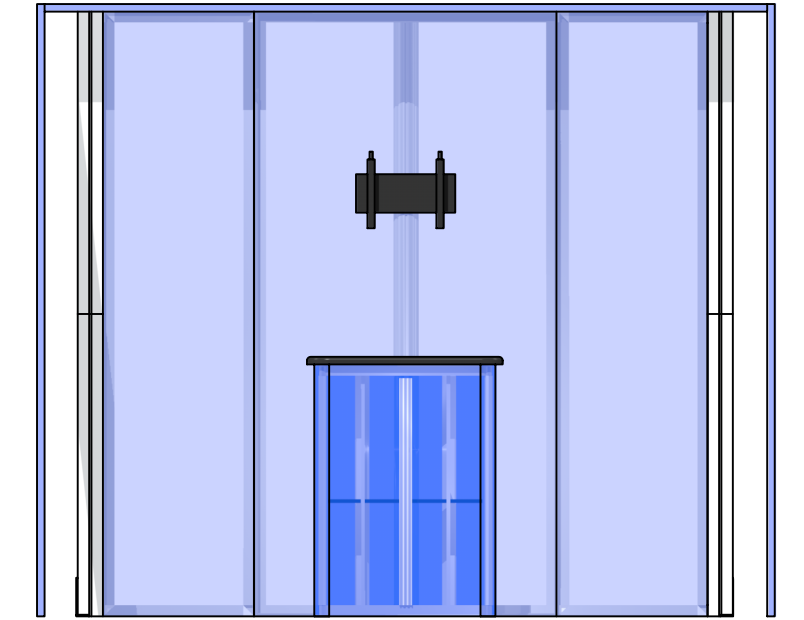
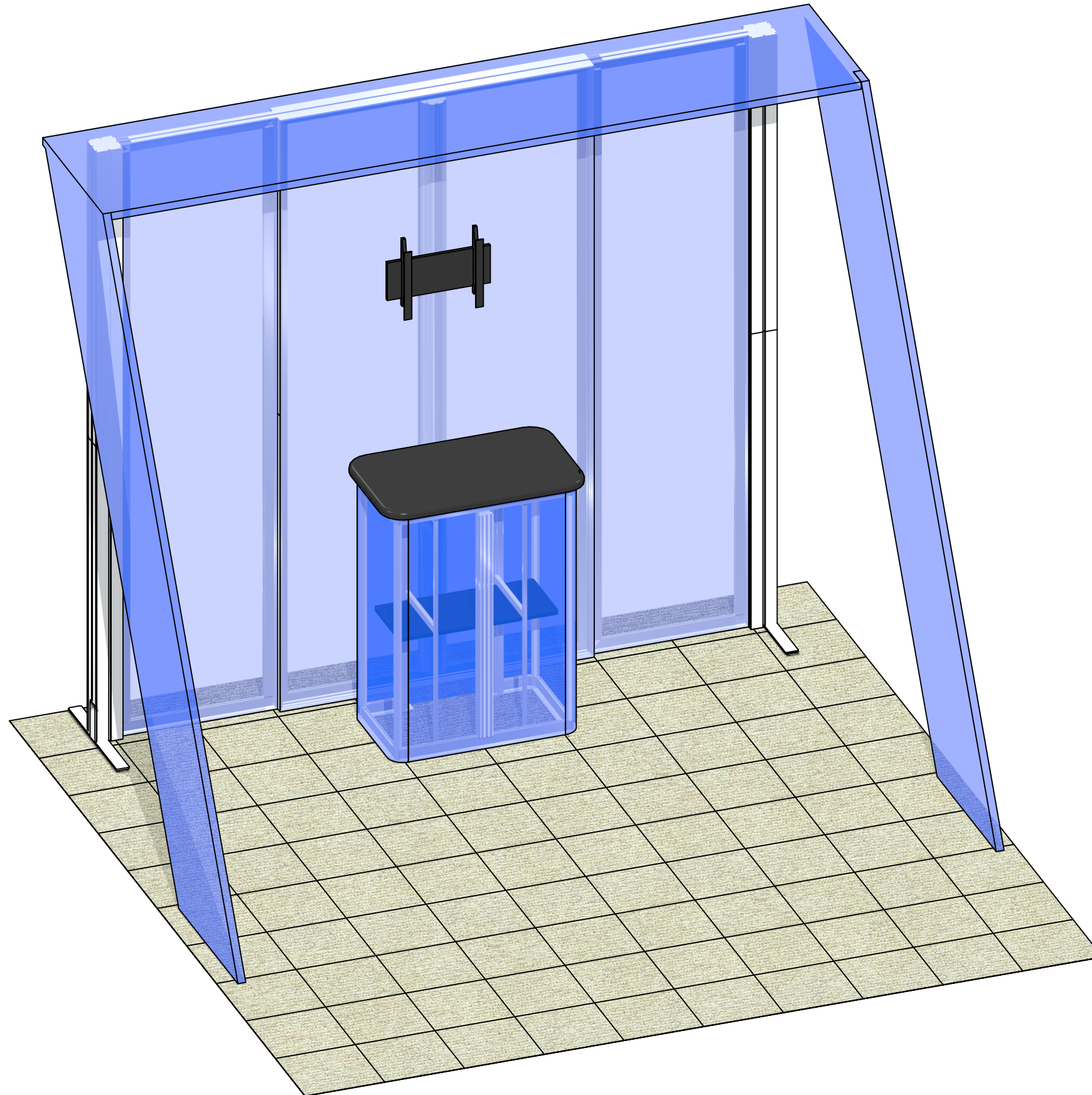

| Code | # | Description |
|------------|---|--|
| MM-MB | 1 | MEDIUM MONITOR BRACKET FOR MONITORS 15"-40" |
| R9 | 2 | 1200MM (47.24") PHFC4 EXTRUSION WITH MITRE CUT BOTH ENDS |
| R27 | 4 | 1200MM (47.24") PHFC4 EXTRUSION WITH MITRE CUT 1 END FOR CB9 ONE END-IB2 HOLES ONE END |
| R55 | 4 | 510MM (20.08") PHFC2 EXTRUSION WITH LOCKS 2 ENDS |
| R19 | 8 | 1155MM (45.47") PHFC2 EXTRUSION WITH IB2 HOLE ONE SIDE-WITH LOCK 1 END WITH SIDE CAM LOCKS |
| R15 | 4 | 1200MM (47.24") 100MM PM4S2 SQUARE EXTRUSION WITH PH2 STOP AT 600MM |
| GRAPHIC B | 1 | 94 1/2" (H) X 47 1/4" (W) SINGLE SIDED DYESUB GRAPHIC W/ FCE-2 (SEG) ON PERIMETER |
| GRAPHIC A2 | 1 | 94 1/2" (H) X 23 5/8" (W) SINGLE SIDED DYESUB GRAPHIC W/ FCE-2 (SEG) ON PERIMETER |
| R12 | 2 | 1155MM (45.47") 100MM PM4R8 ROUND EXTRUSION WITH LOCKS 1 END WITH PH2 STOP AT 155MM |
| R13 | 2 | 600MM (23.62") PM4D CONNECTOR WITH TENSION GLIDES |
| IB2 | 6 | PH INLINE CONNECTOR |
| CB9-S | 8 | 50MM SQUARE PHCF2 CORNER BRACKET |
| GRAPHIC A1 | 1 | 94 1/2" (H) X 23 5/8" (W) SINGLE SIDED DYESUB GRAPHIC W/ FCE-2 (SEG) ON PERIMETER |
| CB9 | 4 | CB9 CORNER BRACKET |
| CUSTOM FS | 1 | APPROXIMATELY 8' X 10' X 8' CUSTOM FABRIC STRUCTURE - TO PACK INTO OCE - |
| R14 | 1 | 300MM (11.81") PM4D CONNECTOR WITH TENSION GLIDES |
| SW-FOOT | 2 | SMARTWALL SUPPORT FOOT |

BOM

R-HP-K-07

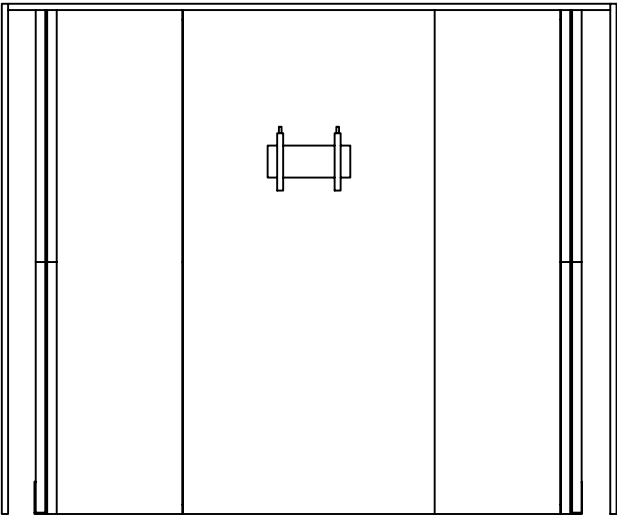
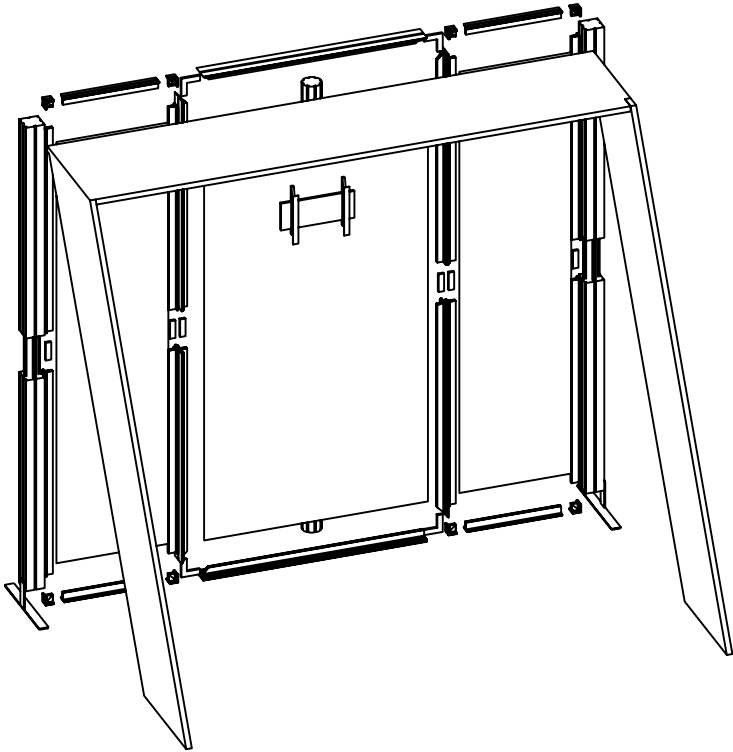
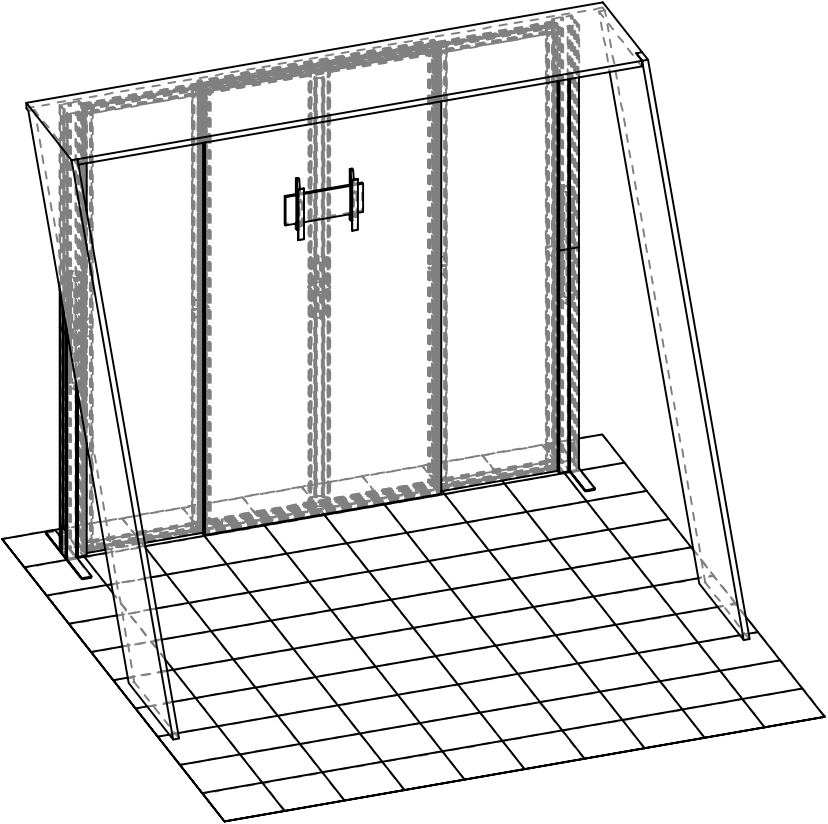
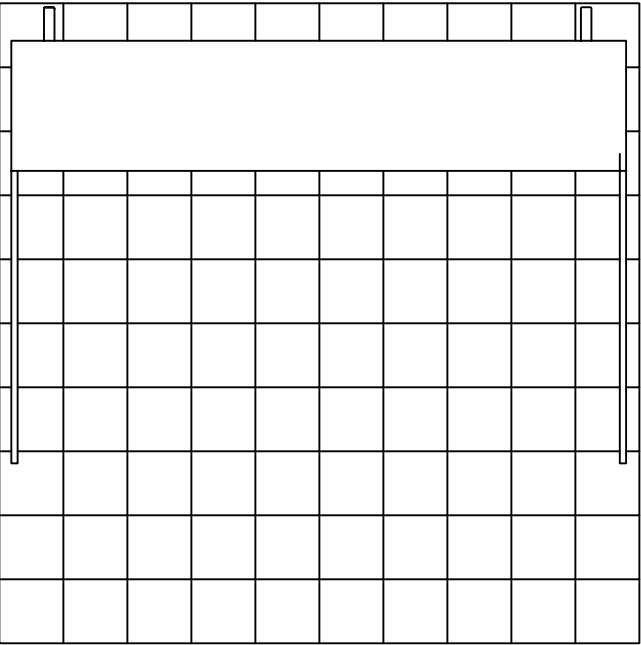

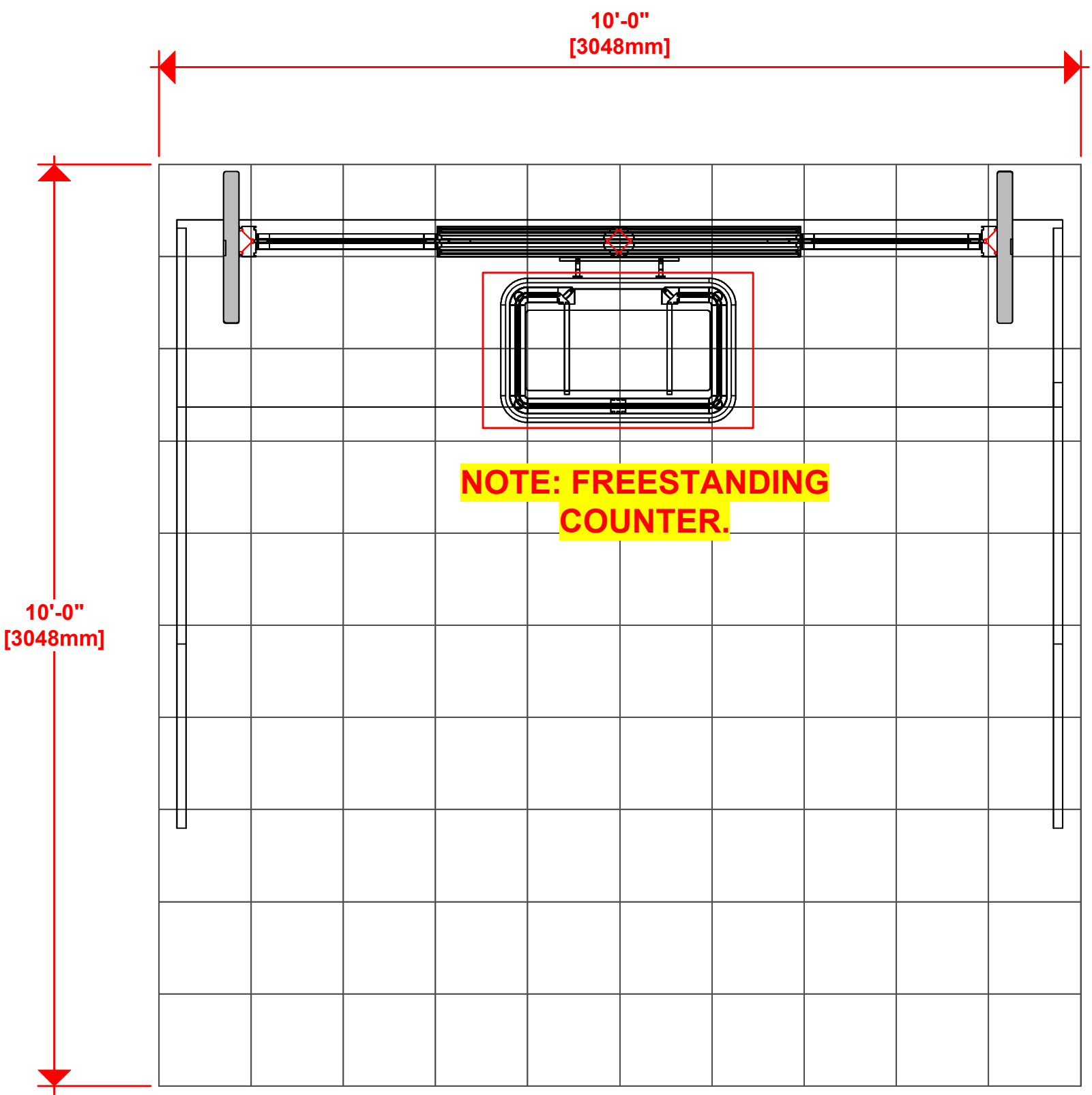

1. Redesign of this exhibit without approval by manufacturer may result in dangerous and unsafe structures. Manufacturer disclaims any responsibility for redesigned exhibits it does not approve in writing.

2. Parts and components such as panels and extrusions are manufactured to metric sizing. Where ever possible sizes have been noted in feet and inches as well as in metric. Below is the imperial to metric sizing table as reference. "Nominal" refers to approximate size.

- | | |
|--------------------|---------------------------------|
| 2400mm = (94 1/2") | Phone Line / Fax |
| 2100mm = (82 5/8") | Internet connection |
| 1800mm = (70 7/8") | Outlet |
| 1500mm = (59") | Main Drop (point of distrution) |
| 1200mm = (47 1/4") | |
| 900mm = (35 1/2") | |
| 600mm = (23 5/8") | |
| 300mm = (11 7/8") | |
- Wire running under carpet

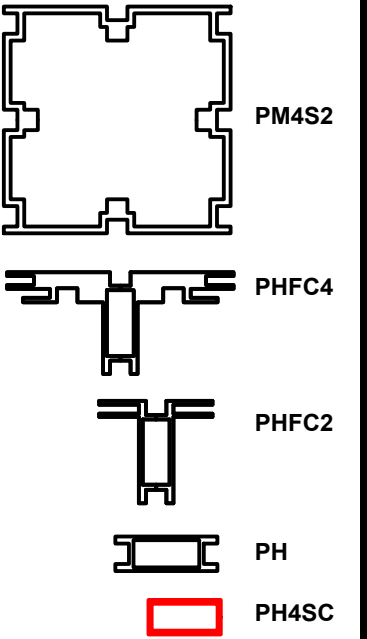

HYBRID PRO RENTAL KIT

Title: SET-UP INSTRUCTIONS

| Code | # | Description |
|------|---|---|
| R9 | 2 | 1200MM (47.24") PHFC4 EXTRUSION WITH MITRE CUT BOTH ENDS |
| R27 | 4 | 1200MM (47.24") PHFC4 EXTRUSION WITH MITRE CUT 1 END FOR CB9 ONE EN |
| R12 | 2 | 1155MM (45.47") 100MM PM4R8 ROUND EXTRUSION WITH LOCKS 1 END WITH |
| IB2 | 2 | PH INLINE CONNECTOR |
| CB9 | 4 | CB9 CORNER BRACKET |
| R14 | 1 | 300MM (11.81") PM4D CONNECTOR WITH TENSION GLIDES |

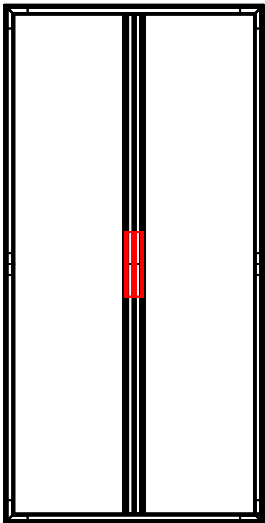
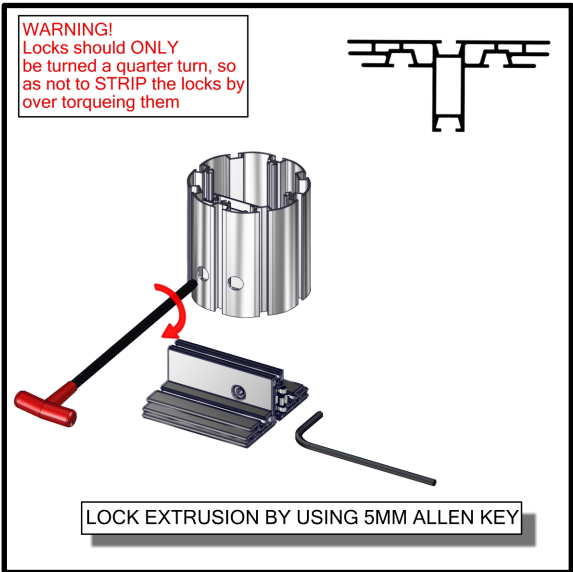
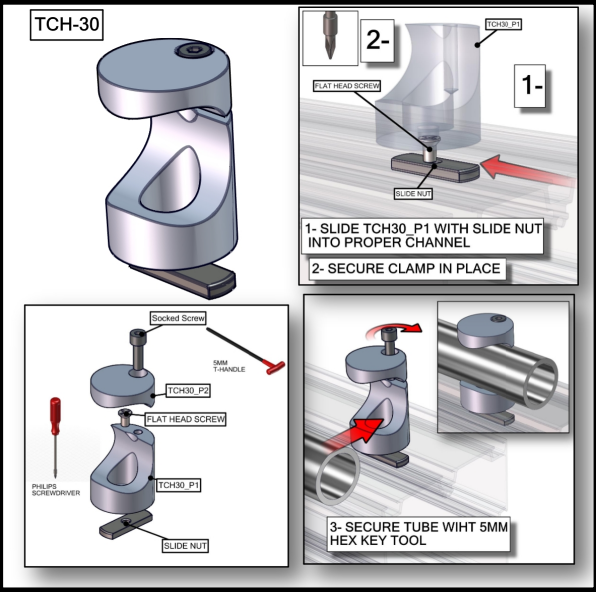
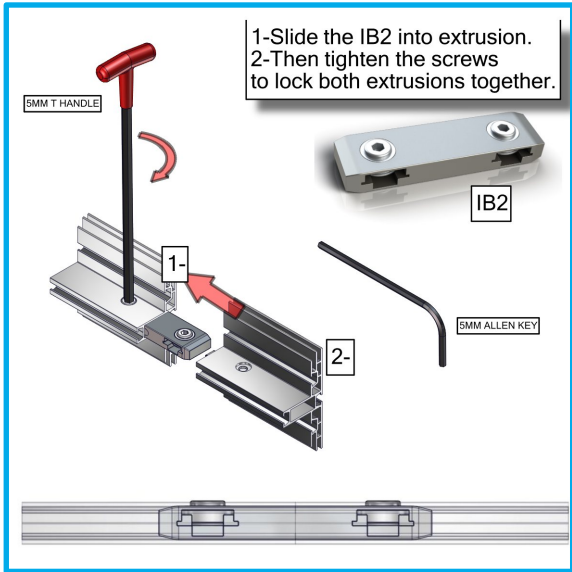
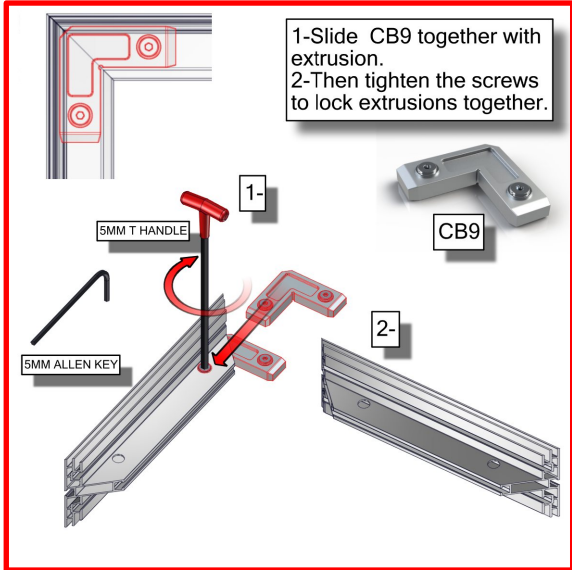
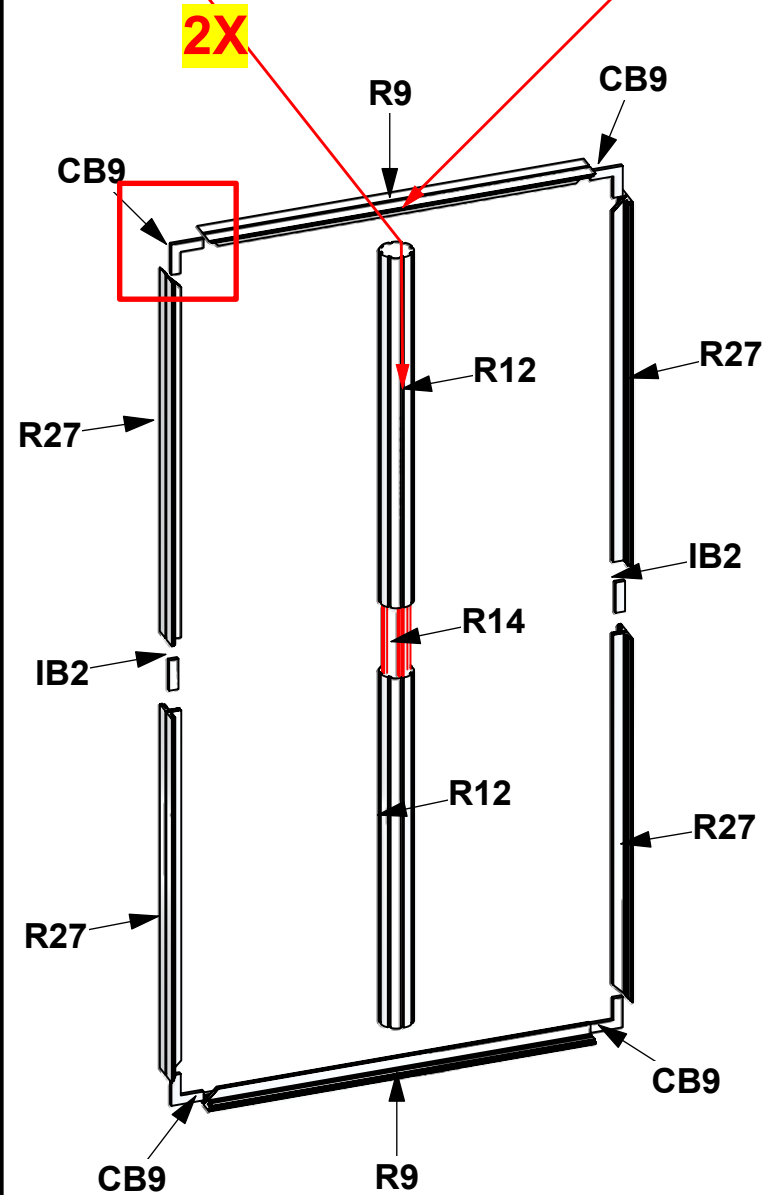
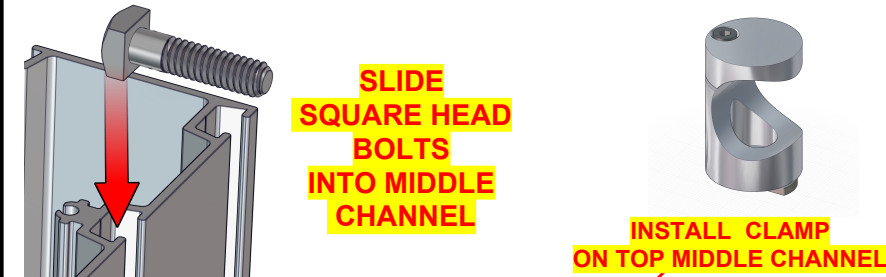

1. Redesign of this exhibit without approval by manufacturer may result in dangerous and unsafe structures. Manufacturer disclaims any responsibility for redesigned exhibits it does not approve in writing.

2. Parts and components such as panels and extrusions are manufactured to metric sizing. Where ever possible sizes have been noted in feet and inches as well as in metric. Below is the imperial to metric sizing table as reference. "Nominal" refers to approximate size.

2400mm = (94 1/2")
2100mm = (82 5/8")
1800mm = (70 7/8")
1500mm = (59")
1200mm = (47 1/4")
900mm = (35 1/2")
600mm = (23 5/8")
300mm = (11 7/8")

Phone Line / Fax
Internet connection
Outlet
Main Drop (point of distrution)
Wire running under carpet

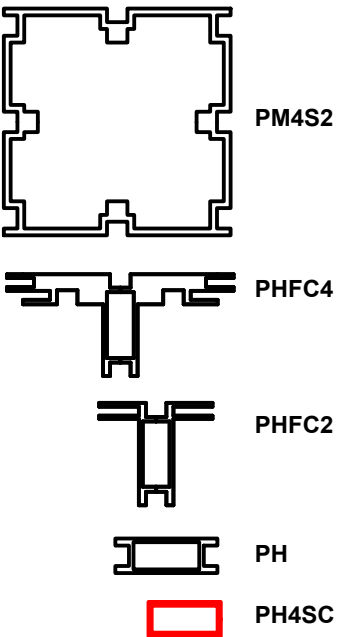

HYBRID PRO RENTAL KIT

Title: SET-UP INSTRUCTIONS

| Code | # | Description |
|-------|---|---|
| R55 | 4 | 510MM (20.08") PHFC2 EXTRUSION WITH LOCKS 2 ENDS |
| R19 | 8 | 1155MM (45.47") PHFC2 EXTRUSION WITH IB2 HOLE ONE SIDE-WITH LOCK 1 EN |
| IB2 | 4 | PH INLINE CONNECTOR |
| CB9-S | 8 | 50MM SQUARE PHCF2 CORNER BRACKET |

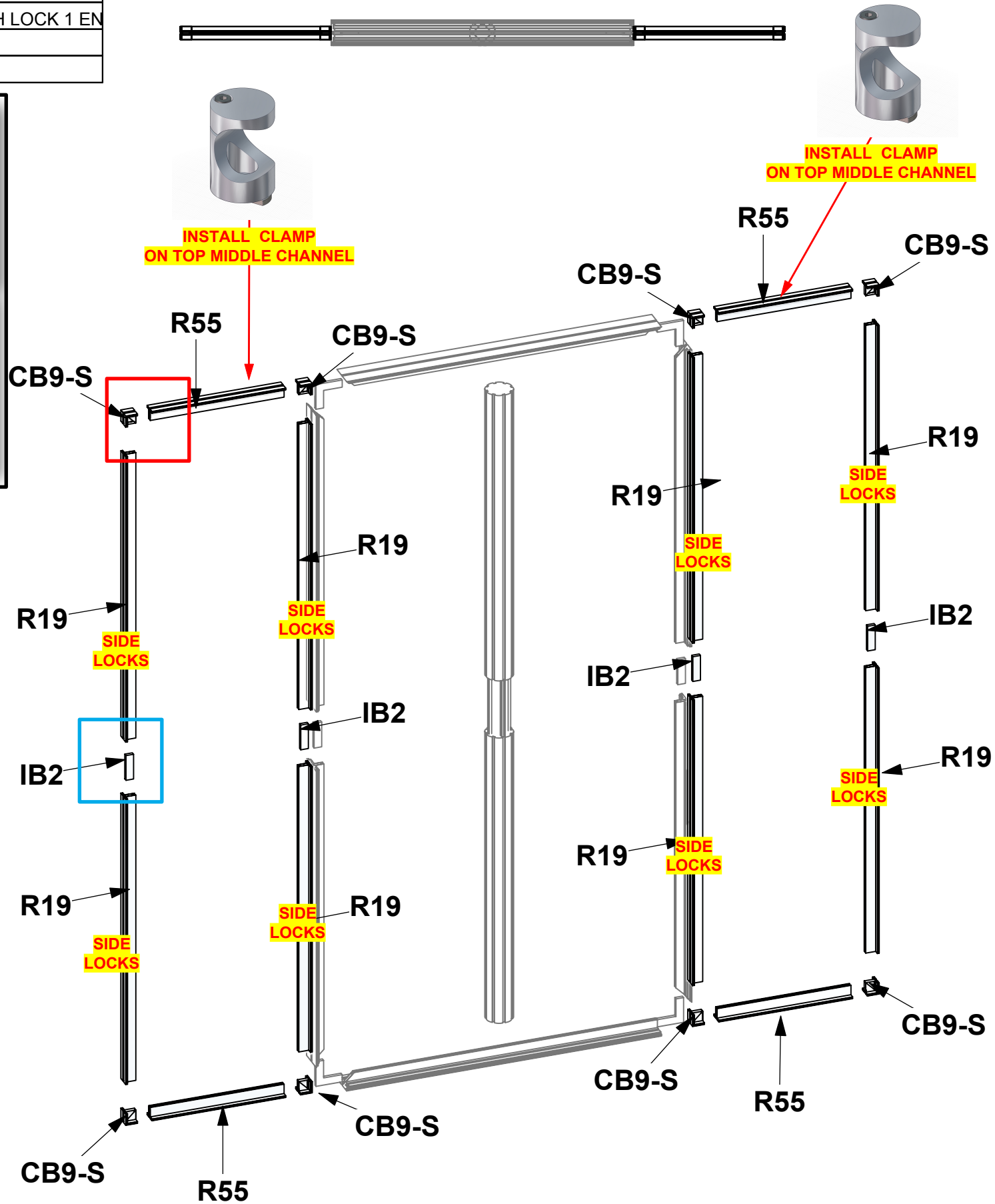
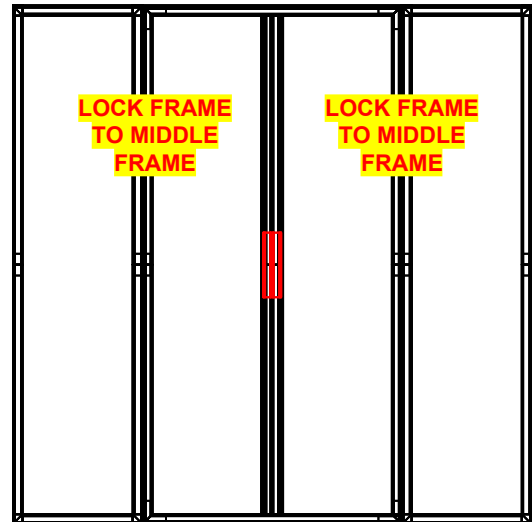
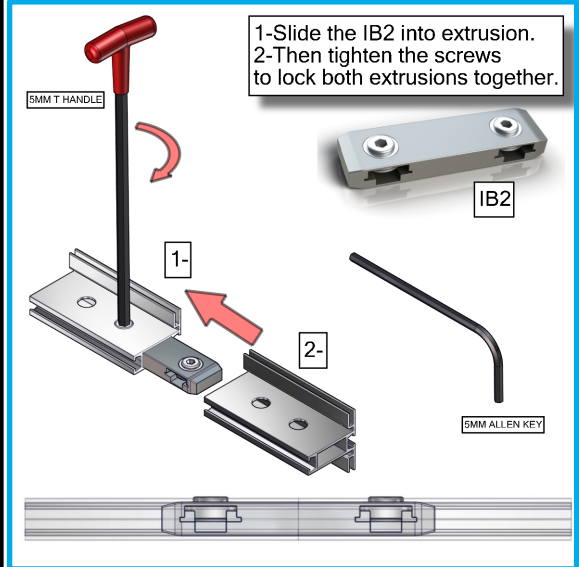
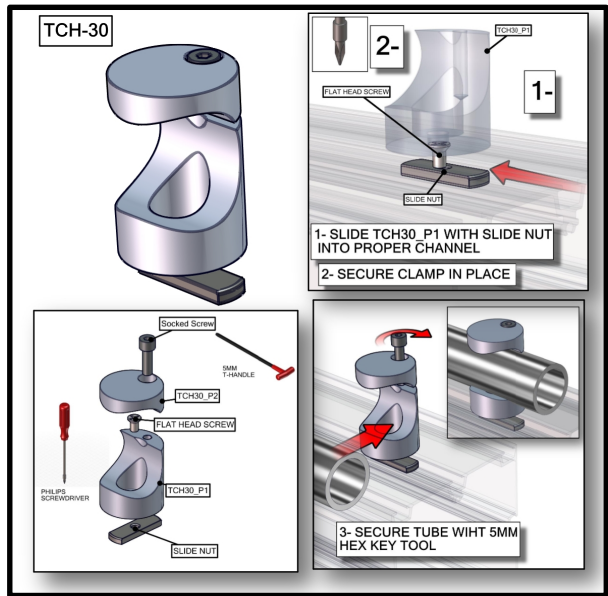
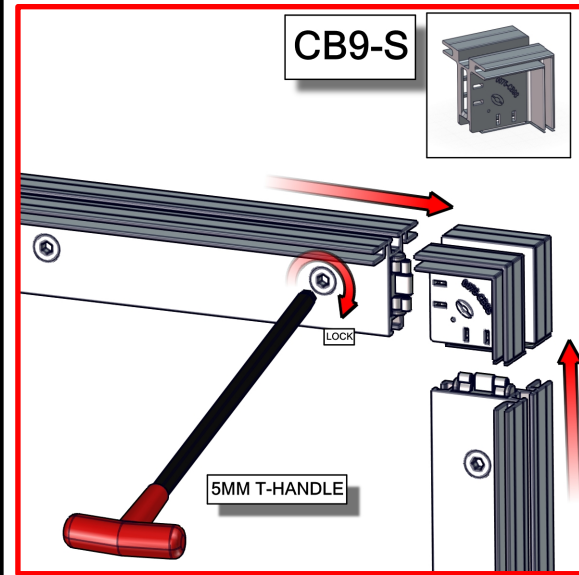

1. Redesign of this exhibit without approval by manufacturer may result in dangerous and unsafe structures. Manufacturer disclaims any responsibility for redesigned exhibits it does not approve in writing.

2. Parts and components such as panels and extrusions are manufactured to metric sizing. Where ever possible sizes have been noted in feet and inches as well as in metric. Below is the imperial to metric sizing table as reference. "Nominal" refers to approximate size.

| | |
|--------------------|---------------------------------|
| 2400mm = (94 1/2") | Phone Line / Fax |
| 2100mm = (82 5/8") | Internet connection |
| 1800mm = (70 7/8") | Outlet |
| 1500mm = (59") | Main Drop (point of distrution) |
| 1200mm = (47 1/4") | |
| 900mm = (35 1/2") | |
| 600mm = (23 5/8") | |
| 300mm = (11 7/8") | |

Wire running under carpet

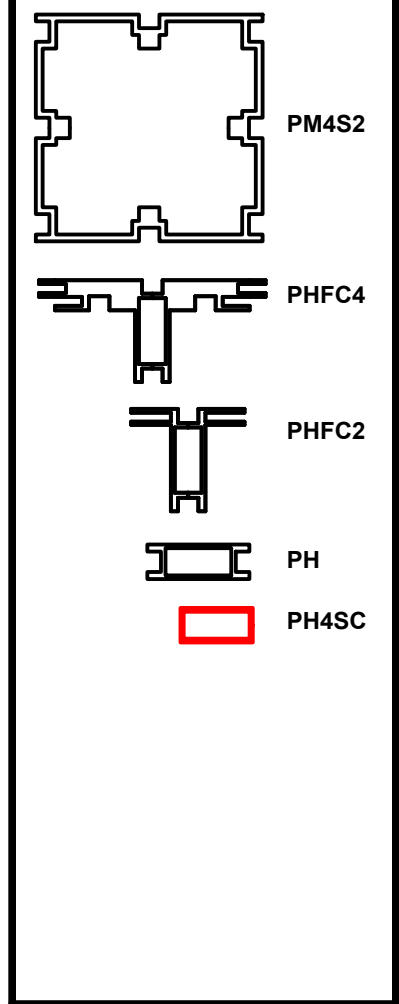

HYBRID PRO RENTAL KIT

Title: SET-UP INSTRUCTIONS

| Code | # | Description |
|---------|---|--|
| R15 | 4 | 1200MM (47.24") 100MM PM4S2 SQUARE EXTRUSION WITH PH2 STOP AT 600M |
| R13 | 2 | 600MM (23.62") PM4D CONNECTOR WITH TENSION GLIDES |
| SW-FOOT | 2 | SMARTWALL SUPPORT FOOT |

WARNING!
Locks should ONLY be turned a quarter turn, so as not to STRIP the locks by over torqueing them

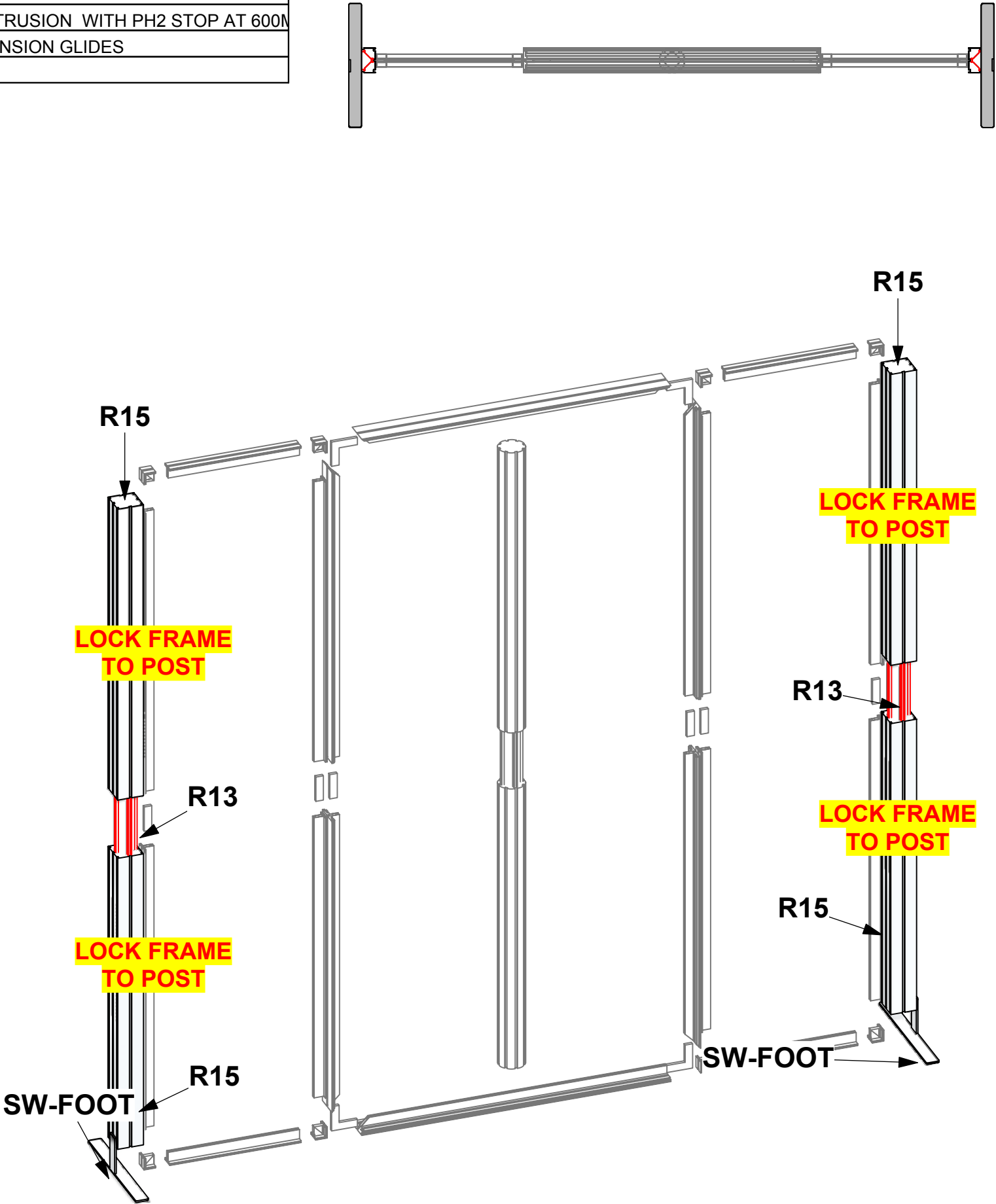
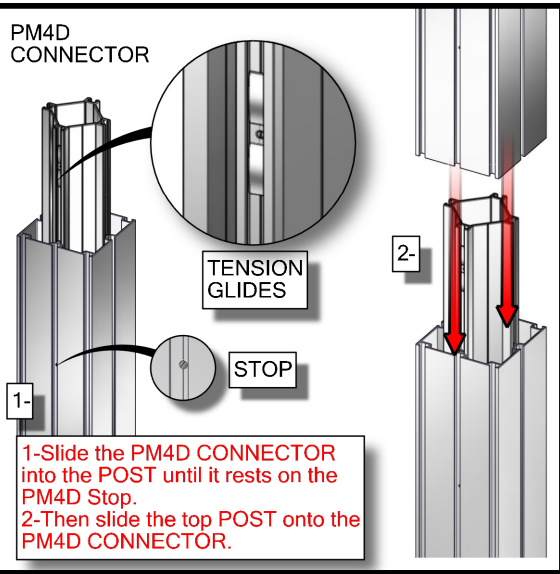
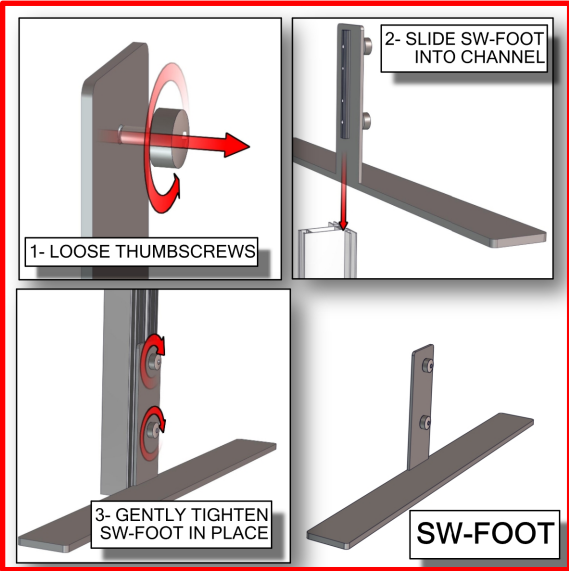
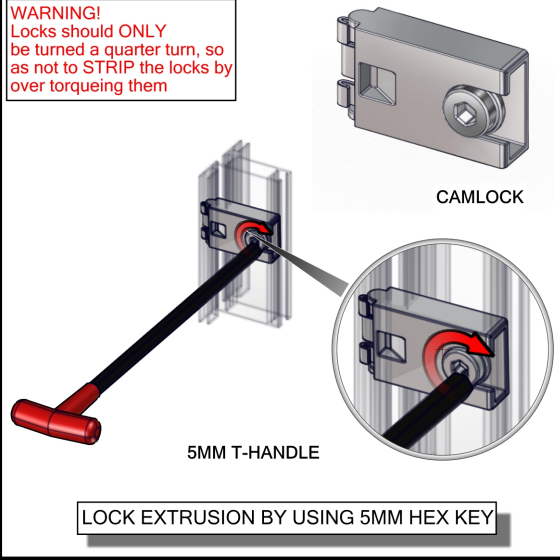

1. Redesign of this exhibit without approval by manufacturer may result in dangerous and unsafe structures. Manufacturer disclaims any responsibility for redesigned exhibits it does not approve in writing.

2. Parts and components such as panels and extrusions are manufactured to metric sizing. Where ever possible sizes have been noted in feet and inches as well as in metric. Below is the imperial to metric sizing table as reference. "Nominal" refers to approximate size.

| | |
|--------------------|---------------------------------|
| 2400mm = (94 1/2") | Phone Line / Fax |
| 2100mm = (82 5/8") | Internet connection |
| 1800mm = (70 7/8") | Outlet |
| 1500mm = (59") | Main Drop (point of distrution) |
| 1200mm = (47 1/4") | |
| 900mm = (35 1/2") | |
| 600mm = (23 5/8") | |
| 300mm = (11 7/8") | |

Wire running under carpet

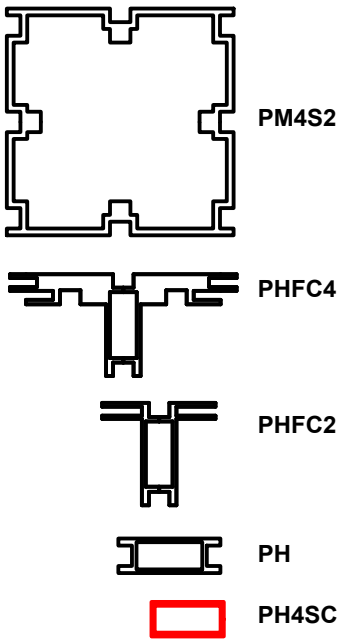

HYBRID PRO RENTAL KIT

Title: SET-UP INSTRUCTIONS

| Code | # | Description |
|------------|---|---|
| MM-MB | 1 | MEDIUM MONITOR BRACKET FOR MONITORS 15"-40" |
| GRAPHIC B | 1 | 94 1/2" (H) X 47 1/4" (W) SINGLE SIDED DYESUB GRAPHIC W/ FCE-2 (SEG) ON PERIMETER |
| GRAPHIC A2 | 1 | 94 1/2" (H) X 23 5/8" (W) SINGLE SIDED DYESUB GRAPHIC W/ FCE-2 (SEG) ON PERIMETER |
| GRAPHIC A1 | 1 | 94 1/2" (H) X 23 5/8" (W) SINGLE SIDED DYESUB GRAPHIC W/ FCE-2 (SEG) ON PERIMETER |

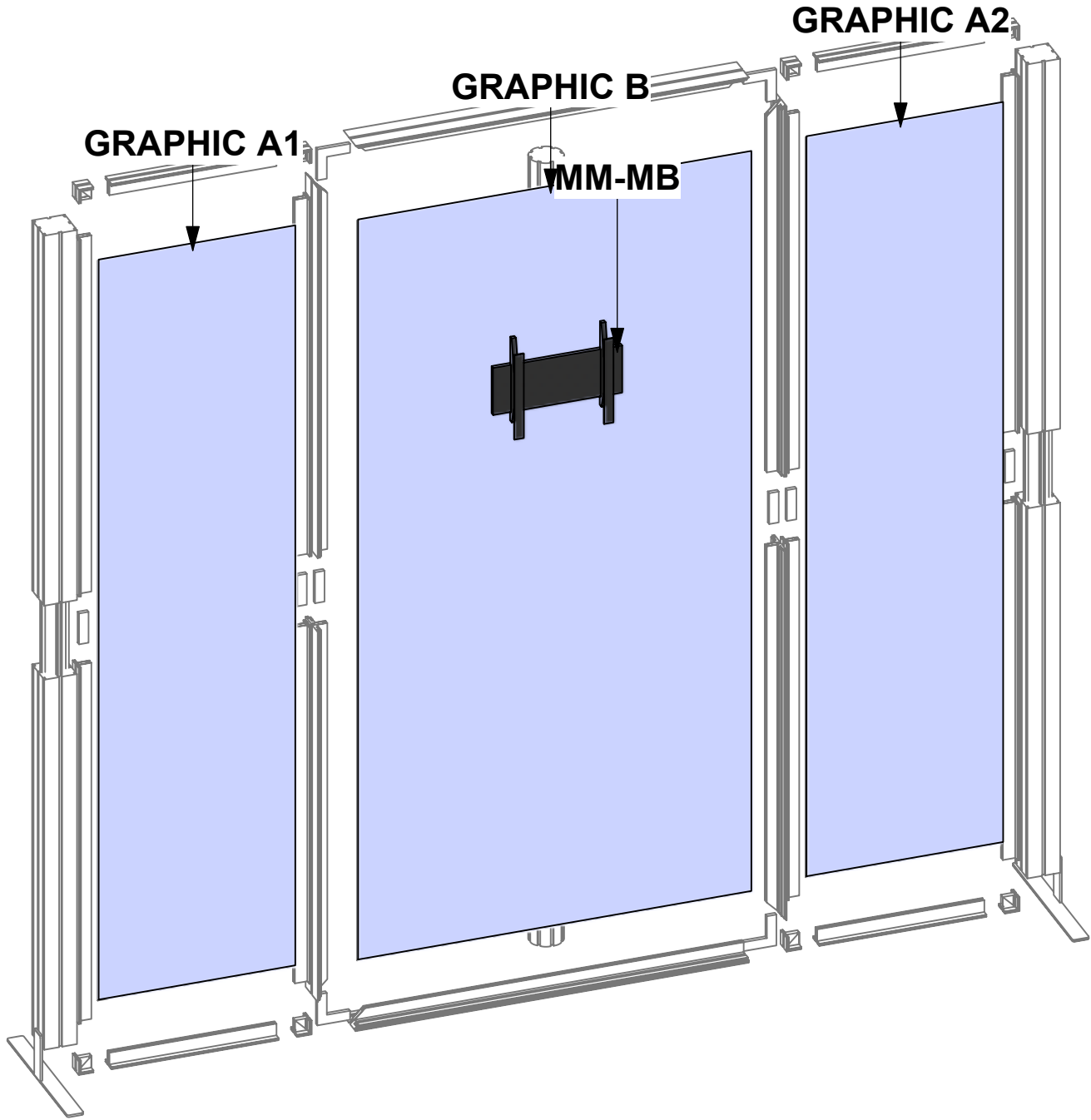
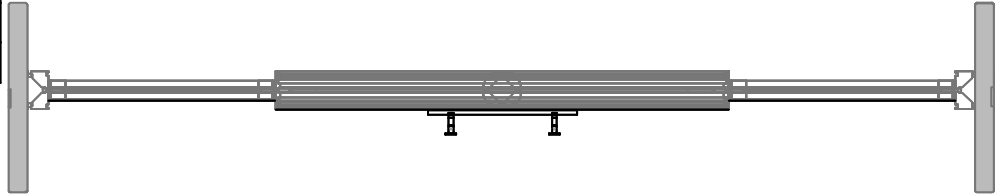
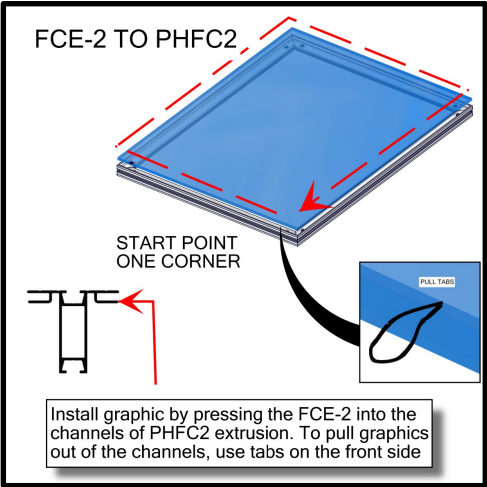
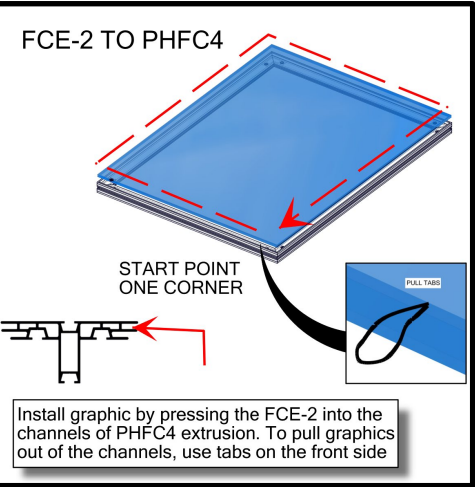
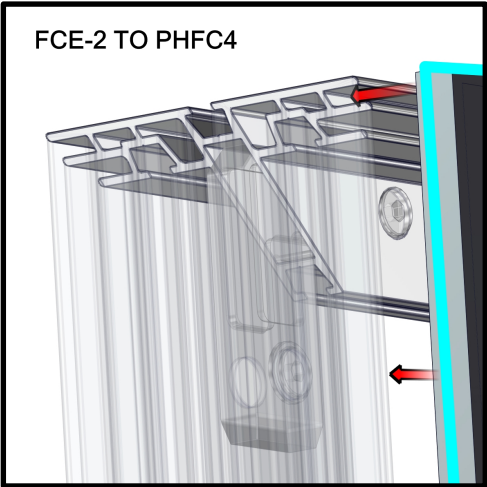
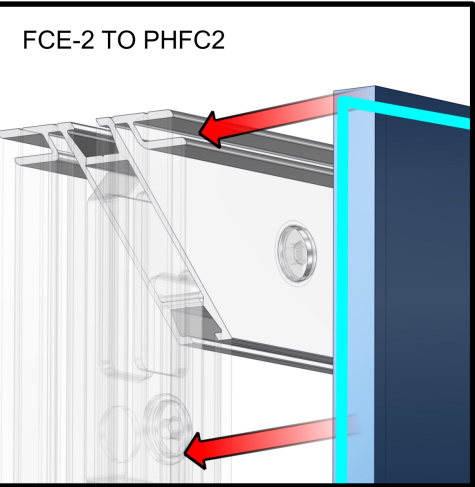
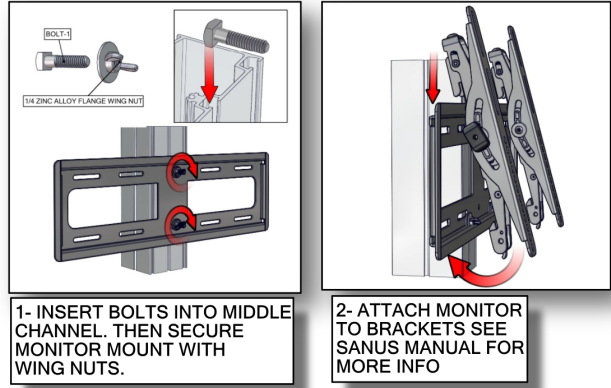
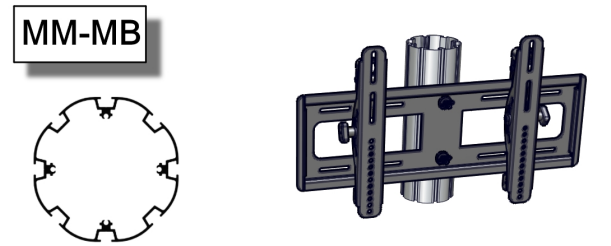

1. Redesign of this exhibit without approval by manufacturer may result in dangerous and unsafe structures. Manufacturer disclaims any responsibility for redesigned exhibits it does not approve in writing.

2. Parts and components such as panels and extrusions are manufactured to metric sizing. Where ever possible sizes have been noted in feet and inches as well as in metric. Below is the imperial to metric sizing table as reference. "Nominal" refers to approximate size.

2400mm = (94 1/2")
2100mm = (82 5/8")
1800mm = (70 7/8")
1500mm = (59")
1200mm = (47 1/4")
900mm = (35 1/2")
600mm = (23 5/8")
300mm = (11 7/8")

Phone Line / Fax
Internet connection
Outlet
Main Drop (point of distrution)
Wire running under carpet

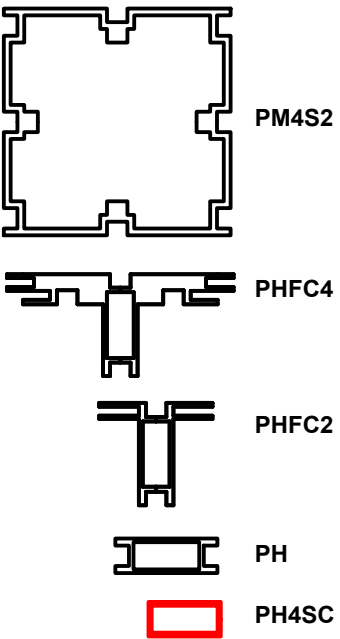

HYBRID PRO RENTAL KIT

Title: SET-UP INSTRUCTIONS

SET UP INSTRUCTIONS:

- 1. CONNECT BOTTOM AND TOP RAILS FOLLOWING THE LABELS
- 2. CONNECT SIDE RAILS
- 3. CLEAN THE FRAME AND PLACE THEM ON CLEAN PLACE
- 4. CAREFULLY REMOVE FABRIC COVER FROM BAGS
- 5. PLACE COVER AROUND THE BOTTOM OF THE FRAME
- 6. PULL COVER CAREFULLY UP TO THE TOP
- 7. CLOSE ALL ZIPPERS
- 8. ADJUST FABRIC AROUND THE FRAME

BREAK DOWN INSTRUCTIONS:

REVERSE SET-UP STEPS TO BREAKDOWN FRAME

FABRIC CARE INSTRUCTIONS:

- 1. UNZIP COVER ZIPPERS
- 2. CAREFULLY REMOVE FABRIC COVER
- 3. CLOSE ALL ZIPPERS
- 4. FOLD OR ROLL NEATLY
- 5. PLACE FABRIC IN COVER BAG

PART LIST:

- PER UNIT
- 21 30MM DIA. TUBE SECTIONS
 - 26 ES-30 EXPANDING SPIGOT
 - 1 2.5MM HEX KEY
 - 3 TCH-30 CLAMPS
 - 1 FABRIC COVER

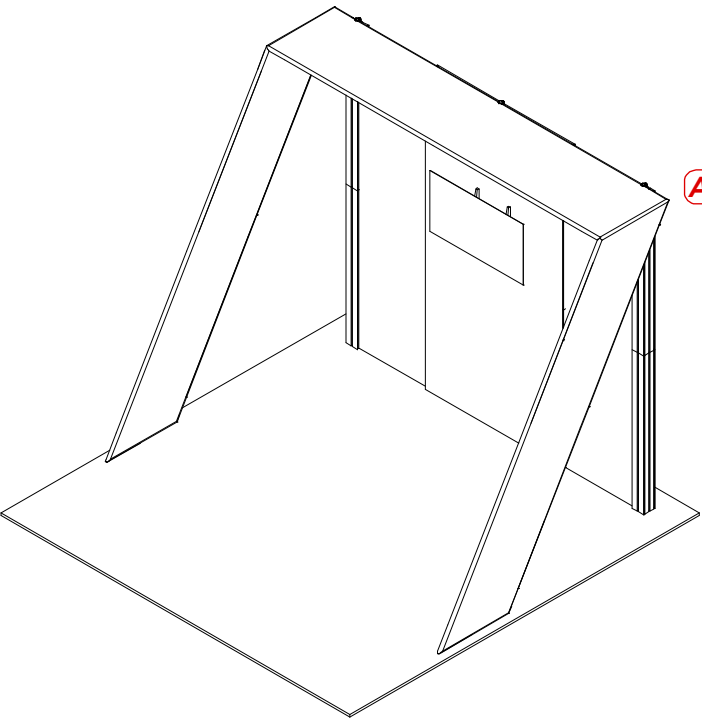

Frame 'A' Assembly

Assemble frame as shown

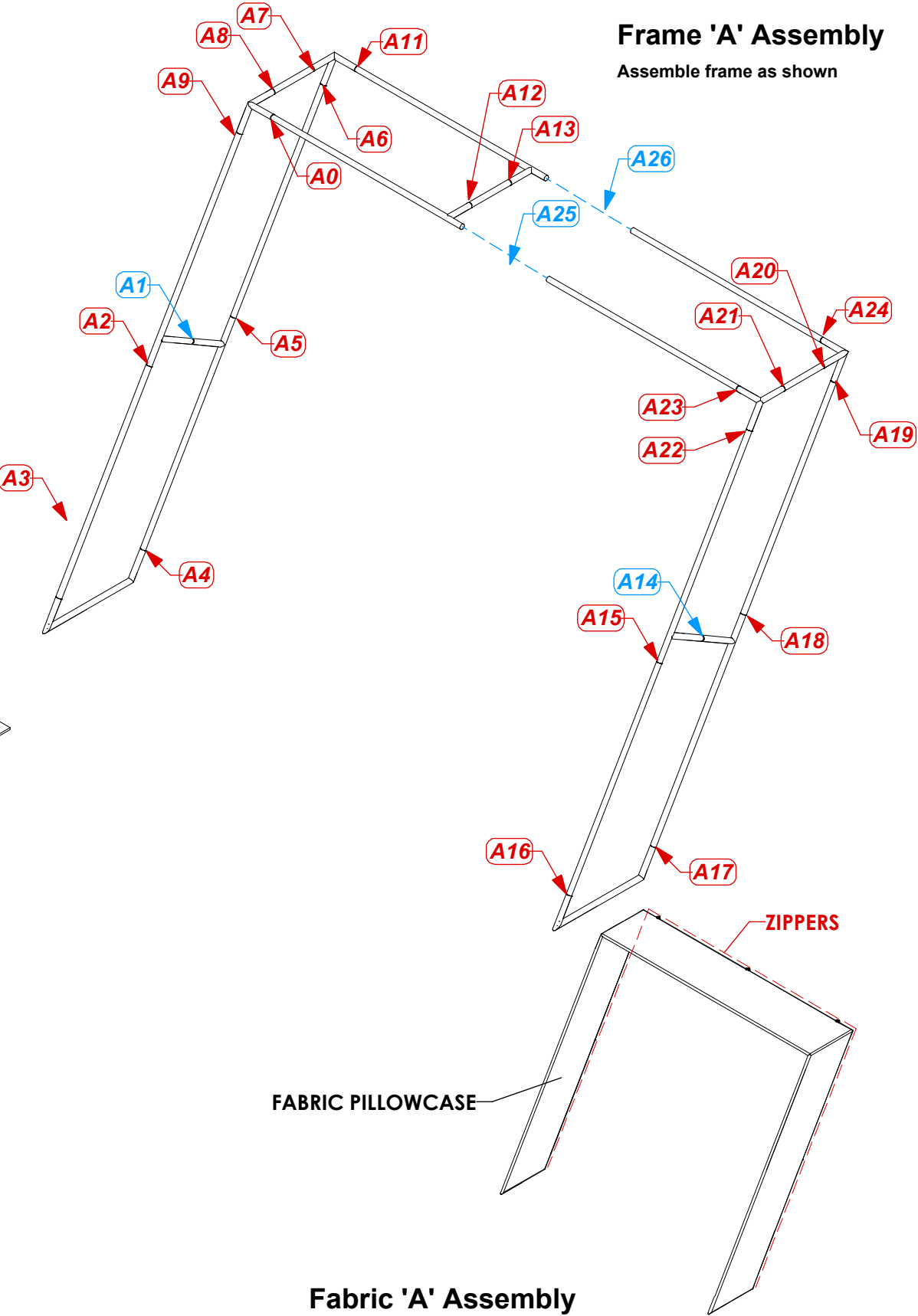

FABRIC PILLOWCASE

Fabric 'A' Assembly

1. Redesign of this exhibit without approval by manufacturer may result in dangerous and unsafe structures. Manufacturer disclaims any responsibility for redesigned exhibits it does not approve in writing.

2. Parts and components such as panels and extrusions are manufactured to metric sizing. Where ever possible sizes have been noted in feet and inches as well as in metric. Below is the imperial to metric sizing table as reference. "Nominal" refers to approximate size.

| | |
|--------------------|---------------------------------|
| 2400mm = (94 1/2") | Phone Line / Fax |
| 2100mm = (82 5/8") | Internet connection |
| 1800mm = (70 7/8") | Outlet |
| 1500mm = (59") | Main Drop (point of distrution) |
| 1200mm = (47 1/4") | |
| 900mm = (35 1/2") | |
| 600mm = (23 5/8") | |
| 300mm = (11 7/8") | |

Wire running under carpet

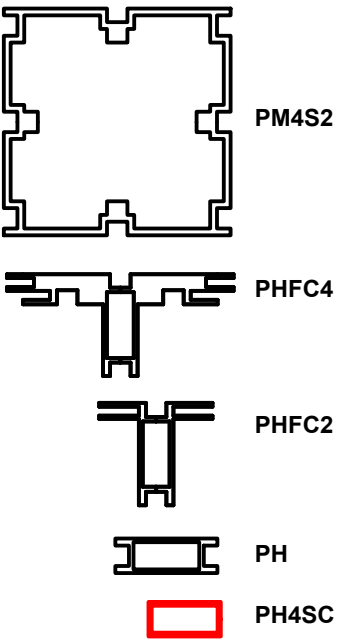

HYBRID PRO RENTAL KIT

Title: SET-UP INSTRUCTIONS

| Code | # | Description |
|-----------|---|--|
| CUSTOM FS | 1 | APPROXIMATELY 8' X 10' X 8' CUSTOM FABRIC STRUCTURE - TO PACK INTO |

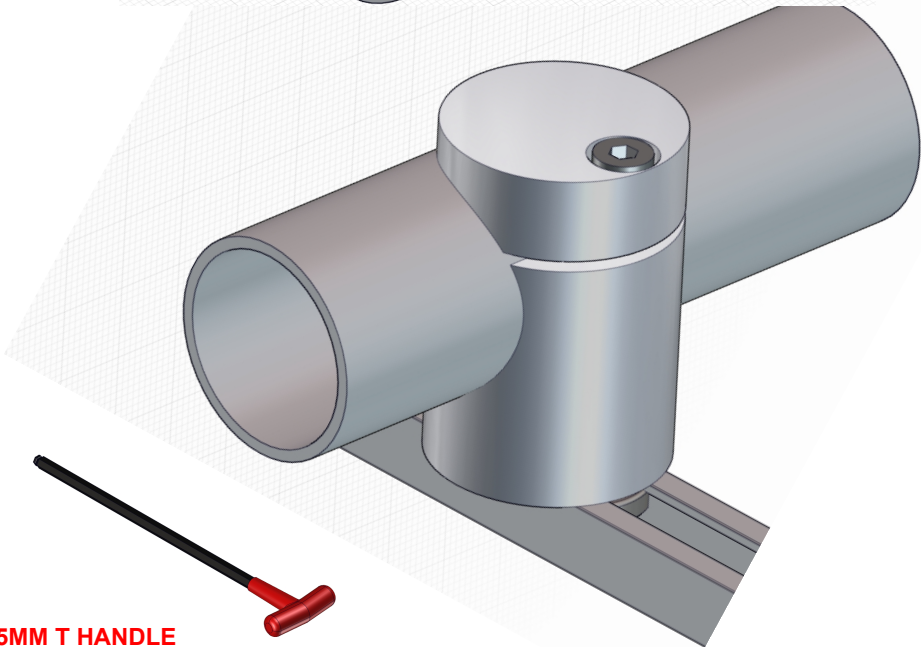
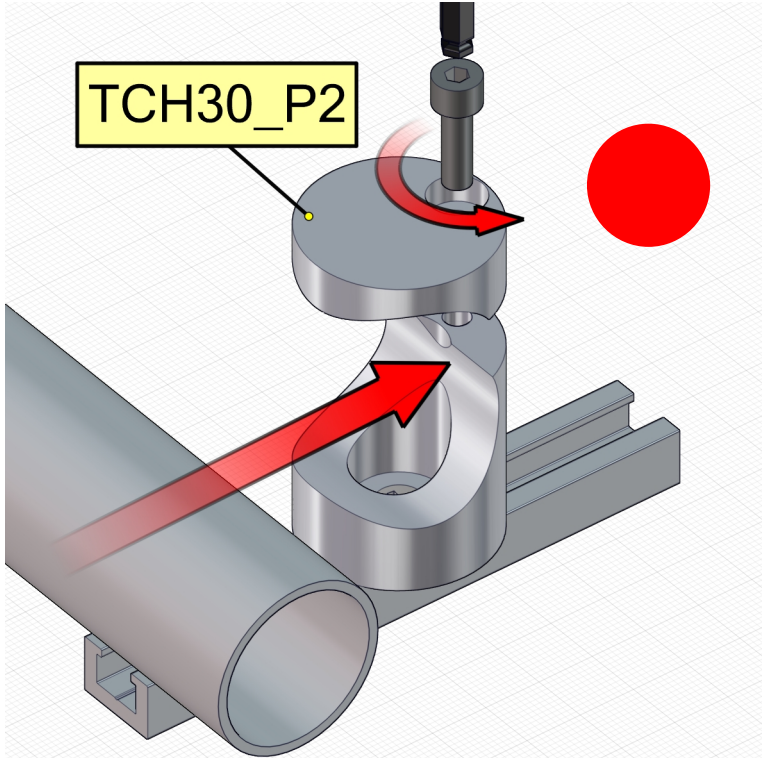
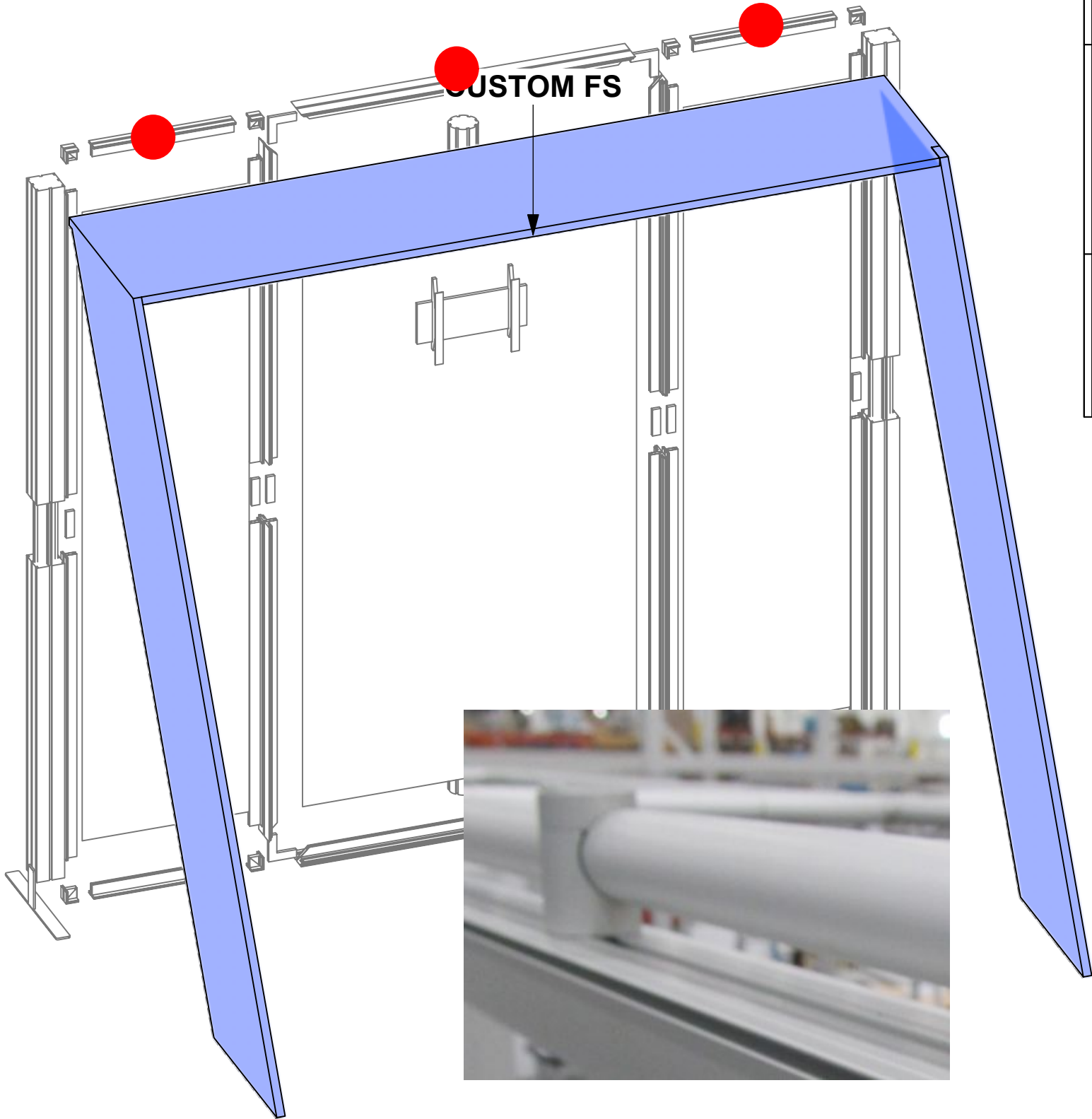

1. Redesign of this exhibit without approval by manufacturer may result in dangerous and unsafe structures. Manufacturer disclaims any responsibility for redesigned exhibits it does not approve in writing.
2. Parts and components such as panels and extrusions are manufactured to metric sizing. Where ever possible sizes have been noted in feet and inches as well as in metric. Below is the imperial to metric sizing table as reference. "Nominal" refers to approximate size.
- 2400mm = (94 1/2")
2100mm = (82 5/8")
1800mm = (70 7/8")
1500mm = (59")
1200mm = (47 1/4")
900mm = (35 1/2")
600mm = (23 5/8")
300mm = (11 7/8")
- Phone Line / Fax
 Internet connection
 Outlet
 Main Drop (point of distrution)
 Wire running under carpet

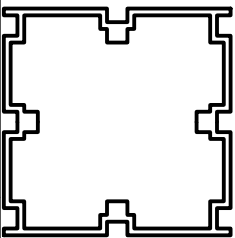

PM4S2

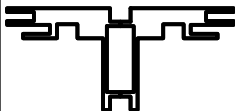

PHFC4

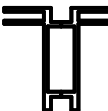

PHFC2



PH



PH4SC

HYBRID PRO RENTAL KIT

Title: SET-UP INSTRUCTIONS

PACKING INSTRUCTIONS



1

(1) MM-MB, (2) SW FOOT, (1) R14,
(1) R12, (4) R55
HARDWARE BOX



2

(8) R15, (1) R12, (2) R13

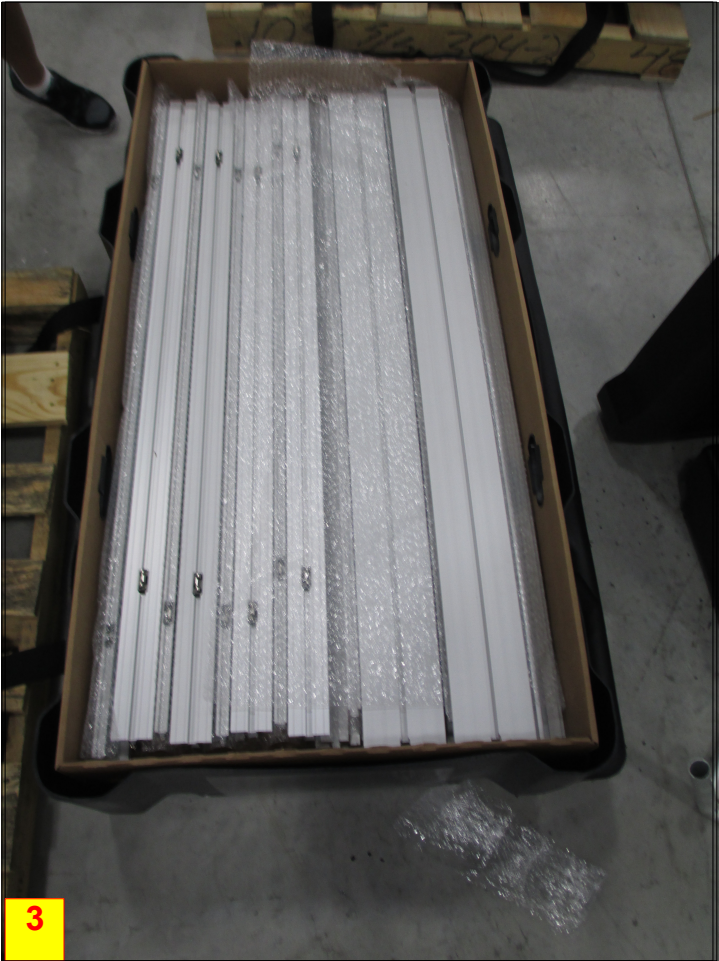

3

(8) R19, (3) R27,(2) R9



4

(1) R27, HARDWARE ITEMS

CASE # 1

| | | |
|--------|--|---|
| LEGEND | | GREY FOAM FOLDED TO FILL EMPTY SPACES OR USED AS PROTECTION |
| | | 1/8" CARDBOARD SPACER (PUT IN BETWEEN EVERY PANEL) |
| | | DIVIDER |
| | | 1/4" WHITE FOAM (USED AS PROTECTION DOOR PANELS W/ LOCKS) |





INTERNAL DIMS 48.25"L X 24"W X 14"H

EXTERNAL DIMS 51.5"L X 29"W X 14.5"H



FABRIC STRUCTURE

CASE # 2

| | | |
|--------|---|---|
| LEGEND |  | GREY FOAM FOLDED TO FILL EMPTY SPACES OR USED AS PROTECTION |
| |  | 1/8" CARDBOARD SPACER (PUT IN BETWEEN EVERY PANEL) |
| |  | DIVIDER |
| |  | 1/4" WHITE FOAM (USED AS PROTECTION DOOR PANELS W/ LOCKS) |

INTERNAL DIMS 11"w X 14"h X 38"d

EXTERNAL DIMS 18"w X 17"h X 39"d



R-VFC-04

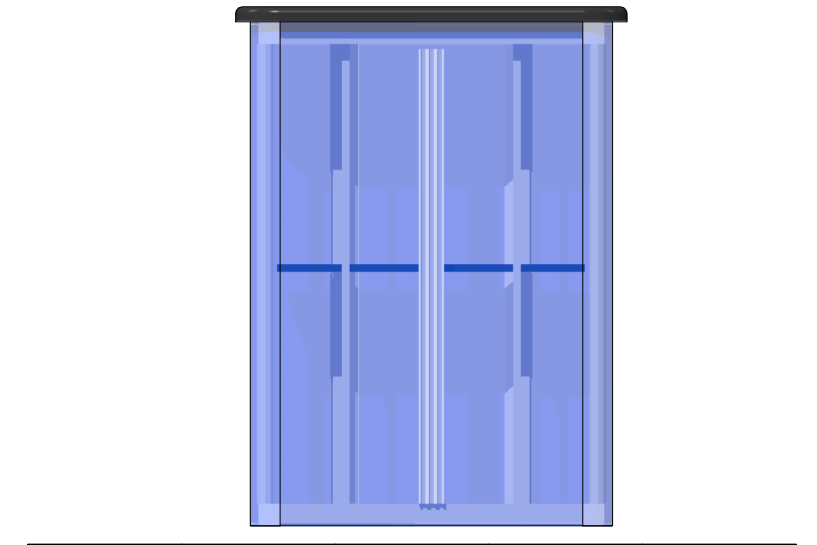
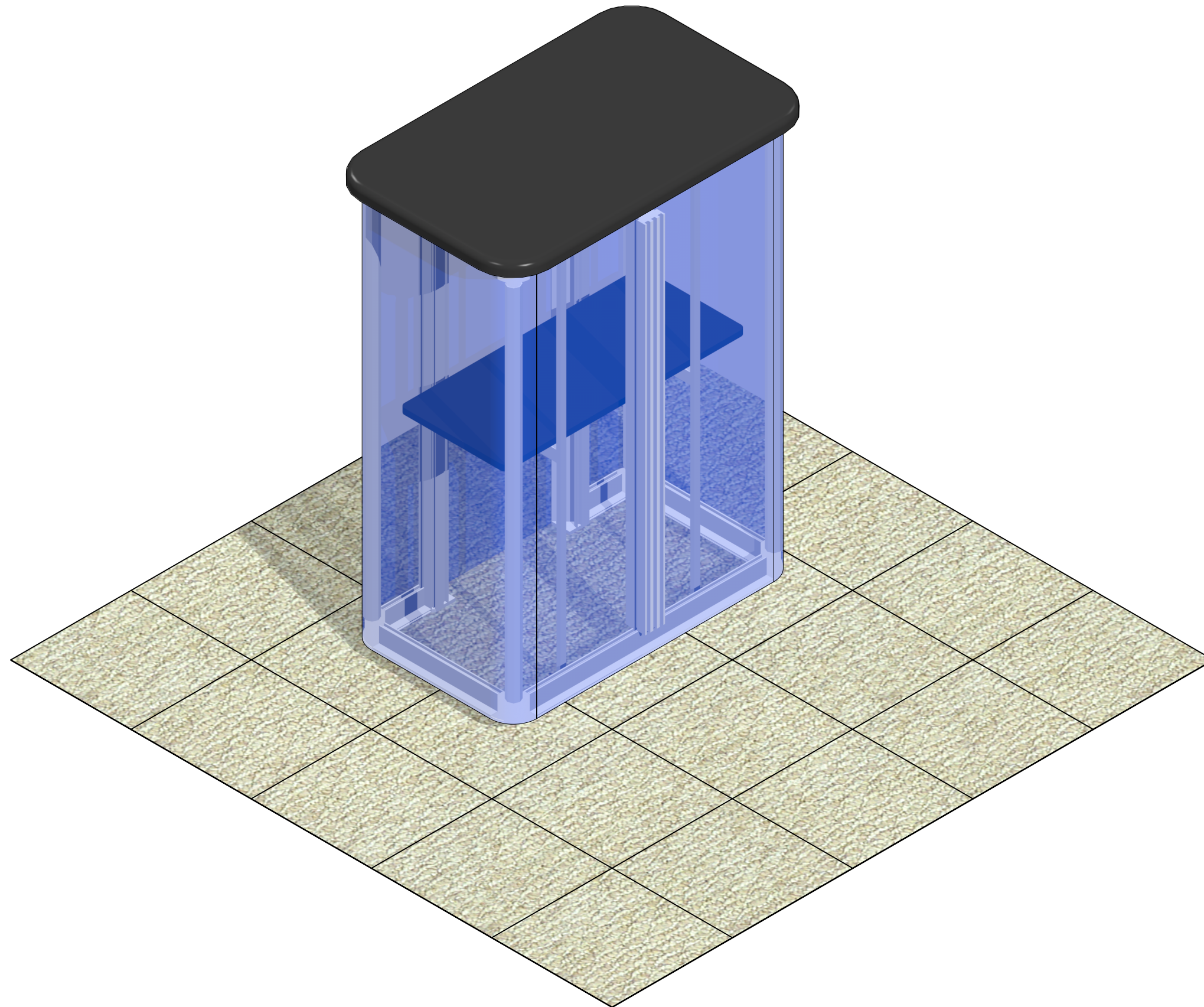

| Code | # | Description |
|--------------|---|---|
| GRAPHIC | 1 | 43 3/8" (H) X 15 1/2" (W) SINGLE SIDED DYESUB GRAPHIC W/ FCE-2 (SEG) ON PERIMETER |
| R6 | 4 | 300MM (11.81") PHFC2 EXTRUSION WITH LOCKS 2 ENDS |
| R5 | 4 | 100MM (3.94") PHFC2 EXTRUSION WITH LOCKS 2 ENDS |
| R109 | 4 | 910MM LENGTH 30mm (1.18 Inch) TUBE |
| R4 | 2 | 600MM (23.62") PHFC2 EXTRUSION WITH LOCKS 2 ENDS |
| VFC-04-CT | 1 | 3' X 2' LAMINATE COUNTER TOP [BLACK THERMAFORM] |
| R3 | 2 | 986MM (38.82") PMFC2-90 EXTRUSION-WITH LOCKS BOTH ENDS |
| PMFC2-90 CAP | 4 | PMFC2 90 DEGREE EXTRUSION CAP |
| R2 | 4 | 288MM (11.34") PH1 EXTRUSION WITH LOCKS 2 ENDS |
| R1 | 1 | 910MM (35.82") 50MM PM2S SQUARE EXTRUSION WITH LOCKS 2 ENDS |
| VFC-04-CT-S | 1 | INTERNAL SHELF FOR VECTOR COUNTER VFC-04 |
| GRAPHIC | 1 | 43 3/8" (H) X 77 1/4" (W) SINGLE SIDED DYESUB GRAPHIC W/ FCE-2 (SEG) ON PERIMETER |
| PE-1000 | 2 | 1000MM (39.37") PE EXTRUSION |
| CB10-R | 8 | 50MM ROUND PHCF2 CORNER BRACKET |

BOM

R-VFC-04

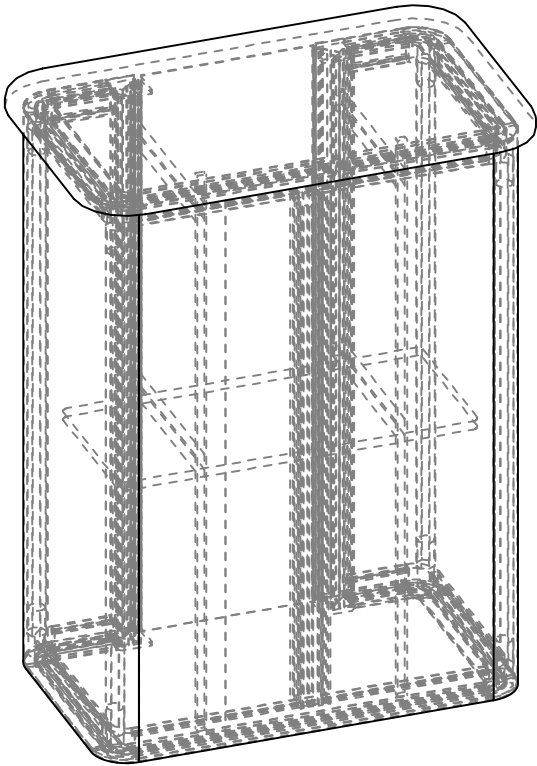
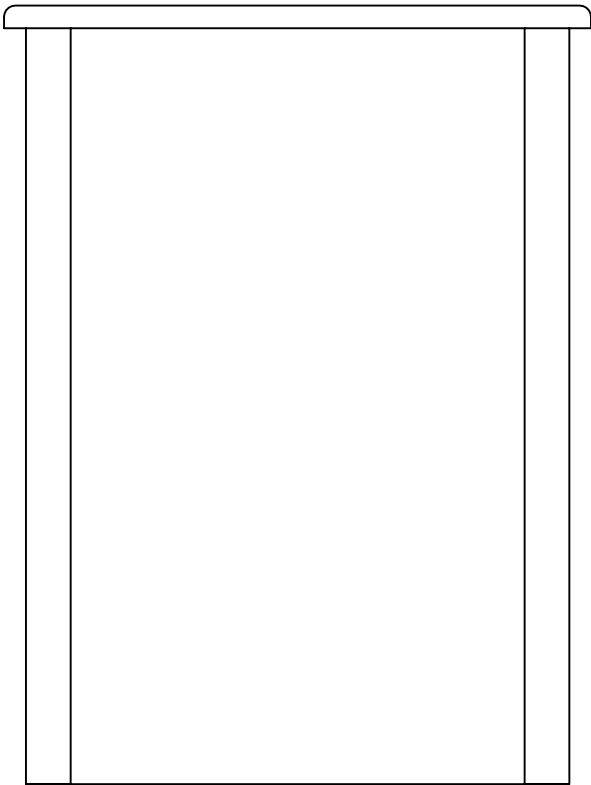
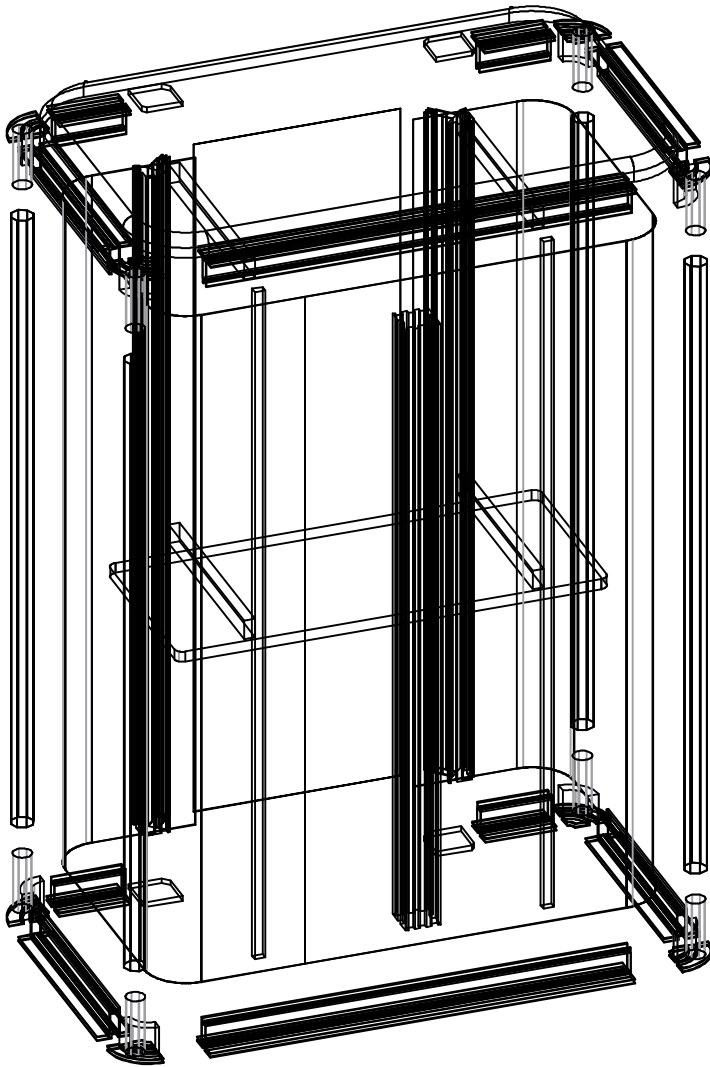
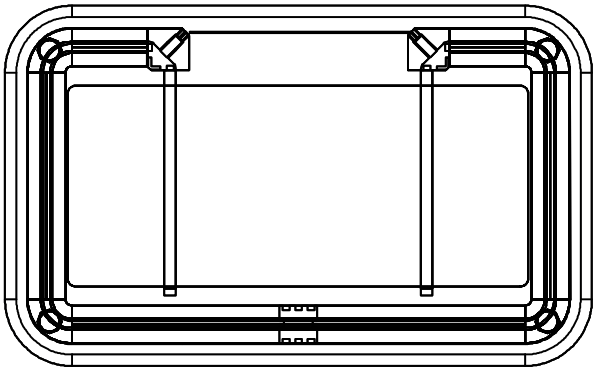

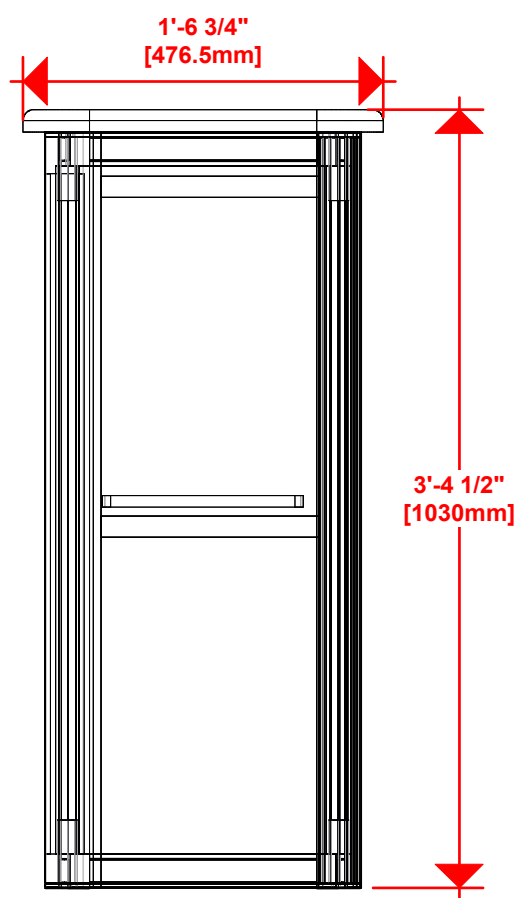
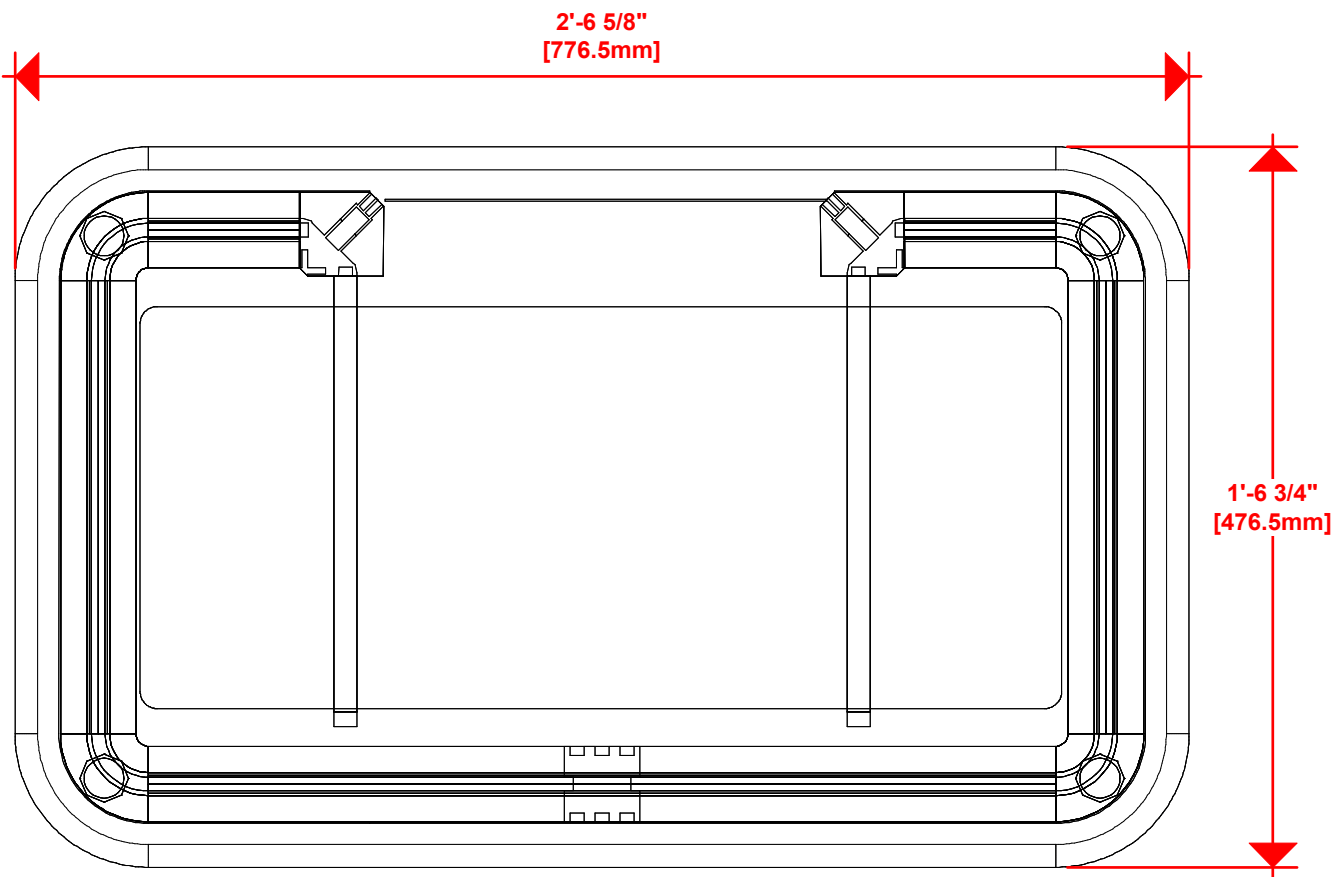



1. Redesign of this exhibit without approval by manufacturer may result in dangerous and unsafe structures. Manufacturer disclaims any responsibility for redesigned exhibits it does not approve in writing.

2. Parts and components such as panels and extrusions are manufactured to metric sizing. Where ever possible sizes have been noted in feet and inches as well as in metric. Below is the imperial to metric sizing table as reference. "Nominal" refers to approximate size.

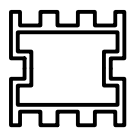
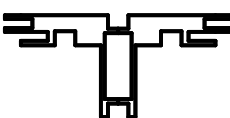
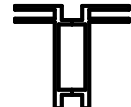
| | |
|---------------------------|---------------------------------|
| 2400mm = (94 1/2") | Phone Line / Fax |
| 2100mm = (82 5/8") | Internet connection |
| 1800mm = (70 7/8") | Outlet |
| 1500mm = (59") | Main Drop (point of distrution) |
| 1200mm = (47 1/4") | |
| 900mm = (35 1/2") | |
| 600mm = (23 5/8") | |
| 300mm = (11 7/8") | |
| Wire running under carpet | |

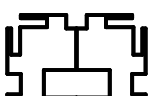
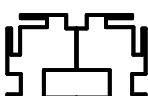
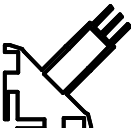
-  PM2S2
-  PHFC4
-  PHFC2
-  PH
-  PH4SC
-  PH1
-  PMFC2-T
-  PMFC2-90

HYBRID PRO RENTAL KIT

Title: SET-UP INSTRUCTIONS

| Code | # | Description |
|--------|---|--|
| R6 | 4 | 300MM (11.81") PHFC2 EXTRUSION WITH LOCKS 2 ENDS |
| R109 | 4 | 910MM LENGTH 30mm (1.18 Inch) TUBE |
| CB10-R | 8 | 50MM ROUND PHCF2 CORNER BRACKET |

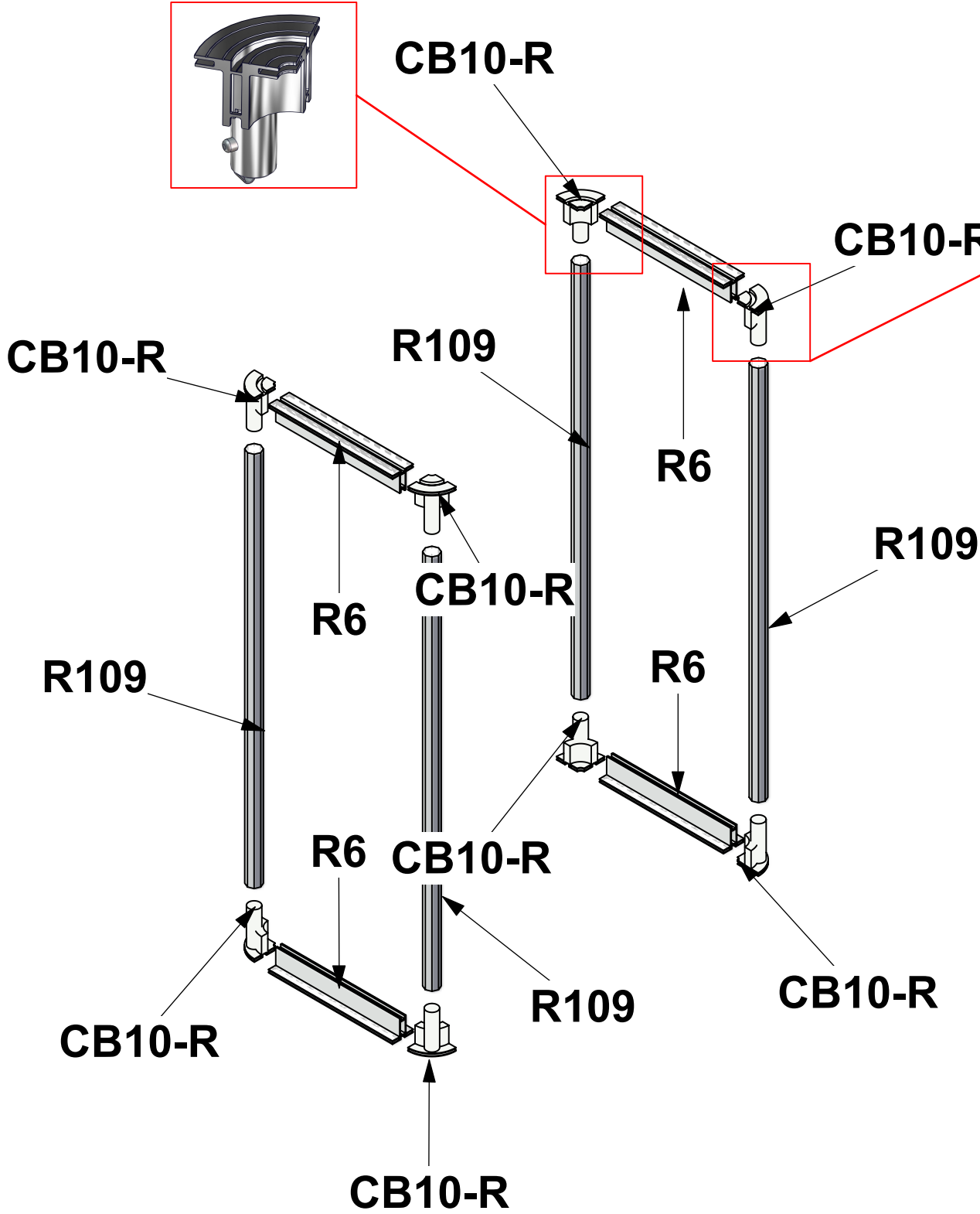

BUILD 2 UNITS

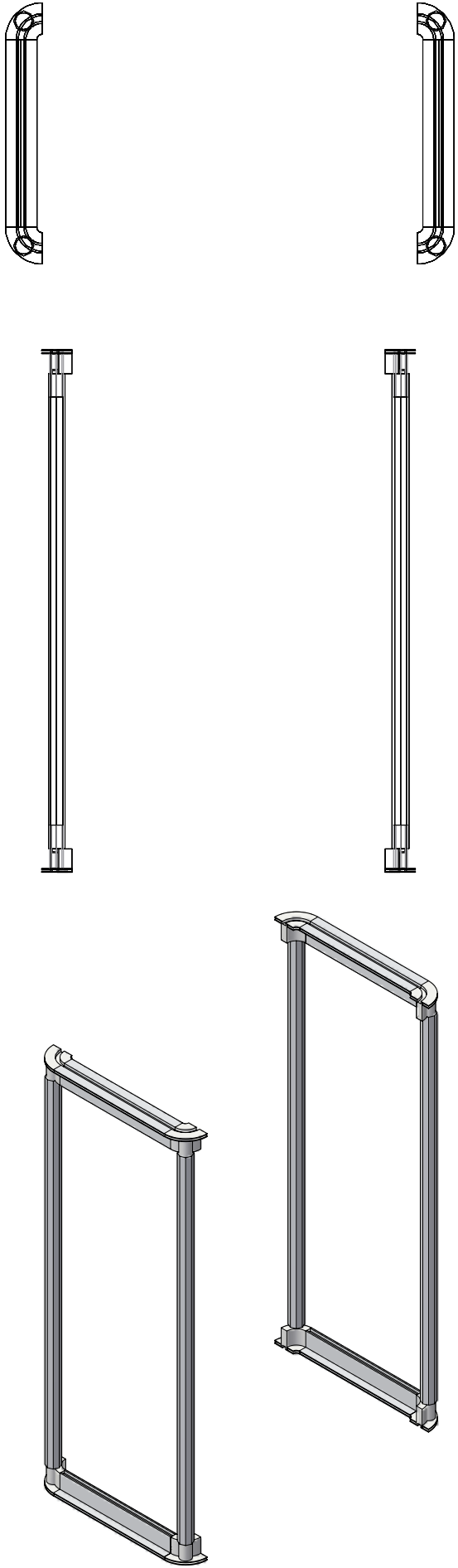
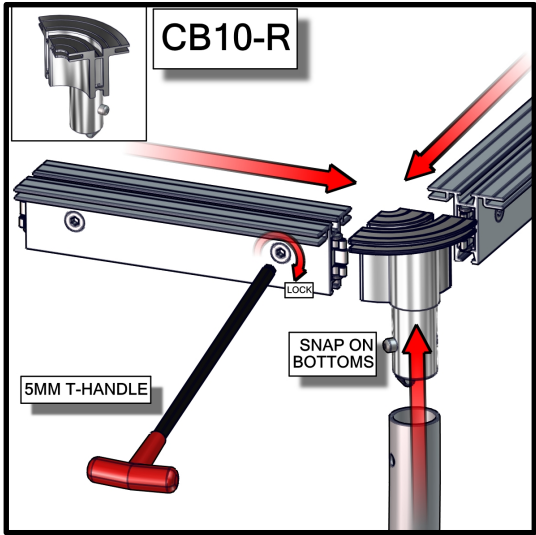

1. Redesign of this exhibit without approval by manufacturer may result in dangerous and unsafe structures. Manufacturer disclaims any responsibility for redesigned exhibits it does not approve in writing.

2. Parts and components such as panels and extrusions are manufactured to metric sizing. Where ever possible sizes have been noted in feet and inches as well as in metric. Below is the imperial to metric sizing table as reference. "Nominal" refers to approximate size.

| | |
|--------------------|---------------------------------|
| 2400mm = (94 1/2") | Phone Line / Fax |
| 2100mm = (82 5/8") | Internet connection |
| 1800mm = (70 7/8") | Outlet |
| 1500mm = (59") | Main Drop (point of distrution) |
| 1200mm = (47 1/4") | |
| 900mm = (35 1/2") | |
| 600mm = (23 5/8") | |
| 300mm = (11 7/8") | |

--- Wire running under carpet

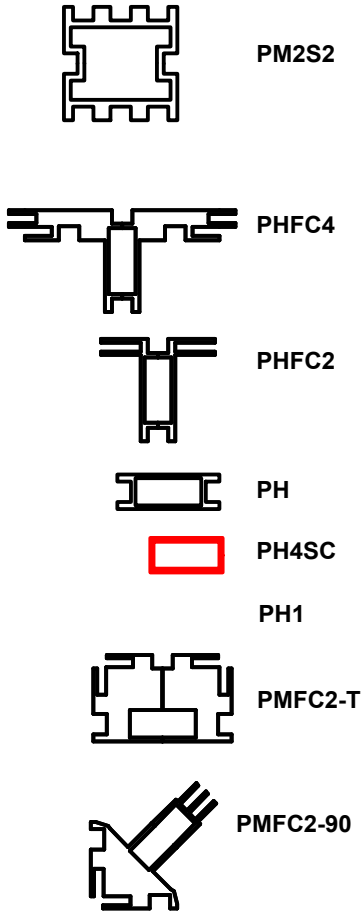

HYBRID PRO RENTAL KIT

Title: SET-UP INSTRUCTIONS

| Code | # | Description |
|-------------|---|---|
| R5 | 4 | 100MM (3.94") PHFC2 EXTRUSION WITH LOCKS 2 ENDS |
| R4 | 2 | 600MM (23.62") PHFC2 EXTRUSION WITH LOCKS 2 ENDS |
| R3 | 2 | 986MM (38.82") PMFC2-90 EXTRUSION-WITH LOCKS BOTH ENDS |
| PMFC2-90 CA | 4 | PMFC2 90 DEGREE EXTRUSION CAP |
| R1 | 1 | 910MM (35.82") 50MM PM2S SQUARE EXTRUSION WITH LOCKS 2 ENDS |

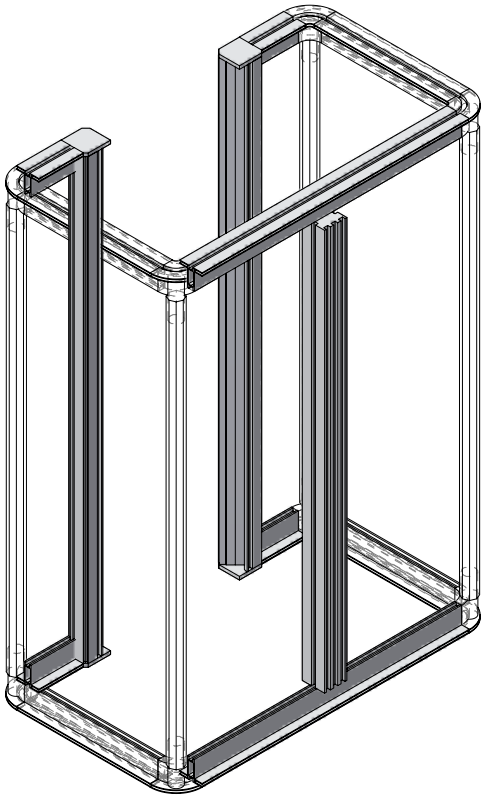
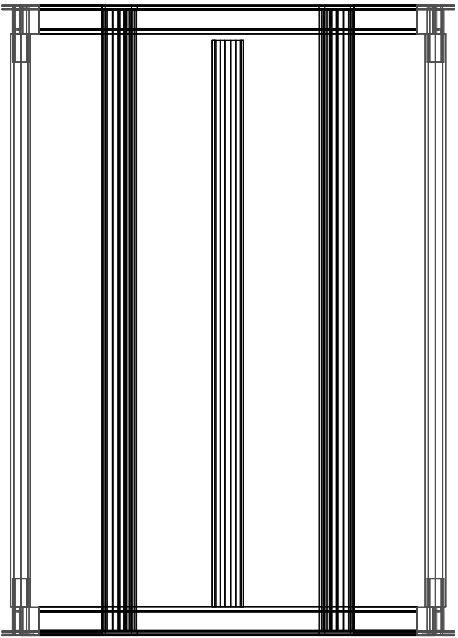
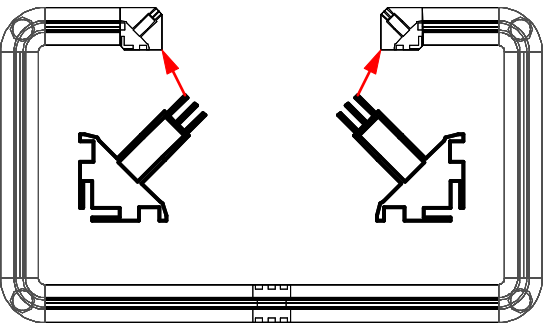
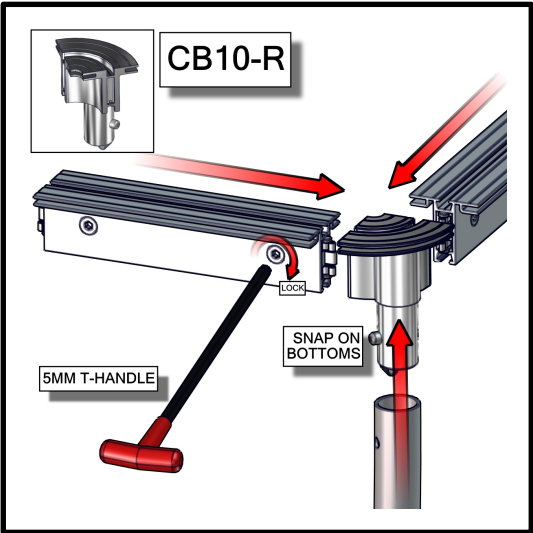
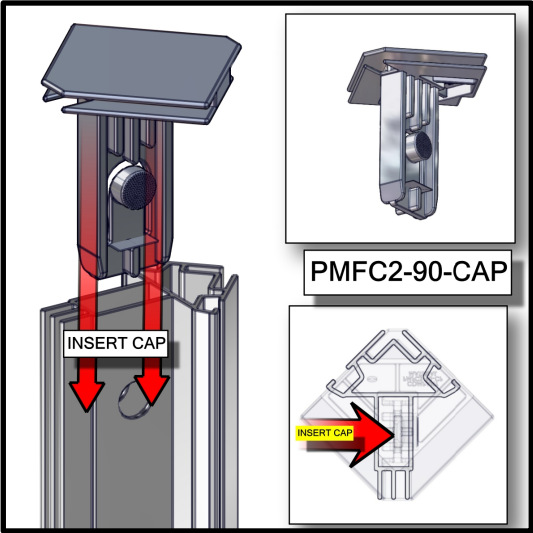
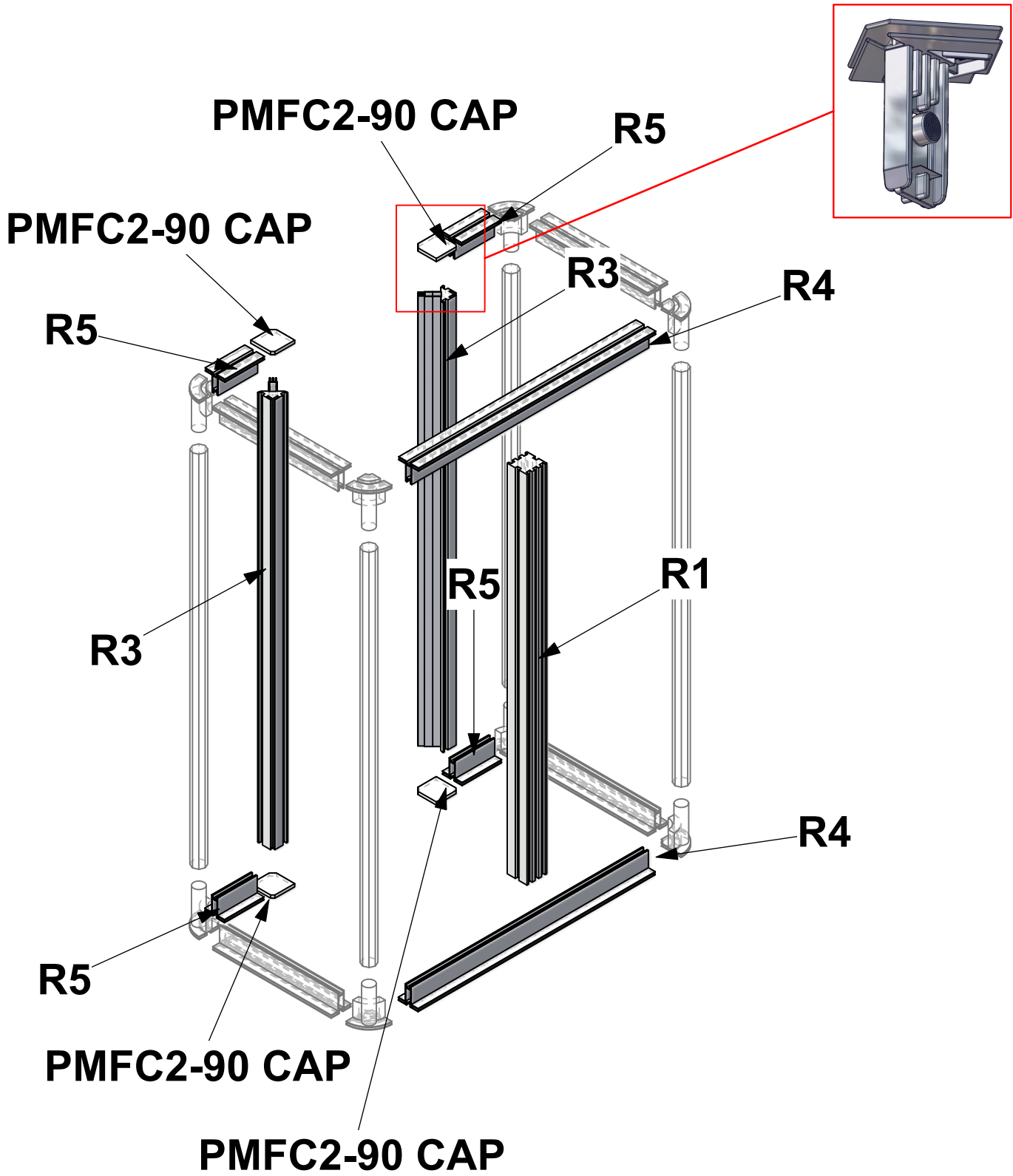

1. Redesign of this exhibit without approval by manufacturer may result in dangerous and unsafe structures. Manufacturer disclaims any responsibility for redesigned exhibits it does not approve in writing.

2. Parts and components such as panels and extrusions are manufactured to metric sizing. Where ever possible sizes have been noted in feet and inches as well as in metric. Below is the imperial to metric sizing table as reference. "Nominal" refers to approximate size.

| | |
|--------------------|---------------------------------|
| 2400mm = (94 1/2") | Phone Line / Fax |
| 2100mm = (82 5/8") | Internet connection |
| 1800mm = (70 7/8") | Outlet |
| 1500mm = (59") | Main Drop (point of distrution) |
| 1200mm = (47 1/4") | |
| 900mm = (35 1/2") | |
| 600mm = (23 5/8") | |
| 300mm = (11 7/8") | |

Wire running under carpet

PM2S2

PHFC4

PHFC2

PH

PH4SC

PH1

PMFC2-T

PMFC2-90

HYBRID PRO RENTAL KIT

Title: SET-UP INSTRUCTIONS

| Code | # | Description |
|-------------|---|--|
| R2 | 4 | 288MM (11.34") PH1 EXTRUSION WITH LOCKS 2 ENDS |
| VFC-04-CT-S | 1 | INTERNAL SHELF FOR VECTOR COUNTER VFC-04 |
| PE-1000 | 2 | 1000MM (39.37") PE EXTRUSION |

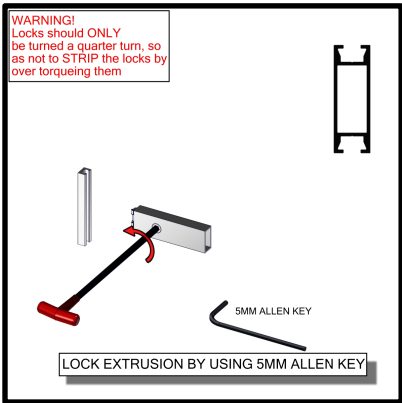
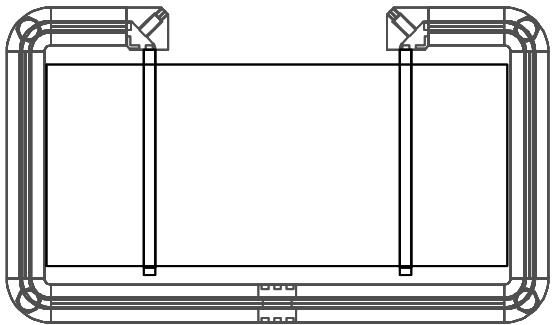
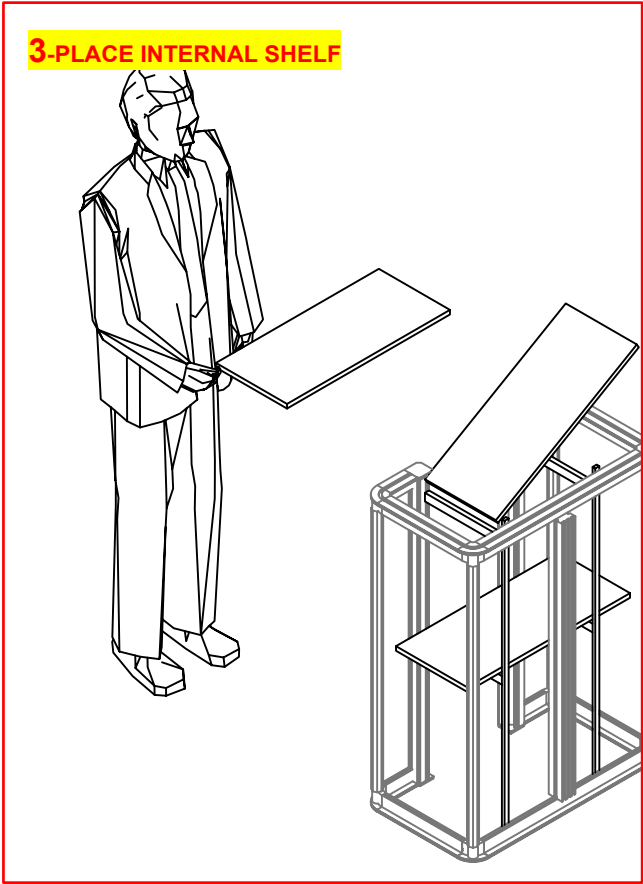
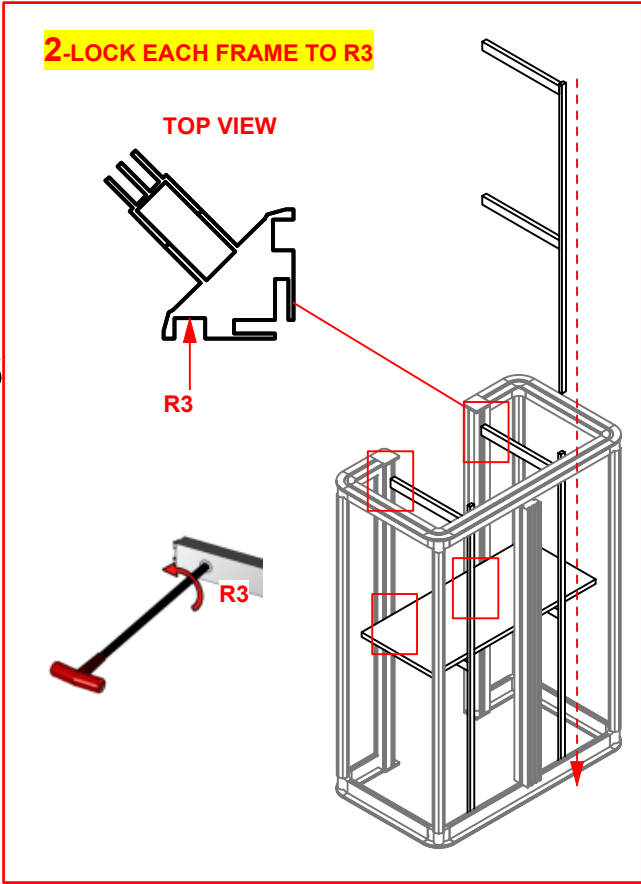
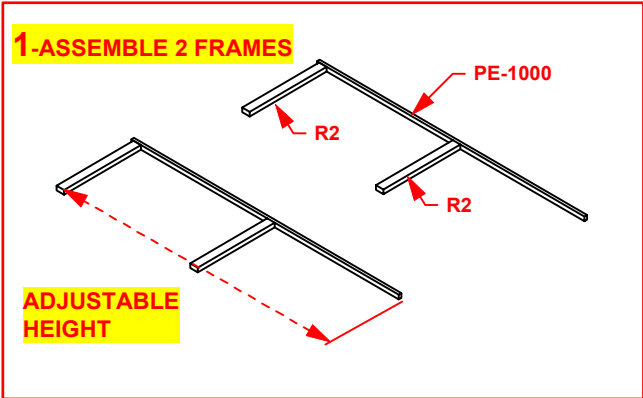
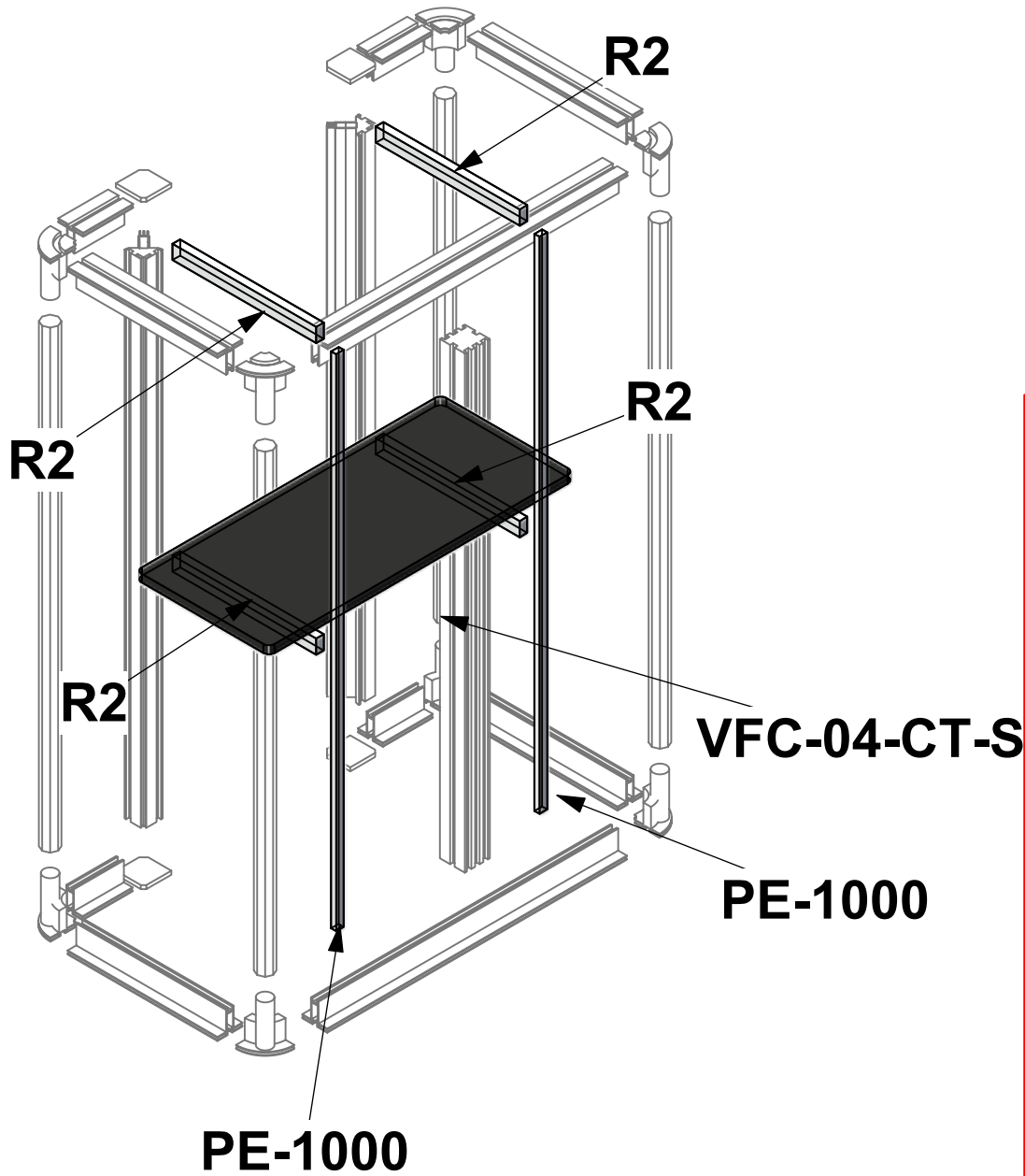

1. Redesign of this exhibit without approval by manufacturer may result in dangerous and unsafe structures. Manufacturer disclaims any responsibility for redesigned exhibits it does not approve in writing.

2. Parts and components such as panels and extrusions are manufactured to metric sizing. Where ever possible sizes have been noted in feet and inches as well as in metric. Below is the imperial to metric sizing table as reference. "Nominal" refers to approximate size.

| | |
|--------------------|---------------------------------|
| 2400mm = (94 1/2") | Phone Line / Fax |
| 2100mm = (82 5/8") | Internet connection |
| 1800mm = (70 7/8") | Outlet |
| 1500mm = (59") | Main Drop (point of distrution) |
| 1200mm = (47 1/4") | |
| 900mm = (35 1/2") | |
| 600mm = (23 5/8") | |
| 300mm = (11 7/8") | |

--- Wire running under carpet

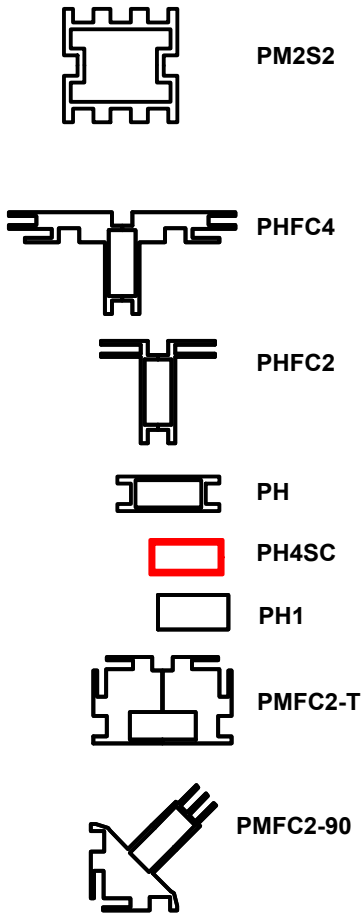

HYBRID PRO RENTAL KIT

Title: SET-UP INSTRUCTIONS

| Code | # | Description |
|-----------|---|--|
| GRAPHIC | 1 | 43 3/8" (H) X 15 1/2" (W) SINGLE SIDED DYESUB GRAPHIC W/ FCE-2 (SEG) ON PE |
| VFC-04-CT | 1 | 3' X 2' LAMINATE COUNTER TOP [BLACK THERMAFORM] |
| GRAPHIC | 1 | 43 3/8" (H) X 77 1/4" (W) SINGLE SIDED DYESUB GRAPHIC W/ FCE-2 (SEG) ON PE |

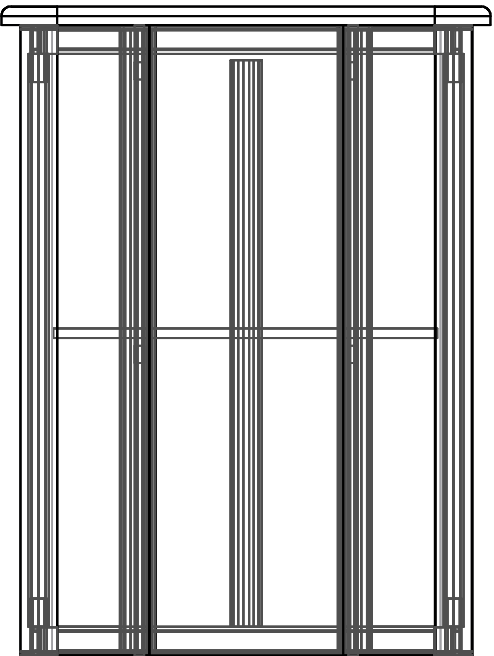
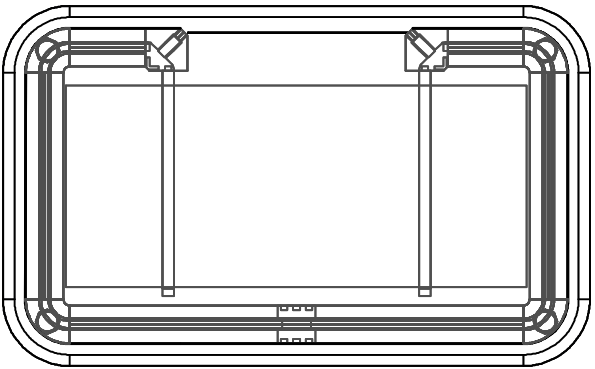
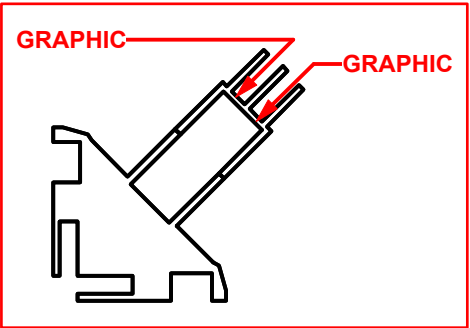
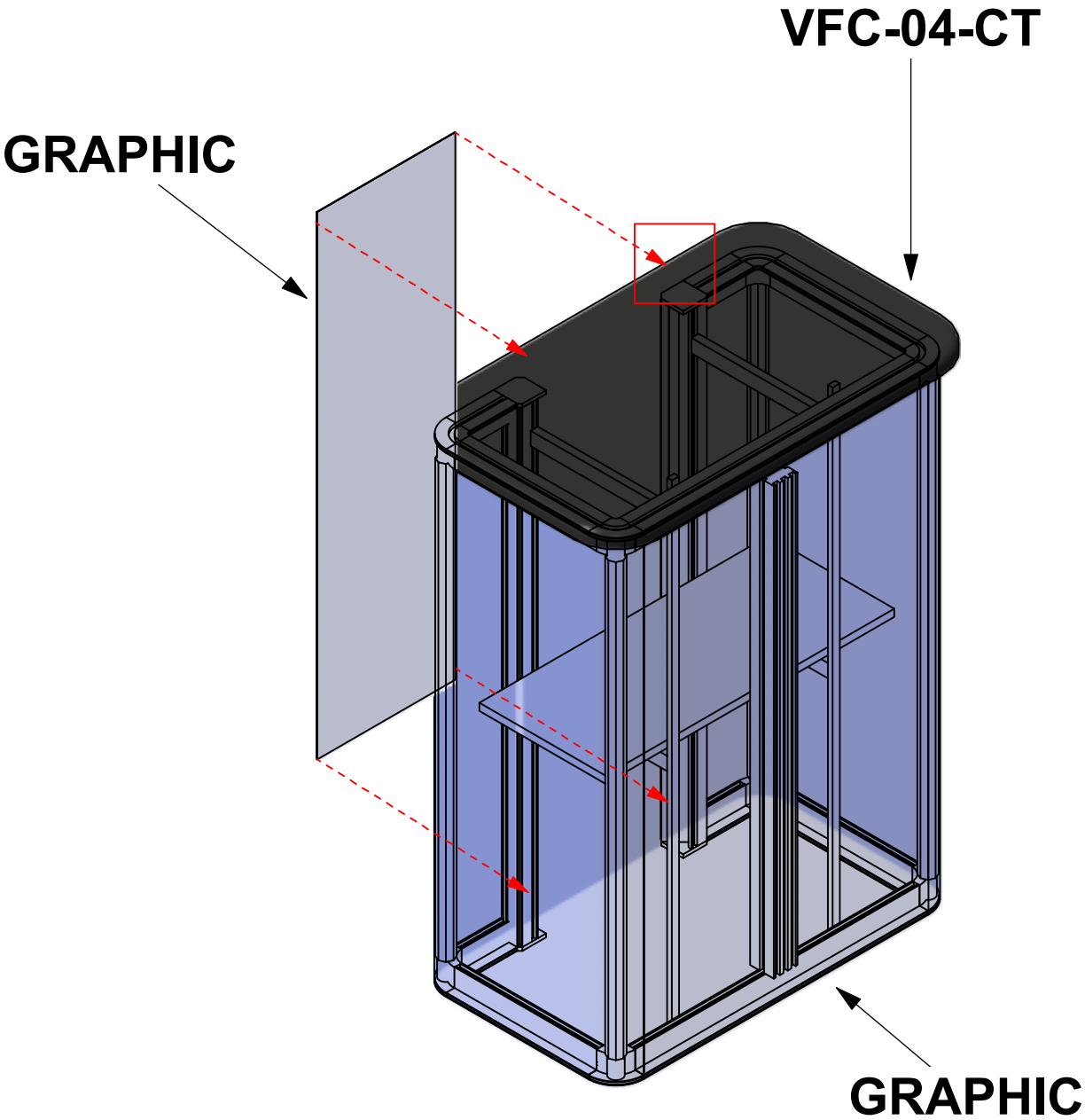

FABRIC GRAPHIC WITH FCE-2

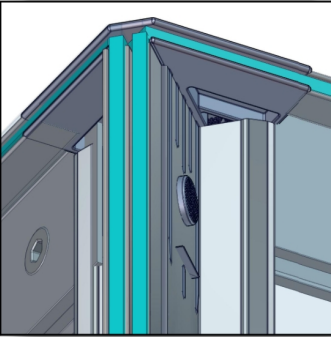
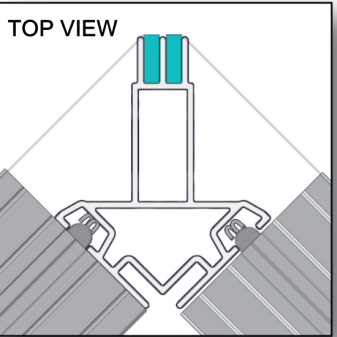
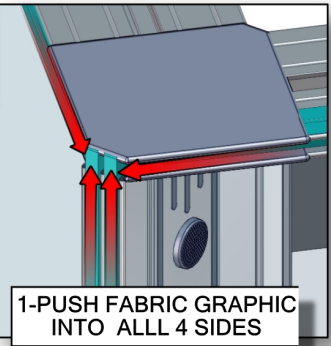
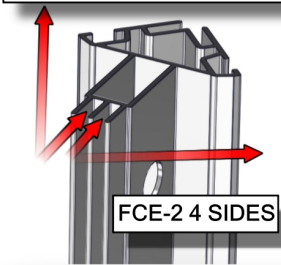

1. Redesign of this exhibit without approval by manufacturer may result in dangerous and unsafe structures. Manufacturer disclaims any responsibility for redesigned exhibits it does not approve in writing.

2. Parts and components such as panels and extrusions are manufactured to metric sizing. Where ever possible sizes have been noted in feet and inches as well as in metric. Below is the imperial to metric sizing table as reference. "Nominal" refers to approximate size.

| | |
|--------------------|---------------------------------|
| 2400mm = (94 1/2") | Phone Line / Fax |
| 2100mm = (82 5/8") | Internet connection |
| 1800mm = (70 7/8") | Outlet |
| 1500mm = (59") | Main Drop (point of distrution) |
| 1200mm = (47 1/4") | |
| 900mm = (35 1/2") | |
| 600mm = (23 5/8") | |
| 300mm = (11 7/8") | |

Wire running under carpet

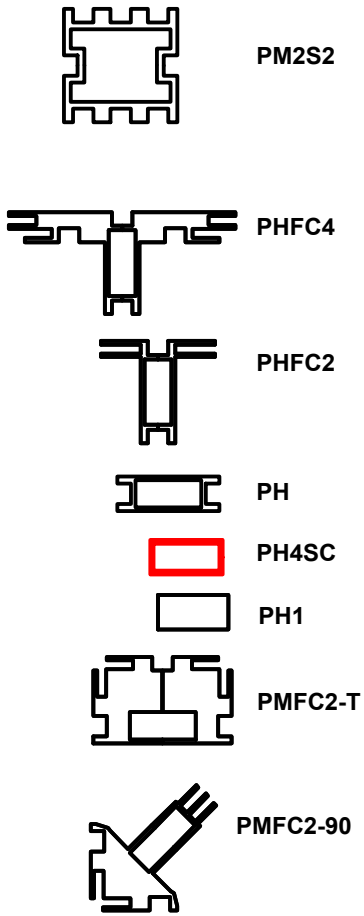

HYBRID PRO RENTAL KIT

Title: SET-UP INSTRUCTIONS

PACKING INSTRUCTIONS



(8) CB10-R, 5MM T HANDLE



(1) VFC-04-CT-S



(1) VFC-04-CT



(2) PE-1000,
(4) R2



HARDWARE ITEMS



EMPTY BOX (FILLER),
(4) R6, (4) R5, (4) R109,
(2) R4. (2) R3. (1) R1

CASE # 1

| LEGEND | | GREY FOAM FOLDED TO FILL EMPTY SPACES OR USED AS PROTECTION |
|--------|--|---|
| | | 1/8" CARDBOARD SPACER (PUT IN BETWEEN EVERY PANEL) |
| | | DIVIDER |
| | | 1/4" WHITE FOAM (USED AS PROTECTION DOOR PANELS W/ LOCKS) |
| | | |

