

# Wave 10' Straight - Kit 7

FMLT-WS10-07

Wave is a collection of sophisticated, ergonomically designed exhibit booths. Wave combines state-of-the-art zipper pillowcase dye-sublimated fabric coverings with advanced lightweight aluminum structures to provide unique design, functionality, and style. The excellence of the Wave line of displays, hanging structures and products is simply unmatched. Stretch fabric graphics are hand-sewn, durable and dry-cleanable.



We are continually improving and modifying our product range and reserve the right to vary the specifications without prior notice. All dimensions and weights quoted are approximate and we accept no responsibility for variance. E&OE. See Graphic Templates for graphic bleed specifications.

## features and benefits:

- State-of-the-art 30mm aluminum tube frame with snap button assembly
- Easy to store and ship
- Quick to set up
- Kit includes: one frame, one dye-sublimated zipper pillowcase graphic, stand-off pillow - case graphic ladder, and one wheeled molded OCL storage case
- Lifetime hardware warranty against manufacturer defects

## dimensions:

Hardware	Graphic
Assembled unit: 116.6929"w x 93.1619"h x 27.9170"d	Total visual area: 114"w x 91.5"h
Stand-off pillowcase ladder: 23.6"w x 92.7"h x 17.7"d	Pillowcase graphic ladder: 23.6"w x 97"h
Approximate weight (includes graphics): 45 lbs / 20.36 kgs	Please be sure to include a 2" bleed around the perimeter.
Shipping	Refer to related graphic template for more information.
Shipping dimensions - ships in one case: 1 OCL case: 19"l x 19"w x 56"h	Visit: <a href="http://www.exhibitors-handbook.com/graphic-templates">www.exhibitors-handbook.com/graphic-templates</a>
Approximate shipping weight (with cases): 65 lbs / 29.5 kgs	

## additional information:

- Graphic material:  
Dye-sublimated zipper pillowcase fabric
- Optional accessories:  
Lumina 8-50 watt halogen lighting, literature pocket, graphic header, larger freight cases



[www.display-setup-animations.com](http://www.display-setup-animations.com)

Parts Included – Backwall

Part Label	Qty	Part Code
5MM STEEL BASE STYLE 2 FOR LINEAR	x2	LN114-S2
90 DEGREE ELBOW JOINT FOR 30MM TUBING	x2	TC-30-90
1114MM X 30MM TUBE	x4	WS10-T1
1270MM X 30MM TUBE	x6	WS10-T2
(2) 128MM TUBES SWAGED WITH PART TC-30-T	x1	WS10-T4
(2) 128MM TUBES SWAGED WITH PART TC-30-X	x1	WS10-T5
1114MM X 30MM TUBE WITH TC-30-T AND TC-30-90B	x2	WS10-T6
(2) 128MM TUBES SWAGED WITH PART TC-30-T	x1	WS10-T7

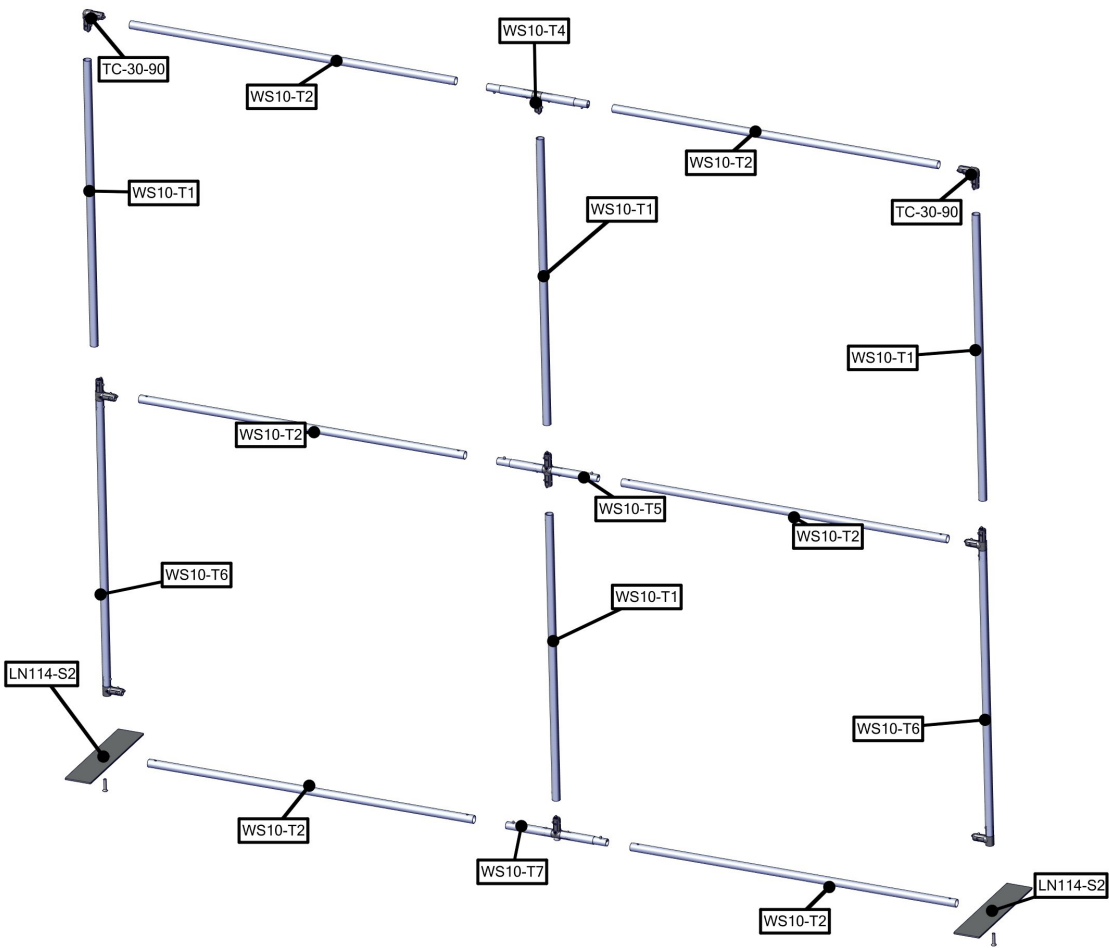
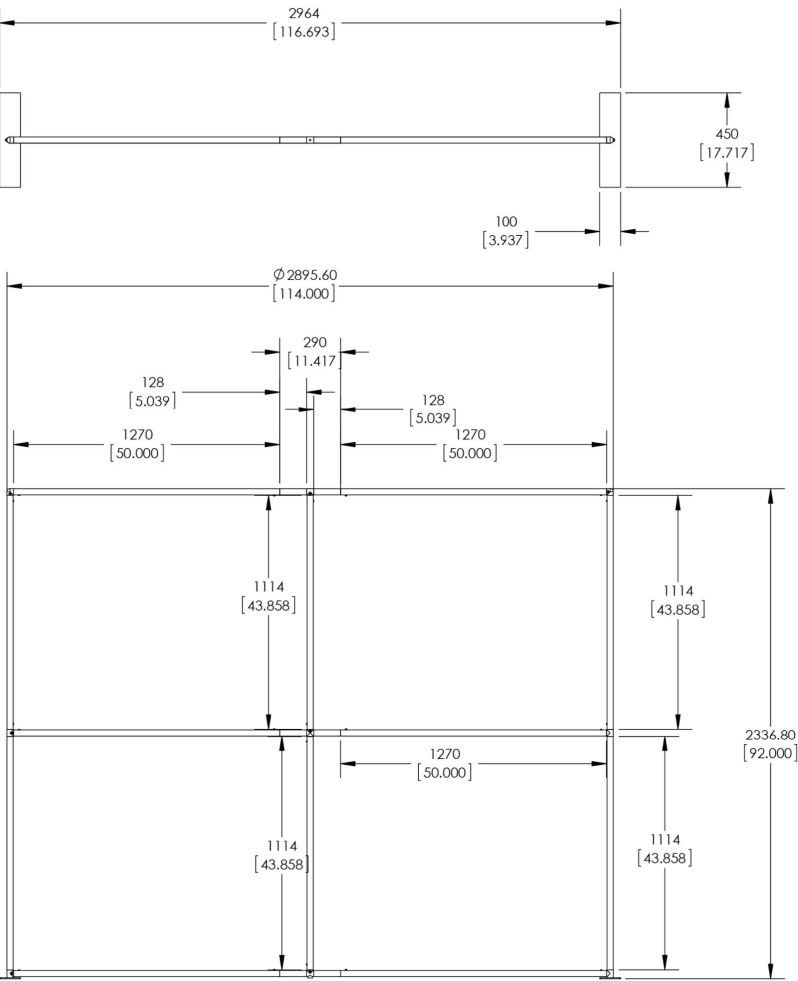

Parts Included – Ladder

Part Label	Qty	Part Code
FABRIC PILLOWCASE GRAPHIC	x1	WL01-G
PARALLEL TUBE CLAMP FOR 30MM TUBES	x2	TCP3030
535MM X 30MM TUBE WITH PART TC-30-T BOTH ENDS	x1	WL01-T1
535MM X 30MM TUBE WITH (2) TC-30-90T	x2	WL01-T2
R2000MM X 30MM TUBE (97MM ARC)	x4	WL01-T3

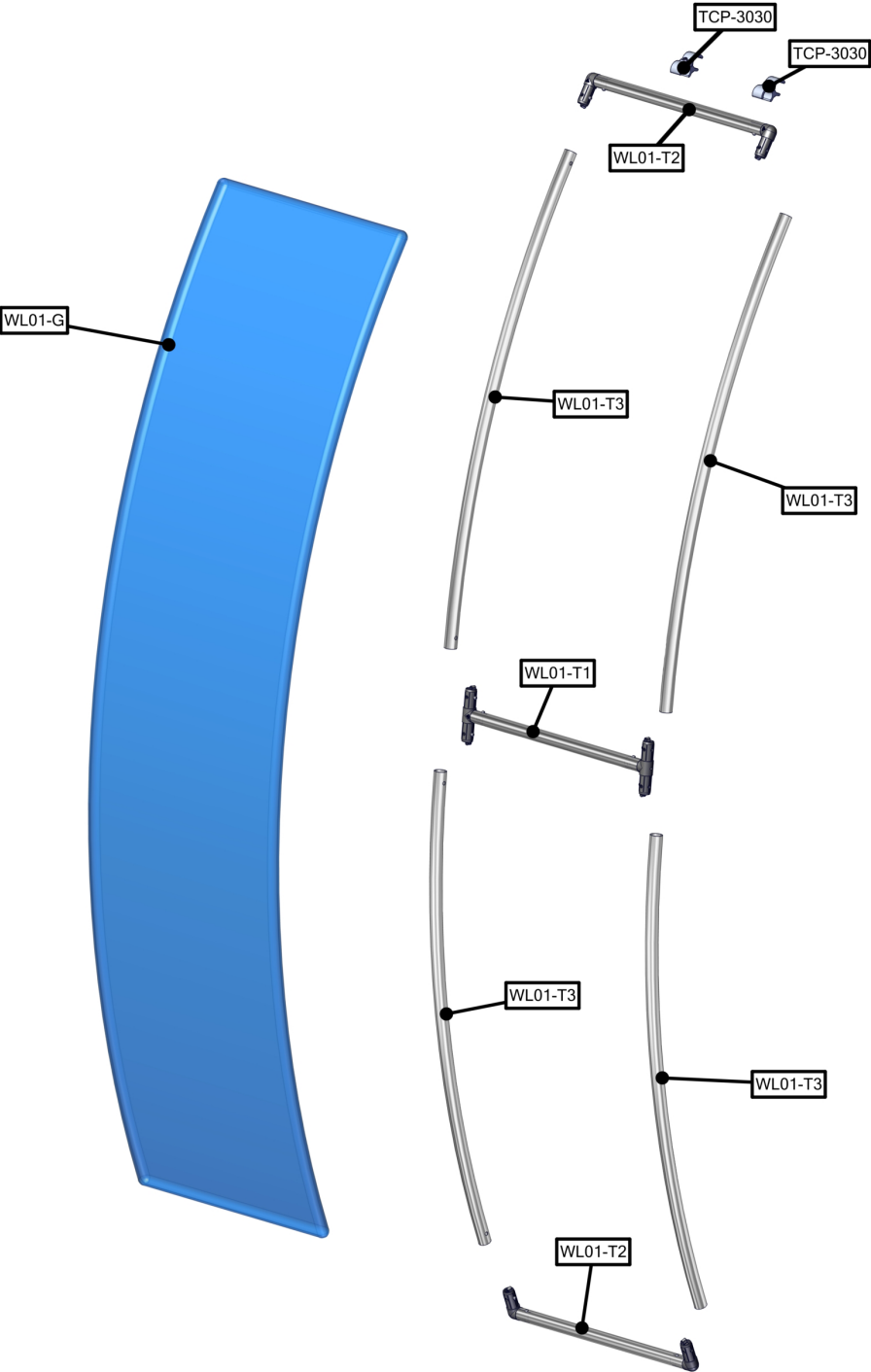

## STEP 1: ASSEMBLE FRAME

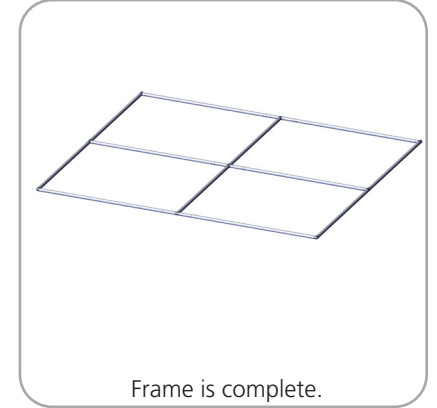
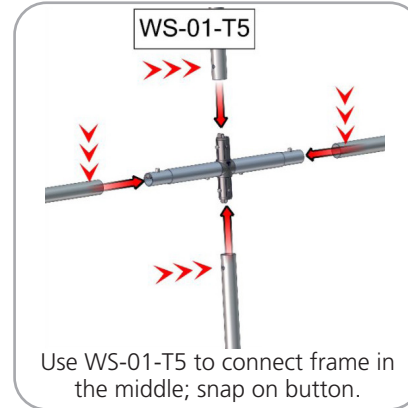
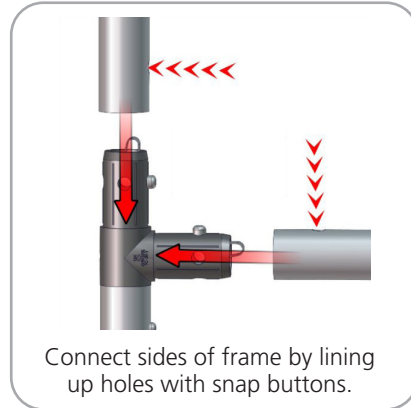
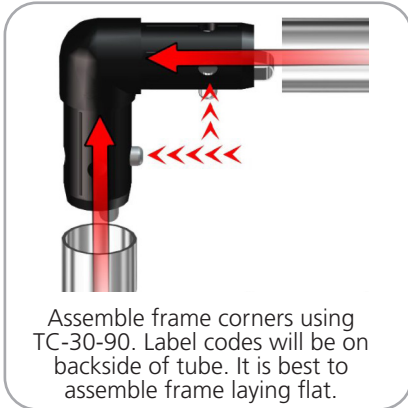

## STEP 2: ATTACH FEET

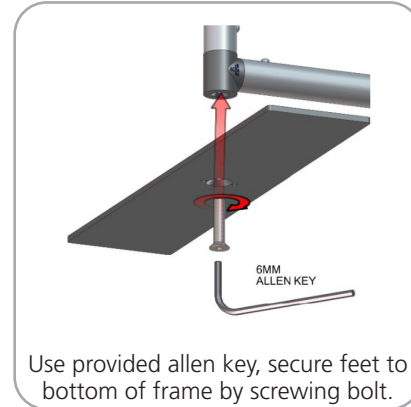
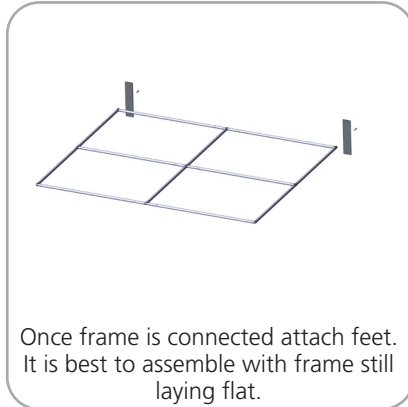

## STEP 3: ATTACH GRAPHIC

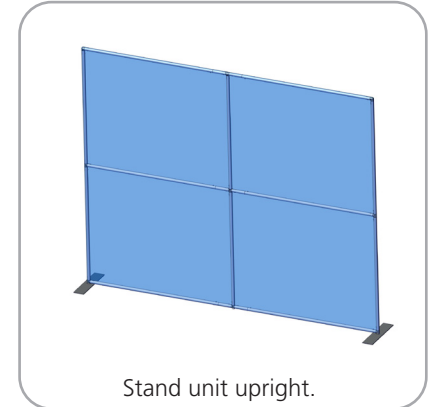
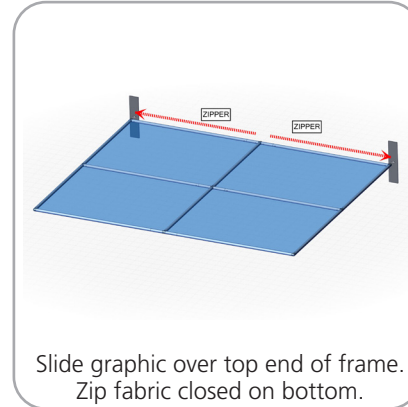

## STEP 4: ASSEMBLE LADDER FRAME

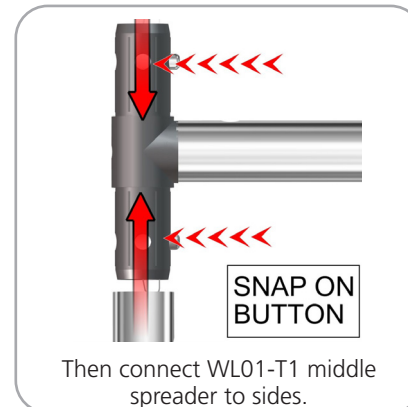
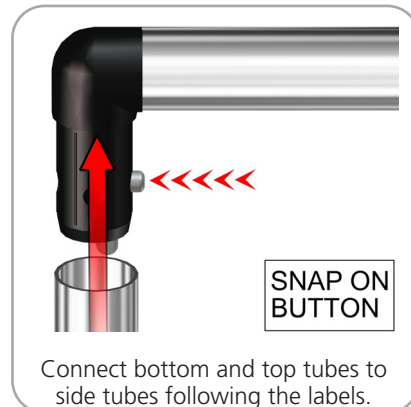
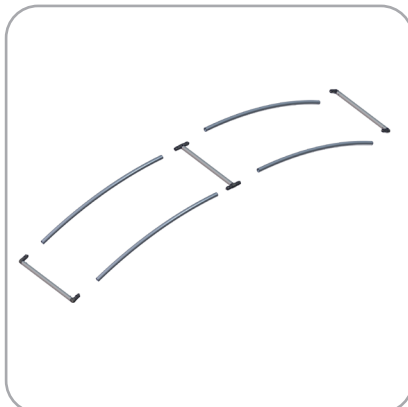

## STEP 5: ATTACH GRAPHICS

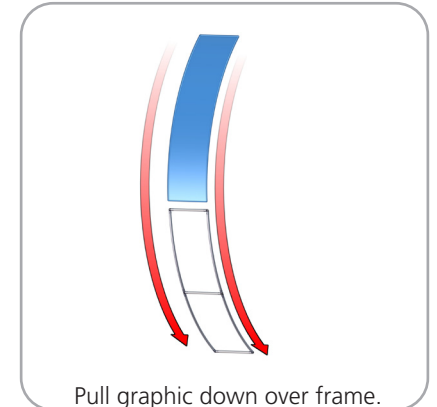

## STEP 6: ATTACH TO BACKWALL WITH CLAMPS



Zip graphic on bottom.

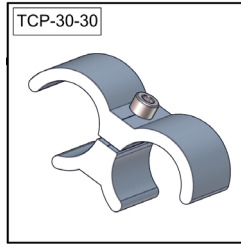

Position accent in front of backwall  
in desired location.

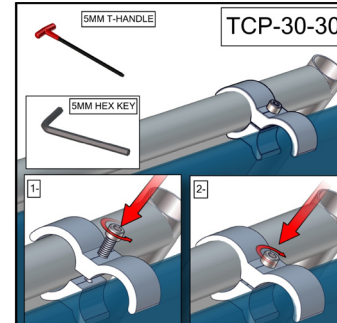

Attach to backwall with (2)  
TCP3030 back to back tube clamps.

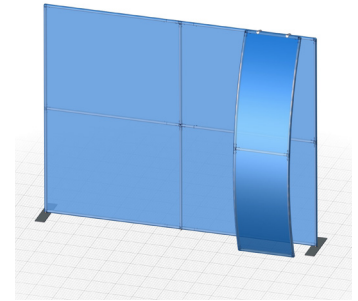

Unit is complete.