

# Wave 20' Serpentine - Kit 1

## FMLT-WSC20-01

Wave is a collection of sophisticated, ergonomically designed exhibit booths. Wave combines state-of-the-art zipper pillowcase dye-sublimated fabric coverings with advanced lightweight aluminum structures to provide unique design, functionality and style. The excellence of the Wave line of displays, hanging structures and products is simply unmatched. Stretch fabric graphics are hand-sewn, durable and dry-cleanable.



## features and benefits:

- State-of-the-art 50mm aluminum tubing with heavy duty internal spigot connectors
- Easy to store and ship
- Quick to set up
- Kit includes: one frame, one dye-sublimated zipper pillowcase graphic, and two wheeled molded storage cases
- Lifetime hardware warranty against manufacturer defects

## dimensions:

### Hardware

Assembled unit:  
227"w x 92"h x 36"d  
5766mm(w) x 2337mm(h) x 915mm(d)

Approximate weight:  
62 lbs / 29 kgs

### Graphic

Refer to related graphic template for more information.

Visit:  
[www.exhibitors-handbook.com/graphic-templates](http://www.exhibitors-handbook.com/graphic-templates)

### Shipping

Packing case(s):  
2 OCL

Shipping dimensions:  
56"l x 19"h x 19"d  
1422mm(l) x 483(h) x 483mm(d)

Approximate shipping weight:  
104 lbs / 47 kgs

## additional information:

Graphic material:  
Dye-sublimated zipper pillowcase fabric

Optional accessories:  
Lumina 8-50 watt halogen lighting,  
literature pocket, stand-off literature rack,  
stand-off graphic shelf, graphic header,  
larger freight cases

When included in a larger kit, a different packaging solution will be listed to accommodate all contents of the kit. Individual packaging no longer provided.

2 person assembly recommended:



We are continually improving and modifying our product range and reserve the right to vary the specifications without prior notice. All dimensions and weights quoted are approximate and we accept no responsibility for variance. E&OE. See Graphic Templates for graphic bleed specifications.

# Included In Your Kit

Tools, Components, Connectors & Tubes



5MM ALLEN-TOOL x1



ES50-2W x4



ES50 x10



TC-30-S x3



WSC20-T1 x4



WSC20-T2 x2



WSC20-T3 x4



WSC20-T3-HL x2



WSC20-T3-HR x2



WSC20-T4 x6

Graphics

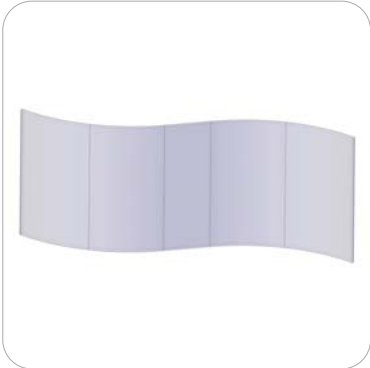

FMLT-WSC20-01-G x1

# Exploded View

FMLT-WSC20-01

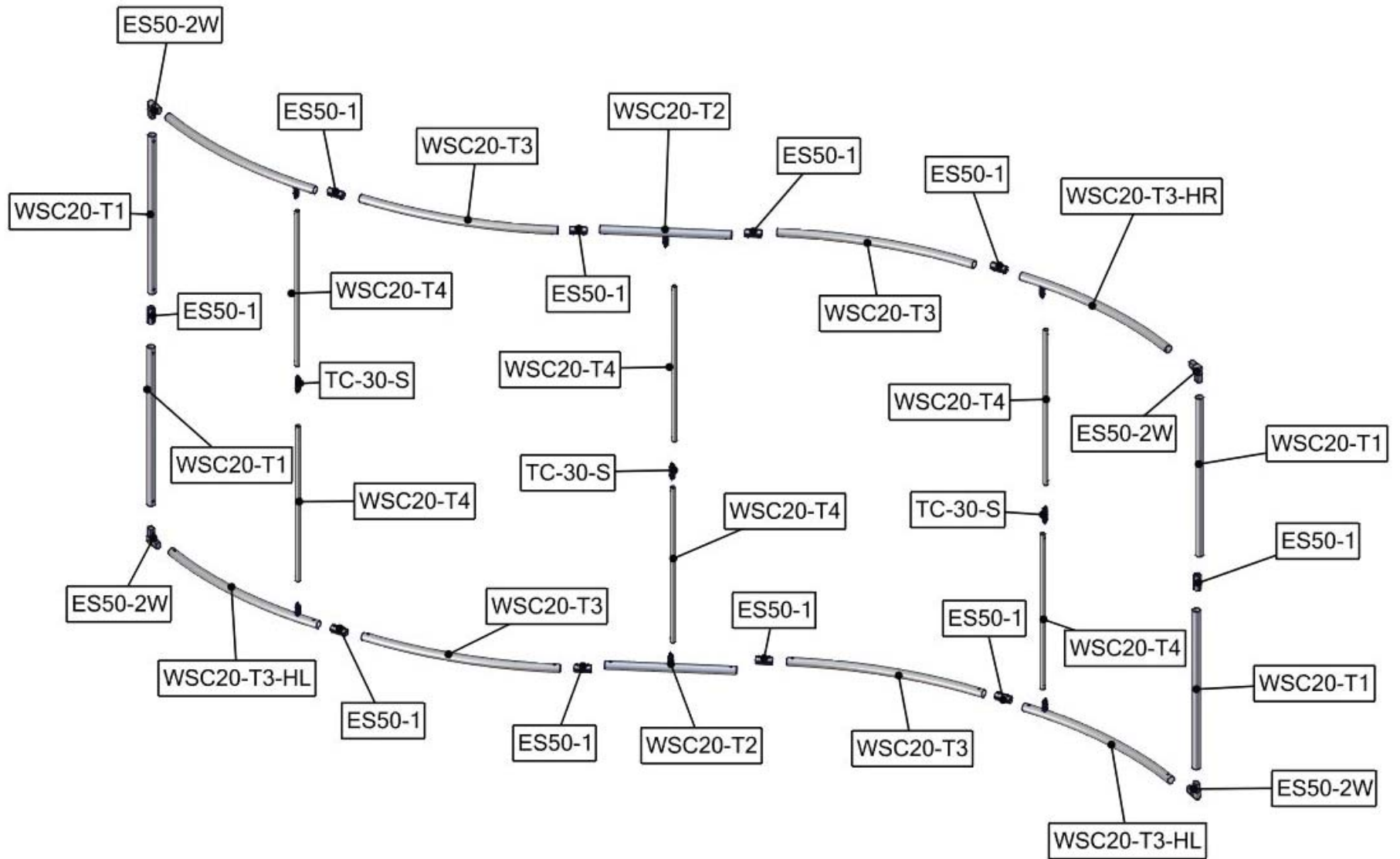

# Labeling Diagram

FMLT-WSC20-01

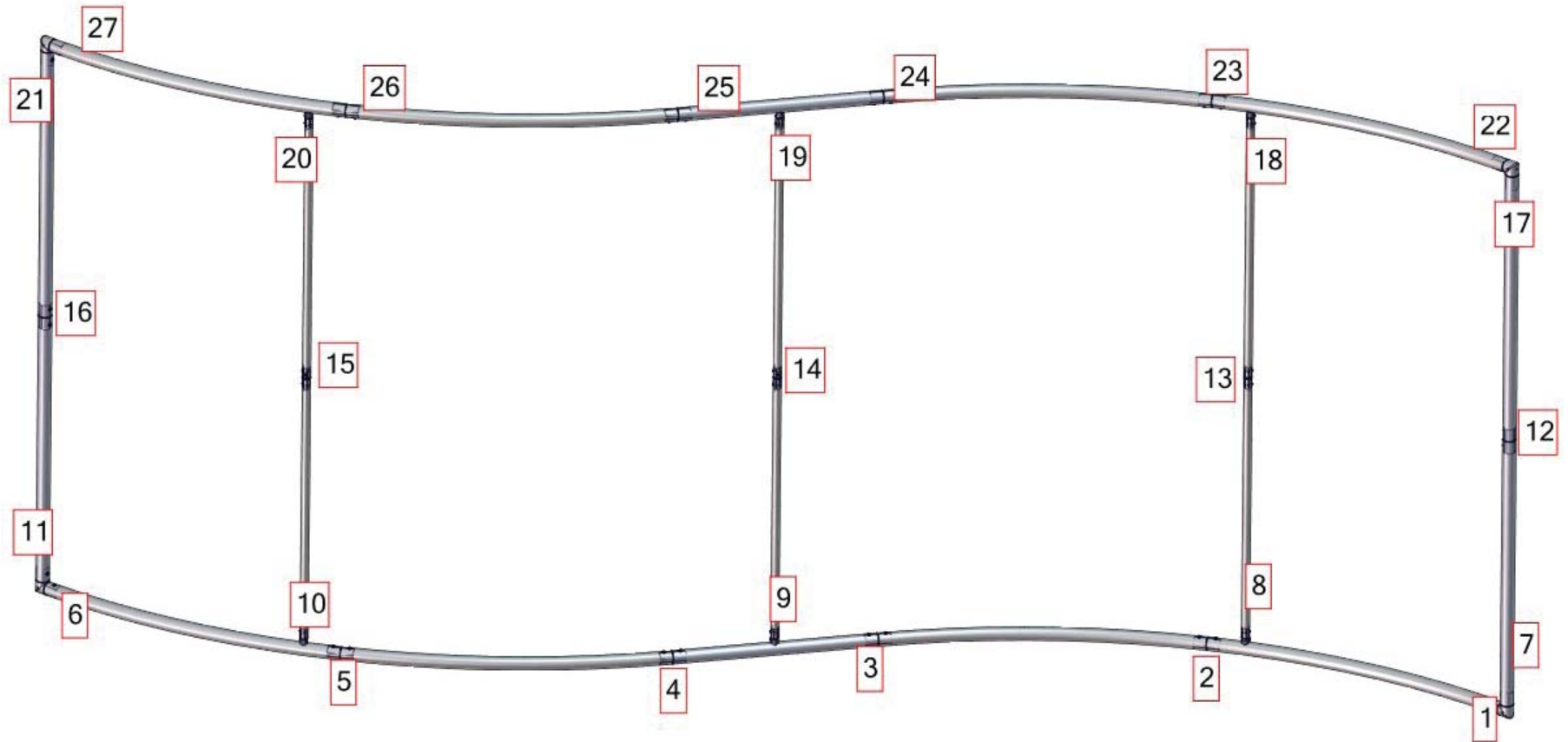

# Connection Methods

## Connection Method 1: ES30 / ES50 / SNAP BUTTONS

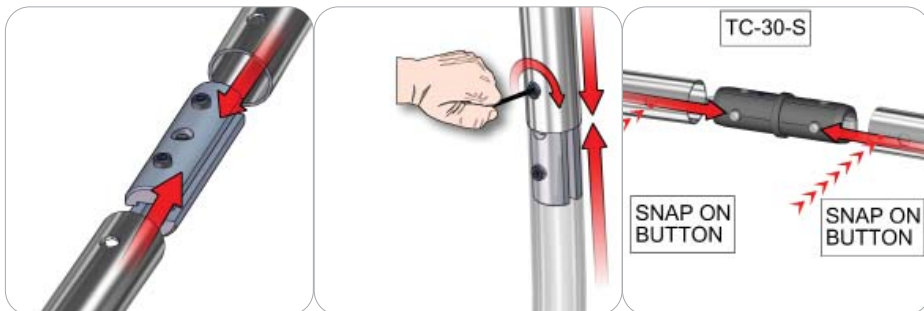

For spigot connections, compress the unlocked connector and slide into the tube lock access hole. Lock both screws carefully using your allen key tool. Be sure to lock securely, but do not over tighten. For snap button connections, locate the snap button on the connector or swage tube. Locate the hole on the corresponding tube. Press the snap button with your thumb and slide the tube and connector together so that the snap button snaps fully into the lock hole. To disassemble, press the snap button and pull apart.

## Connection Method 2: ES50-2W

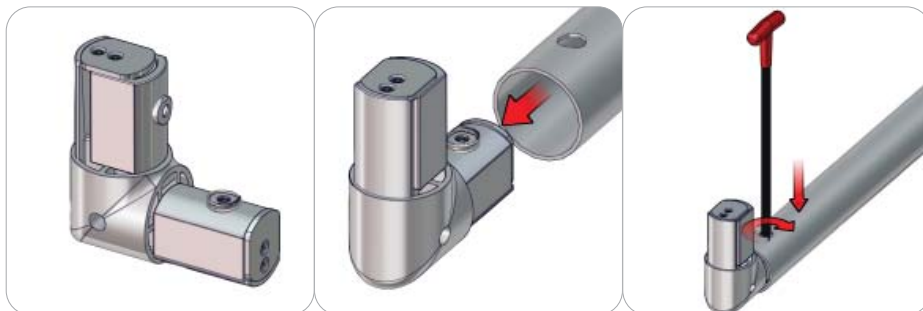

First, check if the connector ends compress. If they do not compress, use the allen key tool for turning the internal screw counter clockwise. Second, compress the connector end and slide it into the tube. Align the connector end button with the tube hole until it pops out. Third, use the allen key tool for turning the internal screw clockwise for a secure fit. Be sure to lock securely, but do not overtighten.

# Kit Assembly

## Step by Step

### Step 1.

Gather the components laid out on the floor to build the frame. Use the Exploded View and the Labeling Diagram for part labels.

Reference Connection Method(s) 1 and 2 for more details.

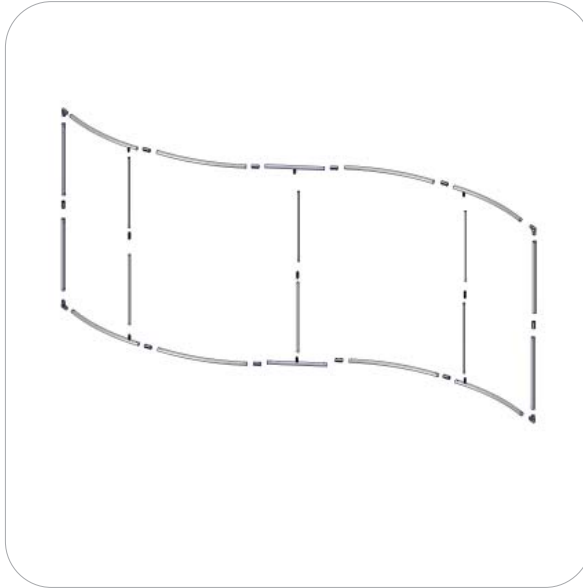
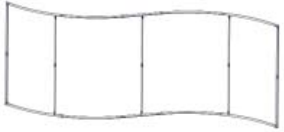

### Step 2.

With the frame laid out on the floor, apply the graphic pillowcases over the frame from the top and then zipper around the bottom edge. Stand the unit upright.

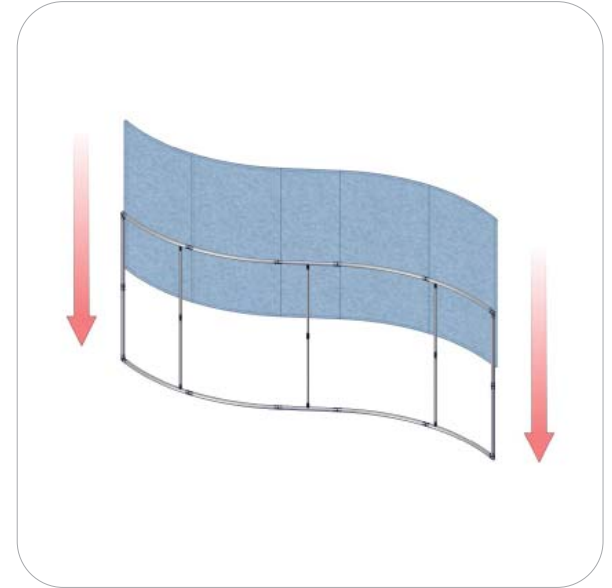

### Step 3.

Setup is complete.

